

LAND CORNER RECORDATION CERTIFICATE
Filing Requirement of Act 74, Mich. P.A. 1970

William Lenca
Chairman

For corners in

MENOMINEE (County)	Located In:	Corner Code #
1. Public Land Survey	T <u>7N</u> R <u>25W</u>	<u>G-10</u>
	T <u> </u> R <u> </u>	<u> </u>
	T <u> </u> R <u> </u>	<u> </u>
	T <u> </u> R <u> </u>	<u> </u>
2. Property Controlling in Section	S <u> </u> T <u> </u> R <u> </u>	<u> </u>
	S <u> </u> T <u> </u> R <u> </u>	<u> </u>
3. Miscellaneous Property in Sec.	S <u> </u> T <u> </u> R <u> </u>	<u> </u>
	S <u> </u> T <u> </u> R <u> </u>	<u> </u>

RECEIVED FOR RECORD
97 JUL 23 PM 3:35
PAGE # 498 BK 5
BARBARA MORRISON
REGISTER OF DEEDS
MEMPHIS, TN 38158

Register of Deeds Stamp & File Number

4. Lot No. _____, Recorded Plat _____
5. Private Claims _____

I, William Lenca, in a field survey on Mar. 17, 1997 do hereby state that under requirements of P.A. 74, Michigan P.A. of 1970, the corner points mentioned in lines 1 and 2 above were in conformance with regulations and rules therefore as required in the current manual of survey instructions of the United States Department of the Interior, Bureau of Land Management or by a decree of a Court of Law and /or that the corner points mentioned in lines 3, 4 and 5 above were in conformance with the rules of the Michigan Board of Land Surveyors or by a Decree of a Court of Law; established, re-established, monumented, recovered, found as expressed below:

NOTE: Not more than 2 corners, all in the same town and range, may be recorded on this certificate.

	A	B	C	D	E	F	G	H	I	J	K	L	M
1													
2	6		5		4		3		2		1		
3													
4	7		8		9		10		11		12		
5													
6	13		17		16		15		14		13		
7													
8	19		20		21		22		23		24		
9													
10	30		29		28		27		26		25		
11													
12	31		32		33		34		35		36		
13													

A. Description of original monument and accessories and/or subsequent restoration:

1852: Original Survey by George Adair - B.T.'s - Cedar, 18" - N45°E - 08 lks.; Hemlock, 6" - S62°W - 25 lks. All original evidence for this corner has been destroyed by county road improvements.

B. Description of corner evidence found and/or method applied in restoring or reestablishing corner:

We recovered a 5/8 inch diameter iron rod in the centerline of a North - South County Road and in line with an old fence running West from this location. This corner position falls within 1.6 feet of splitting the distance between the NW Corner (G-9) and the Southwest Corner (G-11) of Section 27, and is accepted as the best available evidence of the position of the original corner.

C. Description of monument for corner and accessories established to perpetuate locating the position of the corner:
Sct 5/8" x 24" Iron Rod/3-1/4" dia. Alum. cap stamped for corner location:

10" dia. Maple	N50°E	39.07 feet	Scr. NBT
6" dia. Balsam	S34°E	44.07 feet	Scr. NBT
18" dia. Maple	N85°W	30.60 feet	Scr. NBT
16" dia. Twin Maple	N20°W	72.21 feet	Scr. NBT
Metal Survey Sign Post	West	20.5 feet	

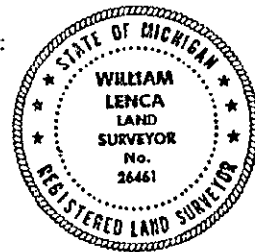

NOTE: All bearings are magnetic bearings. All distances are measured with steel tape. Distances to trees are to nail in side of tree.

Signed by William Lenca
Surveyor's Michigan License No. 26461

Date Mar. 25, 1997

REMONUMENTATION

DEC 2 1997

COMMISSION

498