

LAND CORNER RECORDATION CERTIFICATE  
 Filing Requirement of Act 74, Mich. P.A. 1970

For corners in

MENOMINEE (County)	Located in:	Corner Code #
1. Public Land Survey	<u>T37N R 25W</u>	<u>H09</u>
	T <u>    </u> R <u>    </u>	<u>    </u>
	T <u>    </u> R <u>    </u>	<u>    </u>
	T <u>    </u> R <u>    </u>	<u>    </u>
2. Property Controlling in Section	S <u>    </u> T <u>    </u> R <u>    </u>	<u>    </u>
	S <u>    </u> T <u>    </u> R <u>    </u>	<u>    </u>
3. Miscellaneous Property in Sec.	S <u>    </u> T <u>    </u> R <u>    </u>	<u>    </u>
	S <u>    </u> T <u>    </u> R <u>    </u>	<u>    </u>

96 DEC 30 10 06  
 REGISTERED DEEDS  
 REGISTER OF DEEDS STAMP & FILE NUMBER

4. Lot No. \_\_\_\_\_, Recorded Plat \_\_\_\_\_  
 5. Private Claims \_\_\_\_\_

I, William Lenca, in a field survey on Sep. 09, 19 96 do hereby state that under requirements of P.A. 74, Michigan P.A. of 1970, the corner points mentioned in lines 1 and 2 above were in conformance with regulations and rules therefore as required in the current manual of survey instructions of the United States Department of the Interior, Bureau of Land Management or by a decree of a Court of Law and/or that the corner points mentioned in lines 3, 4 and 5 above were in conformance with the rules of the Michigan Board of Land Surveyors or by a Decree of a Court of Law; established, re-established, monumented, recovered, found as expressed below:

NOTE: Not more than 2 corners, all in the same town and range, may be recorded on this certificate.

A	B	C	D	E	F	G	H	I	J	K	L	M
1												
2	6	5	4	3	2	1						
3												
4	7	8	9	10	11	12						
5												
6	18	17	16	15	14	13						
7												
8	19	20	21	22	23	24						
9												
10	30	29	28	27	26	25						
11												
12	31	32	33	34	35	36						
13												

A. Description of original monument and accessories and/or subsequent restoration:  
 1852: Original Survey by George Adair - B.T.'s - Cedar, 24" - N85°E - 130 lks.; Cedar, 18" - S74°W - 43 lks. All original evidence for this corner has been destroyed by county road improvements.

B. Description of corner evidence found and/or method applied in restoring or reestablishing corner:

We re-set this corner at a single proportional location between the Northwest Corner (G-9) and the Northeast Corner (I-9) of Section 27, T37N-R25W. The corner position thus established falls in line with the centerline of an East - West County Road and fits with the GLO call to the Cedar River (River is 0.24 chains West), and is accepted as a careful and faithful reestablishment of the position of the original corner. (distances to corners 1/2 mile East & 1/2 mile West: GLO = 2622.8' - MEAS. = 2613.34')

C. Description of monument for corner and accessories established to perpetuate locating the position of the corner.  
 Set 5/8" x 24" Iron Rod/3-1/4" dia. Alum. cap stamped for corner location in Monument Box:

5/8" x 24" Iron Rod/2" dia. Alum. cap marked "WITNESS MARKER"	N07°E	25.89 feet
Cross Chisled on W. end N. Bridge Abutment	N55°E	16.95 feet
Cross Chisled on W. end S. Bridge Abutment	S61°E	14.76 feet
8" dia. White Ash	S41°W	34.47 feet
Metal Survey Sign Post	N07°E	26.4 feet

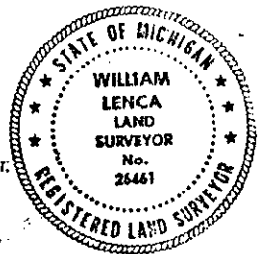

Scr. NBT

NOTE: All bearings are magnetic bearings. All distances are measured with steel tape. Distances to trees are to nail in side of tree.

Signed by William Lenca  
 Surveyor's Michigan License No. 26461

Date Dec. 23, 1996

435