

LAND CORNER RECORDATION CERTIFICATE
 Filing Requirement of Act 74, Mich. P.A. 1970

For corners in
MENOMINEE
 (County)

Located In: Corner Code #

1. Public Land Survey T37N R. 25W E-11
 T R
 T R
 T R

2. Property Controlling
 in Section S T R
 S T R

3. Miscellaneous
 Property in Sec. S T R
 S T R

RECORDED FOR RECORD
 97 JUL 23 PM 3:35
 PAGE # 500, BK 5
 BARBARA MORRISON
 REGISTER OF DEEDS
 MENOMINEE MI 49853
 Register of Deeds Stamp & File Number

4. Lot No. _____, Recorded Plat _____
 5. Private Claims _____

A	B	C	D	E	F	G	H	I	J	K	L	M
1												
2	6	5	4	3	2	1						
3												
4	7	8	9	10	11	12						
5												
6	18	17	16	15	14	13						
7												
8	19	20	21	22	23	24						
9												
10	30	29	28	27	26	25						
11												
12	31	32	33	34	35	36						
13												

I, William Lenca, in a field survey on Mar. 17, 19 97 do hereby state that under requirements of P.A. 74, Michigan P.A. of 1970, the corner points mentioned in lines 1 and 2 above were in conformance with regulations and rules therefore as required in the current manual of survey instructions of the United States Department of the Interior, Bureau of Land Management or by a decree of a Court of Law and/or that the corner points mentioned in lines 3, 4 and 5 above were in conformance with the rules of the Michigan Board of Land Surveyors or by a Decree of a Court of Law; established, re-established, monumented, recovered, found as expressed below:

NOTE: Not more than 2 corners, all in the same town and range, may be recorded on this certificate.

A. Description of original monument and accessories and/or subsequent restoration:

- 1852: Original Survey by George Adair - B.T.'s - Hemlock, 8" - N63°E - 22 lks.; Tamarack, 16" - S49°W - 42 lks. All original evidence for this corner has been destroyed by logging activities.
- 1968: L.C.R.C. No. 553 (Volume 3) recorded by Frank Bray, DNR Surveyor, states the corner was replaced from old rotted wood post. No original evidence found. Set 1" iron pipe/4" Alum. cap - B.T.'s: 8" W. Pine - N65°W - 18 links; 7" Hemlock - N49°E - 25 links; 10" W. Pine - S28°E - 12.5 links.

B. Description of corner evidence found and/or method applied in restoring or reestablishing corner:

We found a 1inch diameter iron pipe with a standard DNR 4 inch diameter aluminum cap stamped for corner location in position matching well with other corners in the area. We also found the 3 B.T.'s described in L.C.R.C. No. 553. The 10" White Pine S28°E, 12.5 links is dead but still standing. We accepted the existing monument as the best available evidence of the position of the original corner.

C. Description of monument for corner and accessories established to perpetuate locating the position of the corner:
 Accepted existing 1" dia. Iron Pipe/4" Alum. cap stamped for corner location (DNR Monument):

10" dia. Hemlock (Existing B.T.)	N49°E	16.70 feet	Scr. NBT
8" dia. White Spruce	S52°E	34.63 feet	Scr. NBT
9" dia. Hemlock	S38°W	5.71 feet	Scr. NBT
14" dia. White Pine (Existing B.T.)	N65°W	12.22 feet	Scr. NBT
Metal Survey Sign Post	North	0.9 feet	

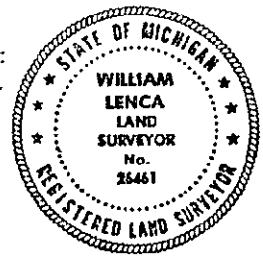

NOTE: All bearings are magnetic bearings. All distances are measured with steel tape. Distances to trees are to nail in side of tree.

Signed by William Lenca Date Mar. 25, 1997
 Surveyor's Michigan License No. 26461

MEMORUM

DEC 2 1987

COMMISSION

500