

CURVED
RECORDATION

APR 06 1999

Approved by Menominee County
Land Survey Remonumentation
Peer Group Under Act 345 Of
P.A. Of 1990 On 12/30, 1998
Mr. Davis RLS
Chairman

SECTION

LAND CORNER RECORDATION CERTIFICATE
Filing Requirement of Act 74, Mich. P.A. 1970

For corners in

MENOMINEE (County)	Located In:	Corner Code #
1. Public Land Survey	<u>T37N</u> <u>R27W</u>	<u>A-13</u>
	T ___ R ___	___
	T ___ R ___	___
	T ___ R ___	___
2. Property Controlling in Section	S ___ T ___ R ___	___
	S ___ T ___ R ___	___
3. Miscellaneous Property in Sec.	S ___ T ___ R ___	___
	S ___ T ___ R ___	___

RECEIVED FOR RECORD
99 JAN -6 AM 8:55
PAGE # 225-235
BARBARA MORRISON
REGISTER OF DEEDS
MENOMINEE MI 49858
Register of Deeds Stamp & File Number

4. Lot No. _____, Recorded Plat _____
5. Private Claims _____

(SAME AS CORNERS A-01, T36N - R27W; M-13, T37N - R28W; M-01, T36N - R28W)

I, William Lenca, in a field survey on Dec. 17, 1998 do hereby state that under requirements of P.A. 74, Michigan P.A. of 1970, the corner points mentioned in lines 1 and 2 above were in conformance with regulations and rules therefore as required in the current manual of survey instructions of the United States Department of the Interior, Bureau of Land Management or by a decree of a Court of Law and /or that the corner points mentioned in lines 3, 4 and 5 above were in conformance with the rules of the Michigan Board of Land Surveyors or by a Decree of a Court of Law; established, re-established, monumented, recovered, found as expressed below:

NOTE: Not more than 2 corners, all in the same town and range, may be recorded on this certificate.

	A	B	C	D	E	F	G	H	I	J	K	L	M
1													
2	6		5		4		3		2		1		
3													
4	7		8		9		10		11		12		
5													
6	18		17		16		15		14		13		
7													
8	19		20		21		22		23		24		
9													
10	30		29		28		27		26		25		
11													
12	31		32		33		34		35		36		
13													

A. Description of original monument and accessories and/or subsequent restoration:

- 1848: Original Survey by H. Brevoort, Jr. - B.T.'s - Sugar, 14" - N46°W - 36 lks.; Lynn, 14" - S51°W - 47 lks. All original evidence for this corner has been destroyed by logging activities.
- 1976: L.C.R.C. No. 131 by David B. Babbitt RLS No. 21558 states, "Set at record distance north from the stump of a white pine line tree noted as W. pine 40 inches in diam. at 69.65 on the east line of Sec. 1 - T36N - R28W and in line between said L.T. STP. and an 18" +/- W.P. stub with a very definite blaze and 2" or more of over growth believed to have been marked as a sight tree on the original gov't. survey. This stub is 482 ft. north of the twp. cor. The position of this corner as set fits record calls to hill, swamp edges, and streams as recorded in G.L.O. notes." Set 1" pipe with 4" aluminum cap. TIES: Oak, 11" - N52°W - 7.8'; Oak, 11" - S24°E - 16.6'; W. Ash, 5" - N20°E - 19.0'.

B. Description of corner evidence found and/or method applied in restoring or reestablishing corner:

We found a 1 inch diameter iron pipe with a 4 inch diameter aluminum cap stamped for corner location (D.N.R. Monument) in a location as indicated in Land Corner Recordation Certificate Number 131. The corner falls 16 feet South and 2 feet West of an old Fence Corner Post. The fence Runs East and West from this location and appears to be only about 20 to 30 years old. Since the corner was re-established based on original evidence, we accepted the position of the monument as a careful and faithful perpetuation of the position of the original corner.

C. Description of monument for corner and accessories established to perpetuate locating the position of the corner:

Accepted existing 1" dia. Iron Pipe/4" Aluminum cap (DNR monument) stamped for corner:

6" dia. Maple	N26°E	10.75 feet	"X" cut in upper & lower blazes
12" dia. Oak	S24°E	17.23 feet	Ex. B.T.
4" dia. Maple	S50°W	20.00 feet	"X" cut in upper & lower blazes
12" dia. Oak	N52°W	8.17 feet	Ex. B.T.
Metal Survey Sign Post	East	1.1 feet	

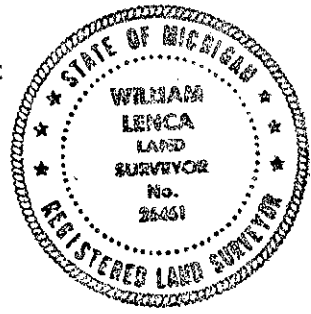

NOTE: All bearings are magnetic bearings. All distances are measured with steel tape. Distances to trees are to nail in side of tree.

Signed by William Lenca
Surveyor's Michigan License No. 26461

Date Dec. 28, 1998