

APR 06 1998

Approved by Menominee County  
Land Survey Remonumentation  
Peer Group Under Act 345 Of

P.A. of 1990 On 12/14, 1998

*McDermis*  
Chairman

SECTION

LAND CORNER RECORDATION CERTIFICATE  
Filing Requirement of Act 74, Mich. P.A. 1970

For corners in

MENOMINEE  
(County)

Located in:

Corner Code #

- 1. Public Land Survey T 37N R 27W G-11
- 2. Property Controlling in Section S T R
- 3. Miscellaneous Property in Sec. S T R

RECEIVED FOR RECORD  
99 JAN 27 PM 1:34  
PAGE # 754 BK5  
BARBARA MORRISON  
REGISTER OF DEEDS  
MENOMINEE, MI 49859

Register of Deeds Stamp & File Number

- 4. Lot No. \_\_\_\_\_, Recorded Plat \_\_\_\_\_
- 5. Private Claims \_\_\_\_\_

I, William Lenca, in a field survey on July 30, 1998 do hereby state that under requirements of P.A. 74, Michigan P.A. of 1970, the corner points mentioned in lines 1 and 2 above were in conformance with regulations and rules therefore as required in the current manual of survey instructions of the United States Department of the Interior, Bureau of Land Management or by a decree of a Court of Law and /or that the corner points mentioned in lines 3, 4 and 5 above were in conformance with the rules of the Michigan Board of Land Surveyors or by a Decree of a Court of Law; established, re-established, monumented, recovered, found as expressed below:

NOTE: Not more than 2 corners, all in the same town and range, may be recorded on this certificate.

A	B	C	D	E	F	G	H	I	J	K	L	M
1												
2	6	5	4	3	2	1						
3												
4	7	8	9	10	11	12						
5												
6	18	17	16	15	14	13						
7												
8	19	20	21	22	23	24						
9												
10	30	29	28	27	26	25						
11												
12	31	32	33	34	35	36						
13												

A. Description of original monument and accessories and/or subsequent restoration:

- 1852: Original Survey by Francis Coleman - B.T.'s - Beech, 14" - N30°W - 17 lks.; Sugar, 12" - S21°E - 61 lks. All original evidence for this corner has been destroyed by county road improvements.
- 1982: L.C.R.C. Number 531 by William Lenca states, "Found large spike below gravel road surface in line with county roads north - south and east and in line with old fence west." Set 3/4" x 18" Iron Pipe/Ident. cap. TIES: Stop Sign Post - N74°E - 65.82'; Sign Post - S77°E - 59.78'; Power Pole - S45°W - 47.23'.
- 1987: Certified Survey Number 509 by William Lenca shows this corner as being in the center of County Roads North - South and East.

B. Description of corner evidence found and/or method applied in restoring or reestablishing corner:

We found a 3/4" x 18" Iron Pipe in a location as indicated in Land Corner Recordation Certificate Number 531 by William Lenca. This position has been used for many years, fits existing lines of occupation, and is accepted as the best available evidence of the position of the original corner.

C. Description of monument for corner and accessories established to perpetuate locating the position of the corner:

Set 2" dia. Aluminum Pipe 30" long/3-1/4" dia. Alum cap stamped for corner location:

- 5/8" x 24" Iron Rod/2" dia. Alum. cap marked "WITNESS MARKER" N45°E 45.31 feet 1' E. of Road Sign
- 5/8" x 24" Iron Rod/2" dia. Alum. cap marked "WITNESS MARKER" S51°E 48.45 feet @ Sign Post
- 7" dia. Basswood S43°W 47.59 feet Scr. NBT
- 7" dia. Elm N31°W 54.90 feet Scr. NBT
- Survey Sign Post S51°E 49.0 feet

NOTE: All bearings are magnetic bearings. All distances are measured with steel tape. Distances to trees are to nail in side of tree.

Signed by William Lenca  
Surveyor's Michigan License No. 26461

Date Aug. 25, 1998

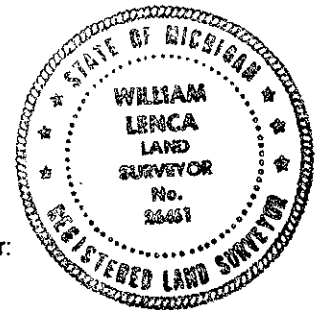

754