

APR 06 1999

Approved by Menominee County
Land Survey Remuneration
Peer Group Under Act 345 Of
P.A. Of 1990 On 12/14 1998
McLain RLS
Chairman

LAND CORNER RECORDATION CERTIFICATE
Filing Requirement of Act 74, Mich. P.A. 1970

For corners in

MENOMINEE
(County)

Located In:

Corner Code #

- | | | |
|------------------------------------|-----------------------------|-------------|
| 1. Public Land Survey | T <u>37</u> N R <u>27</u> W | <u>H-13</u> |
| | T ___ R ___ | _____ |
| | T ___ R ___ | _____ |
| | T ___ R ___ | _____ |
| 2. Property Controlling in Section | S ___ T ___ R ___ | _____ |
| | S ___ T ___ R ___ | _____ |
| 3. Miscellaneous Property in Sec. | S ___ T ___ R ___ | _____ |

RECEIVED FOR RECORD
99 JAN 27 PM 1:34
PAGE # 758 BKS
BARBARA MORRISON
REGISTER OF DEEDS
MENOMINEE, MI 49888

Register of Deeds Stamp & File Number

4. Lot No. _____, Recorded Plat _____
5. Private Claims _____

(SAME AS CORNER H-01, T36N - R27W)

I, William Lenca, in a field survey on Aug 17, 1998 do hereby state that under requirements of P.A. 74, Michigan P.A. of 1970, the corner points mentioned in lines 1 and 2 above were in conformance with regulations and rules therefore as required in the current manual of survey instructions of the United States Department of the Interior, Bureau of Land Management or by a decree of a Court of Law and /or that the corner points mentioned in lines 3, 4 and 5 above were in conformance with the rules of the Michigan Board of Land Surveyors or by a Decree of a Court of Law; established, re-established, monumented, recovered, found as expressed below:

NOTE: Not more than 2 corners, all in the same town and range, may be recorded on this certificate.

A	B	C	D	E	F	G	H	I	J	K	L	M
1												
2	6	5	4	3	2	1						
3												
4	7	8	9	10	11	12						
5												
6	18	17	16	15	14	13						
7												
8	19	20	21	22	23	24						
9												
10	30	29	28	27	26	25						
11												
12	31	32	33	34	35	36						
13												

A. Description of original monument and accessories and/or subsequent restoration:

- 1848: Original Survey by H. Brevoort, Jr. - B.T.'s - Beech, 10" - N51°E - 32 lks.; Beech, 14" - N06°W - 53 lks. All original evidence for this corner has been destroyed by county road improvements.
1981: Subdivision of Section 3, T36N - R27W by William Lenca shows he set a 3/4"x 18" Iron Pipe/ident. cap at this corner.

B. Description of corner evidence found and/or method applied in restoring or reestablishing corner:

We found a 3/4" x 18" Iron Pipe from William Lenca's 1981 survey. The corner location is on line between Section Corners and in line with an ancient fence running North, and falls 11 feet South of the centerline of the East - West County Road. This position has been used for many years, fits existing lines of occupation, and is accepted as the best available evidence of the position of the original corner.

C. Description of monument for corner and accessories established to perpetuate locating the position of the corner:

Set 2" dia. Aluminum Pipe 30" long/3-1/4" dia. Alum cap stamped for corner location:

7" dia. Maple	N37°E	82.33 feet	Scr. NBT
4" dia. Maple	S36°E	47.64 feet	Scr. NBT
12" dia. White Ash	S44°W	110.90 feet	Scr. NBT
3" dia. Maple	N50°W	70.01 feet	Scr. NBT
Metal Survey Sign Post	North	33.5 feet	

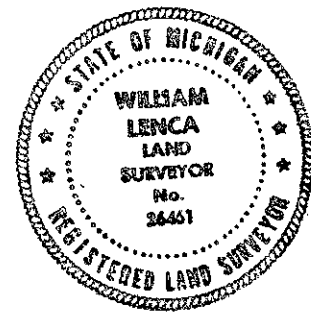

NOTE: All bearings are magnetic bearings. All distances are measured with steel tape. Distances to trees are to nail in side of tree.

Signed by William Lenca
Surveyor's Michigan License No. 26461

Date Aug. 25, 1998

758