

LAND CORNER RECORDATION CERTIFICATE
 Filing Requirement of Act 74, Mich. P.A. 1970

For corners in
MENOMINEE
 (County)

Located in:	Corner Code #
1. Public Land Survey	T <u>37N</u> R <u>27W</u> <u>I-3</u>
	T ___ R ___
	T ___ R ___
	T ___ R ___
2. Property Controlling in Section	S ___ T ___ R ___
	S ___ T ___ R ___
3. Miscellaneous Property in Sec.	S ___ T ___ R ___
	S ___ T ___ R ___

4. Lot No. _____, Recorded Plat _____
 5. Private Claims _____

97 JUL 23 PM 3:35
 RECEIVED FOR RECORDS
 PAGE # 504 BK 5
 BANGBARA MCGONIMON
 REGISTER OF DEEDS
 MENOMINEE, MICHIGAN
 Register of Deeds Stamp & File Number

I, William Lenca, in a field survey on Mar. 07, 19 97 do hereby state that under requirements of P.A. 74, Michigan P.A. of 1970, the corner points mentioned in lines 1 and 2 above were in conformance with regulations and rules therefore as required in the current manual of survey instructions of the United States Department of the Interior, Bureau of Land Management or by a decree of a Court of Law and for that the corner points mentioned in lines 3, 4 and 5 above were in conformance with the rules of the Michigan Board of Land Surveyors or by a Decree of a Court of Law; established, re-established, monumented, recovered, found as expressed below:

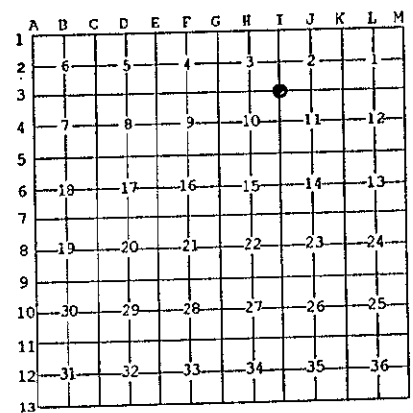

NOTE: Not more than 2 corners, all in the same town and range, may be recorded on this certificate.

A. Description of original monument and accessories and/or subsequent restoration:
 1852: Original Survey by Francis Coleman - B.T.'s - Spruce, 8" - N26°W - 63 lks.; Tamarack, 10" - S64°E - 48 lks. All original evidence for this corner has been destroyed by logging activities.

B. Description of corner evidence found and/or method applied in restoring or reestablishing corner:
 We re-established this corner by double proportional measurement between the NW Corner (G-3) of Section 10 and the NE Corner (K-3) of Section 11 for East - West position and between the E1/4 Corner (I-2) of Section 3 and the E1/4 Corner (I-4) of Section 10 for North - South Position. The corner thus established falls in the centerline of an old North - South Lane, and is accepted as a careful and faithful reestablishment of the position of the original corner.

C. Description of monument for corner and accessories established to perpetuate locating the position of the corner:
 Set 2" dia. Aluminum Pipe/3-1/4" dia. Alum cap stamped for corner location:

5" dia. Tamarack	N41°E	32.26 feet	Scr. NBT
7" dia. Tamarack	S51°E	16.76 feet	Scr. NBT
9" dia. Tamarack	S29°W	33.98 feet	Scr. NBT
9" dia. Cedar	N24°W	25.24 feet	Scr. NBT
Metal Survey Sign Post	West	11.8 feet	

NOTE: All bearings are magnetic bearings. All distances are measured with steel tape. Distances to trees are to nail in side of tree.

Signed by William Lenca Date Apr. 01, 1997
 Surveyor's-Michigan License No. 26461

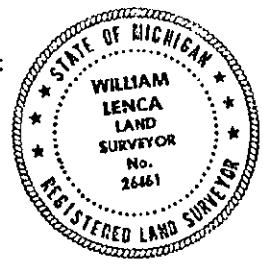

REMONUMENTATION

DEC 22 1997
 COMMISSION

504