

APR 06 1999

SECTION

Approved by Menominee County
Land Survey Remonumentation
Peer Group Under Act 345 Of

P.A. Of 1990 On 12/14, 1998
Mel Dault RLS
Chairman

LAND CORNER RECORDATION CERTIFICATE
Filing Requirement of Act 74, Mich. P.A. 1970

For corners in

MENOMINEE
(County)

Located In:

Corner Code #

1. Public Land Survey

T37N R 27W

J-13

T R

T R

T R

T R

2. Property Controlling
in Section

S T R

S T R

3. Miscellaneous
Property in Sec.

S T R

S T R

RECEIVED FOR RECORD
99 JAN 27 PM 1:34
PAGE # 764 BKS
BARBARA MORRISON
REGISTER OF DEEDS
MENOMINEE MI 49830

Register of Deeds Stamp & File Number

4. Lot No. _____, Recorded Plat _____

5. Private Claims _____

(SAME AS CORNER J-01, T36N-R27W.)

I, William Lenca, in a field survey on July 28, 1998 do hereby state that under requirements of P.A. 74, Michigan P.A. of 1970, the corner points mentioned in lines 1 and 2 above were in conformance with regulations and rules therefore as required in the current manual of survey instructions of the United States Department of the Interior, Bureau of Land Management or by a decree of a Court of Law and/or that the corner points mentioned in lines 3, 4 and 5 above were in conformance with the rules of the Michigan Board of Land Surveyors or by a Decree of a Court of Law; established, re-established, monumented, recovered, found as expressed below:

NOTE: Not more than 2 corners, all in the same town and range, may be recorded on this certificate.

	A	B	C	D	E	F	G	H	I	J	K	L	M
1													
2	6		5		4		3		2		1		
3													
4	7		8		9		10		11		12		
5													
6	18		17		16		15		14		13		
7													
8	19		20		21		22		23		24		
9													
10	30		29		28		27		26		25		
11													
12	31		32		33		34		35		36		
13													

A. Description of original monument and accessories and/or subsequent restoration:

1848: Original Survey by H. Brevoort, Jr. - B.T.'s - W. Pine, 24" - N67°W - 14 lks.; Hemlock, 6" - N53°E - 27 lks. All original evidence for this corner has been destroyed by county road improvements.

B. Description of corner evidence found and/or method applied in restoring or reestablishing corner:

We computed the single proportionate location for this corner but found no evidence of the original corner accessories, or evidence of subsequent restoration. We set the corner midway between section corners and in the centerline of an East - West county road. This matches well with the centerline of a county road to the South, and is accepted as the best available evidence of the position of the original corner.

C. Description of monument for corner and accessories established to perpetuate locating the position of the corner:

Set 5/8" x 24" Iron Rod/3-1/4" dia. Alum. cap stamped for corner location 6" below a gravel surfaced road:

8" dia. Maple	N68°E	89.20 feet	Scr. NBT
9" dia. Cedar	S26°E	65.66 feet	Scr. NBT
12" dia. Cedar	N62°W	79.32 feet	Scr. NBT
5/8" x 24" Iron Rod/2" dia. Alum. cap marked "WITNESS MARKER"	North	27.99 feet	
Metal Survey Sign Post	North	28.65 feet	

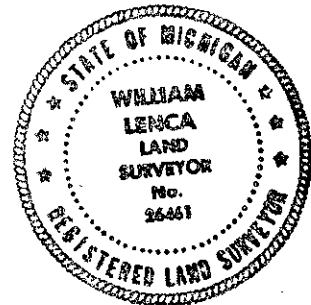

NOTE: All bearings are magnetic bearings. All distances are measured with steel tape. Distances to trees are to nail in side of tree.

Signed by William Lenca

Date Oct. 05, 1998

Surveyor's Michigan License No. 26461