

APR 06 1999

Approved by Menominee County  
Land Survey Remonumentation  
Peer Group Under Act 345 Of

P.A. of 1990 On 12/14, 1998

LAND CORNER RECORDATION CERTIFICATE  
Filing Requirement of Act 74, Mich. P.A. 1970

Mc Davis RLS  
Chairman  
09 JAN 27 PM 1:34  
RECEIVED FOR RECORD  
OFFICE # 762 BKS  
BARBARA MORRISON  
REGISTER OF DEEDS  
MENOMINEE MI 49828

SECTION

For corners in

MENOMINEE (County)	Located In:	Corner Code #
1. Public Land Survey	T37N R 27W	K-12
	T ___ R ___	_____
	T ___ R ___	_____
	T ___ R ___	_____
2. Property Controlling in Section	S ___ T ___ R ___	_____
	S ___ T ___ R ___	_____
3. Miscellaneous Property in Sec.	S ___ T ___ R ___	_____
	S ___ T ___ R ___	_____

Register of Deeds Stamp & File Number

4. Lot No. \_\_\_\_\_, Recorded Plat \_\_\_\_\_  
5. Private Claims \_\_\_\_\_

I, William Lenca, in a field survey on July 28, 1998 do hereby state that under requirements of P.A. 74, Michigan P.A. of 1970, the corner points mentioned in lines 1 and 2 above were in conformance with regulations and rules therefore as required in the current manual of survey instructions of the United States Department of the Interior, Bureau of Land Management or by a decree of a Court of Law and /or that the corner points mentioned in lines 3, 4 and 5 above were in conformance with the rules of the Michigan Board of Land Surveyors or by a Decree of a Court of Law; established, re-established, monumented, recovered, found as expressed below:

NOTE: Not more than 2 corners, all in the same town and range, may be recorded on this certificate.

	A	B	C	D	E	F	G	H	I	J	K	L	M
1													
2	6		5		4		3		2		1		
3													
4	7		8		9		10		11		12		
5													
6	18		17		16		15		14		13		
7													
8	19		20		21		22		23		24		
9													
10	30		29		28		27		26		25		
11													
12	31		32		33		34		35		36		
13													

A. Description of original monument and accessories and/or subsequent restoration:

1852: Original Survey by Francis Coleman - B.T.'s - Cedar, 12" - N65°W - 15 lks.; W. Pine, 12" - S40°E - 16 lks. All original evidence for this corner has been destroyed by logging activities.

B. Description of corner evidence found and/or method applied in restoring or reestablishing corner:

We set this corner at an ancient fence corner which is now replaced with a newer fence. This position fits well with a GLO terrain call to a creek North, fits well with corners 1/2 mile North and 1/2 mile South, and is accepted as the best available evidence of the position of the original corner.

C. Description of monument for corner and accessories established to perpetuate locating the position of the corner:

Set 3/4" dia. x 4' long aluminum rod/3-1/4" dia. Alum. cap stamped for corner location:

16" dia. Norway Pine	N47°E	7.08 feet	Scr. NBT
8" dia. Cedar	S51°E	80.70 feet	Scr. NBT
9" dia. White Pine	S78°W	14.93 feet	Scr. NBT
9" dia. White Pine	N21°W	58.83 feet	Scr. NBT
Metal Survey Sign Post	East	1.5 feet	

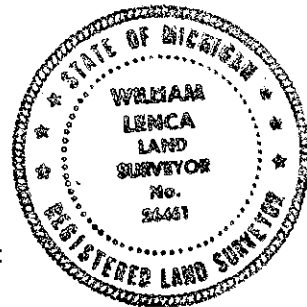

NOTE: All bearings are magnetic bearings. All distances are measured with steel tape. Distances to trees are to nail in side of tree.

Signed by William Lenca  
Surveyor's Michigan License No. 26461

Date Oct. 05, 1998