

MAR 29 2000

SECTION

LAND CORNER RECORDATION CERTIFICATE
Filing Requirement of Act 74, Mich. P.A. 1970

Approved by Menominee County
Land Survey Remonumentation
Peer Group Under Act 345 Of
P.A. Of 1990 On 12/28 1999
McDermott RLS
Chairman

BK. 6 Pg 46

RECEIVED FOR RECORD
28 DEC 1999 3:56:09 PM
BARBARA MORRISON
REGISTER OF DEEDS
MENOMINEE, MI 49858

Register of Deeds Stamp & File Number

| For corners in MENOMINEE (County) | Located In: | Corner Code # |
|---|-------------|---------------|
| 1. Public Land Survey | T 37N R 26W | A-10 |
| | T R | |
| | T R | |
| | T R | |
| 2. Property Controlling in Section | S T R | |
| | S T R | |
| 3. Miscellaneous Property in Sec. | S T R | |
| | S T R | |

4. Lot No. _____ Recorded Plat _____
5. Private Claims _____
SAMES AS CORNER M-10-T37N-R27W

William Lenca in a field survey on June 19⁹⁹ do hereby state that under requirements of P.A. 74, Michigan P.A. of 1970, the corner points mentioned in lines 1 and 2 above were in conformance with regulations and rules therefore as required in the current manual of survey instructions of the United States Department of the Interior, Bureau of Land Management or by a decree of a Court of Law and /or that the corner points mentioned in lines 3, 4 and 5 above were in conformance with the rules of the Michigan Board of Land Surveyors or by a Decree of a Court of Law; established, re-established, monumented, recovered, found as expressed below:

NOTE: Not more than 2 corners, all in the same town and range, may be recorded on this certificate.

| | A | B | C | D | E | F | G | H | I | J | K | L | M |
|----|----|----|----|----|----|----|---|---|---|---|---|---|---|
| 1 | | | | | | | | | | | | | |
| 2 | 6 | 5 | 4 | 3 | 2 | 1 | | | | | | | |
| 3 | | | | | | | | | | | | | |
| 4 | 7 | 8 | 9 | 10 | 11 | 12 | | | | | | | |
| 5 | | | | | | | | | | | | | |
| 6 | 18 | 17 | 16 | 15 | 14 | 13 | | | | | | | |
| 7 | | | | | | | | | | | | | |
| 8 | 19 | 20 | 21 | 22 | 23 | 24 | | | | | | | |
| 9 | | | | | | | | | | | | | |
| 10 | 30 | 29 | 28 | 27 | 26 | 25 | | | | | | | |
| 11 | | | | | | | | | | | | | |
| 12 | 31 | 32 | 33 | 34 | 35 | 36 | | | | | | | |
| 13 | | | | | | | | | | | | | |

A. Description of original monument and accessories and/or subsequent restoration:

- 1848: Original Survey by James H. Mullett - B.T.'s - Sugar, 10" - S45°W - 14 lks.; Ironwood, 6" - N53°W - 22 lks. All original evidence for this corner has been destroyed by farming activities.
- 1988: L.C.R.C. No. 816 by William Lenca, RLS No. 26461, states Fd 1" dia. I.P. at fence cor - position fits well with section corners N. & S. B.T.'s: 10" Elm - North - 10.29'; 10" Cherry - S85°E - 66.11'; 8" Elm - South - 73.42'.

B. Description of corner evidence found and/or method applied in restoring or reestablishing corner:

We recovered a 1 inch diameter iron pipe in line with ancient fence lines running North - South and East. We also found 3 B.T.'s as described in L.C.R.C. No. 816 above. This corner position fits very closely with a single proportional location, has been used for many years by local surveyors, and is accepted as the best available evidence of the position of the original corner.

C. Description of monument for corner and accessories established to perpetuate locating the position of the corner:

Set 3/4" dia. x 4' long aluminum rod/3-1/4" dia. Alum. cap stamped for corner inside existing 1" dia. Iron Pipe

| | | | |
|------------------------------|-------|------------|----------|
| 10" dia. Elm (Ex. B.T.) | North | 10.29 feet | Scr. NBT |
| 10" dia. Hemlock | S87°E | 64.04 feet | Scr. NBT |
| 12" dia. Ironwood (Ex. B.T.) | South | 73.42 feet | Scr. NBT |
| Metal Survey Sign Post | South | 1.33 feet | |
| Nothing else nearby | | | |

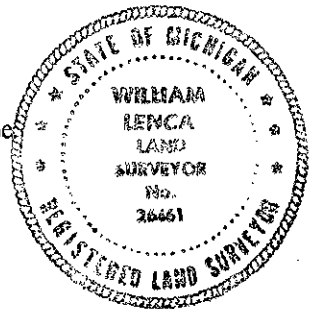

NOTE: All bearings are magnetic bearings. All distances are measured with steel tape. Distances to trees are to nail in side of tree.

Signed by William Lenca
Surveyor's Michigan License No. 26461

Date Dec. 21, 1999