

APR 06 1999

SECTION

Approved by Menominee County
Land Survey Remonumentation
Peer Group Under Act 345 Of

P.A. Of 1990 On 12/30, 1998

Mez Davis RLS
Chairman

LAND CORNER RECORDATION CERTIFICATE
Filing Requirement of Act 74, Mich. P.A. 1970

For corners in

MENOMINEE
(County)

Located In:

Corner Code #

- | | | | |
|---------------------------------------|-------------|--------------|-------------|
| 1. Public Land Survey | <u>T37N</u> | <u>R 27W</u> | <u>A-11</u> |
| | T | R | |
| | T | R | |
| | T | R | |
| 2. Property Controlling
in Section | S | T | R |
| | S | T | R |
| 3. Miscellaneous
Property in Sec. | S | T | R |
| | S | T | R |

RECEIVED FOR RECORD
99 JAN -6 AM 8:55
PAGE # 723 BK 5
BARBARA MORRISON
REGISTER OF DEEDS
MENOMINEE, MI 49808

Register of Deeds Stamp & File Number

4. Lot No. _____, Recorded Plat _____
5. Private Claims _____

(SAME AS CORNER M-11, T37N - R28W)

I, William Lenca, in a field survey on Dec. 17, 1998 do hereby state that under requirements of P.A. 74, Michigan P.A. of 1970, the corner points mentioned in lines 1 and 2 above were in conformance with regulations and rules therefore as required in the current manual of survey instructions of the United States Department of the Interior, Bureau of Land Management or by a decree of a Court of Law and /or that the corner points mentioned in lines 3, 4 and 5 above were in conformance with the rules of the Michigan Board of Land Surveyors or by a Decree of a Court of Law; established, re-established, monumented, recovered, found as expressed below:

NOTE: Not more than 2 corners, all in the same town and range, may be recorded on this certificate.

A	B	C	D	E	F	G	H	I	J	K	L	M
1												
2	6		5		4		3		2		1	
3												
4	7		8		9		10		11		12	
5												
6	18		17		16		15		14		13	
7												
8	19		20		21		22		23		24	
9												
10	30		29		28		27		26		25	
11												
12	31		32		33		34		35		36	
13												

A. Description of original monument and accessories and/or subsequent restoration:

- 1848: Original Survey (Twp. Bdy) by H. Brevoort, Jr. - B.T.'s - Tamarack, 8" - N50°W - 19 lks.; Tamarack, 10" - S75°W - 32 lks.
1852: Section Subdivision by Francis Coleman - B.T.'s - Tamarack, 6" - N70°E - 63 lks.; Tamarack, 8" - S80°E - 57 lks. All original evidence for this corner has been destroyed by farming activities.
1982: L.C.R.C. No. 566 by David B. Babbitt RLS No. 21558 states, "Set in center line of E-W road at 79.2 ft. (G.L.O. record Mea.) West of small stream. This falls in line with old Cedar posts North and South." Set 1" Pipe with 4" Aluminum Cap. TIES: Willow (Twin), 16" - S75°W - 104.00'; W. Birch, 4" - N62°E - 37.4'; 2" pipe for gate - S88°E - 31.0'; Cedar, 7" - S64°E - 66.0'.

B. Description of corner evidence found and/or method applied in restoring or reestablishing corner:

We found a 1 inch diameter iron pipe with 4 inch aluminum cap (D.N.R. Monument) and witnesses in a location as indicated in Land Corner Recordation Certificate Number 566. The corner is 79' west of a stream and in the centerline of a lane to the East and a county road to the West. This location has been used for 16 years and is accepted as the best available evidence of the position of the original corner.

C. Description of monument for corner and accessories established to perpetuate locating the position of the corner:

Accepted existing 1" dia. Iron Pipe/4" dia. Aluminum cap (DNR monument) stamped for corner:

10" dia. Tamarack	N15°E	83.26 feet	"X" cut in upper & lower blazes
8" dia. Cedar	S61°E	66.36 feet	Ex. B.T.
9" dia. Tamarack	S56°W	69.35 feet	"X" cut in upper & lower blazes
7" dia. Tamarack	N70°W	78.09 feet	"X" cut in upper & lower blazes
Metal Survey Sign Post	North	10.7 feet	

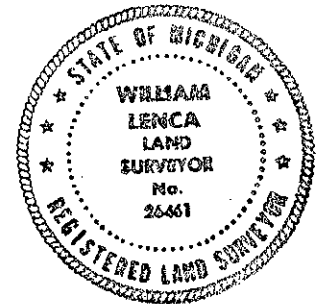

NOTE: All bearings are magnetic bearings. All distances are measured with steel tape. Distances to trees are to nail in side of tree.

Signed by William Lenca
Surveyor's Michigan License No. 26461

Date Dec. 28, 1998