

MAR 29 2000

Approved by Menominee County
Land Survey Remonumentation
Peer Group Under Act 345 Of
P.A. Of 1999 On 12/28, 1999
Mike Davis RLS
Chairman

LAND CORNER RECORDATION CERTIFICATE
Filing Requirement of Act 74, Mich. P.A. 1970

SECTION

For corners in
MENOMINEE

(County)

Located In: Corner Code #

- 1. Public Land Survey T 37N R 26W K-11
T ___ R ___
T ___ R ___
T ___ R ___
- 2. Property Controlling in Section S ___ T ___ R ___
S ___ T ___ R ___
- 3. Miscellaneous Property in Sec. S ___ T ___ R ___
S ___ T ___ R ___

BK. 6 Pg 53

RECEIVED FOR RECORD
28 DEC 1999 3:56:09 PM
BARBARA MORRISON
REGISTER OF DEEDS
MENOMINEE, MI 49858

Register of Deeds Stamp & File Number

- 4. Lot No. _____, Recorded Plat _____
- 5. Private Claims _____

I, William Lenca, in a field survey on Dec., 1999 do hereby state that under requirements of P.A. 74, Michigan P.A. of 1970, the corner points mentioned in lines 1 and 2 above were in conformance with regulations and rules therefore as required in the current manual of survey instructions of the United States Department of the Interior, Bureau of Land Management or by a decree of a Court of Law and/or that the corner points mentioned in lines 3, 4 and 5 above were in conformance with the rules of the Michigan Board of Land Surveyors or by a Decree of a Court of Law; established, re-established, monumented, recovered, found as expressed below:

NOTE: Not more than 2 corners, all in the same town and range, may be recorded on this certificate.

	A	B	C	D	E	F	G	H	I	J	K	L	M
1													
2		6		5		4		3		2		1	
3													
4		7		8		9		10		11		12	
5													
6		18		17		16		15		14		13	
7													
8		19		20		21		22		23		24	
9													
10		30		29		28		27		26		25	
11													
12		31		32		33		34		35		36	
13													

A. Description of original monument and accessories and/or subsequent restoration:

1852: Original Survey by Francis Coleman - B.T.'s - Hemlock, 16" - N18°E - 24 lks.; Hemlock, 18" - S20°W - 25 lks. All original evidence for this corner has been destroyed by County Road improvements.

B. Description of corner evidence found and/or method applied in restoring or reestablishing corner:

This corner was re-set in line with the centerline of a county road running West and South, and in line with old fences running North and East. This position fits well with measurements to other corners in the area and with long standing lines of occupation, and is accepted as the best available evidence of the position of the original corner.

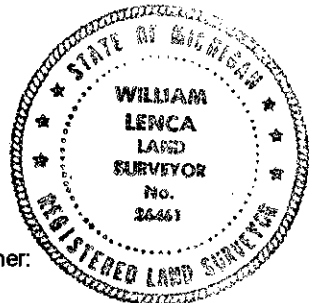

C. Description of monument for corner and accessories established to perpetuate locating the position of the corner:

Set 5/8" x 24" Iron Rod/3-1/4" dia. Alum. cap stamped for corner location:

- 9" dia. Maple N39°E 30.49 feet Scr. NBT
- Lower Hinge Pin on 5" dia. Gate Post S22°E 44.90 feet
- 4" dia. Cedar N36°W 49.46 feet Scr. NBT
- Metal Survey Sign Post East 19.85 feet

NOTE: All bearings are magnetic bearings. All distances are measured with steel tape. Distances to trees are to nail in side of tree.

Signed by William Lenca 26461
Surveyor's Michigan License No. _____

Date Dec. 22, 1999

53