

LAND CORNER RECORDATION CERTIFICATE
 Filing Requirement of Act 74, Mich. P.A. 1970

For corners in

<u>MENOMINEE</u> (County)	Located In:	Corner Code #
1. Public Land Survey	T37N R. 25W T38 R 25 T38 R 26 T37 R 26	A01 A-13 M-13 M-1 ✓
2. Property Controlling in Section	S ___ T ___ R ___ S ___ T ___ R ___	___ ___
3. Miscellaneous Property in Sec.	S ___ T ___ R ___ S ___ T ___ R ___	___ ___

RECORDED FOR RECORD
 96 OCT -7 PM 3:26
 PAGE # 361 BK 4
 BARBARA HORTONSON
 REGISTERED CLERK
 REGISTERED CLERK

Register of Deeds Stamp & File Number

4. Lot No. _____, Recorded Plat _____
 5. Private Claims _____

SAME AS CORNERS M-1 T37N-R26W; A-13 T38N-R25W; M-13 T38N-R26W

I, William Lenca, in a field survey on May 15, 19 96 do hereby state that under requirements of P.A. 74, Michigan P.A. of 1970, the corner points mentioned in lines 1 and 2 above were in conformance with regulations and rules therefore as required in the current manual of survey instructions of the United States Department of the Interior, Bureau of Land Management or by a decree of a Court of Law and /or that the corner points mentioned in lines 3, 4 and 5 above were in conformance with the rules of the Michigan Board of Land Surveyors or by a Decree of a Court of Law; established, re-established, monumented, recovered, found as expressed below:

NOTE: Not more than 2 corners, all in the same town and range, may be recorded on this certificate.

A	B	C	D	E	F	G	H	I	J	K	L	M
1												
2	6	5	4	3	2	1						
3												
4	7	8	9	10	11	12						
5												
6	18	17	16	15	14	13						
7												
8	19	20	21	22	23	24						
9												
10	30	29	28	27	26	25						
11												
12	31	32	33	34	35	36						
13												

A. Description of original monument and accessories and/or subsequent restoration:

1847: Original Survey by James H. Mullett - B.T.'s - Tamarack, 12" - N43°E - 13 lks. ; Tamarack, 12" - N35°W - 23 lks. All original evidence has been destroyed by county road improvements.

B. Description of corner evidence found and/or method applied in restoring or reestablishing corner:

We set this corner in the centerline of a North - South County Road and at a proportional position between the West Quarter Corner of Section 31, T38N-R25W (A-12) and the Southwest Corner of Section 6, T37N-R25W (A03). We accepted this corner location as a careful and faithful reestablishment of the position of the original corner.

C. Description of monument for corner and accessories established to perpetuate locating the position of the corner:
 Set 2" dia. Aluminum Pipe/3-1/4" dia. Alum. cap stamped for corner location:

14" dia. Tamarack	N67°E	38.54 feet	Scr. NBT
8" dia. Tamarack	S35°E	59.78 feet	Scr. NBT
9" dia. Black Spruce	S59°W	35.84 feet	Scr. NBT
9" dia. Black Spruce	N35°W	55.96 feet	Scr. NBT
Metal Survey Sign Post	West	26.2 feet	

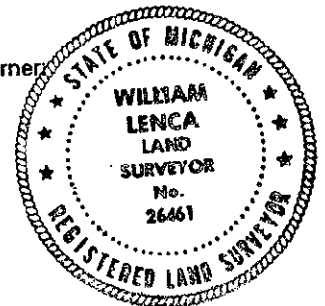

NOTE: All bearings are magnetic bearings. All distances are measured with steel tape. Distances to trees are to nail in side of tree.

Signed by William Lenca
 Surveyor's Michigan License No. 26461

Date Sep. 24, 1996

361