

Approved by Menominee County  
 Land Survey Remonumentation  
 Peer Group Under Act 345 Of  
 P.A. Of 1990 On 9/25 19996  
Mc. Davis RLS  
 Chairman

**LAND CORNER RECORDATION CERTIFICATE**  
 Filing Requirement of Act 74, Mich. P.A. 1970

For corners in

MENOMINEE  
 (County)

Located In:

Corner Code #

1. Public Land Survey

T37N R 25W      A13  
 T36N R 26W      M-1  
 T36N R 25W      A-1  
 T37N R 26W      M-13 ✓

2. Property Controlling in Section

S \_\_\_ T \_\_\_ R \_\_\_  
 S \_\_\_ T \_\_\_ R \_\_\_  
 S \_\_\_ T \_\_\_ R \_\_\_  
 S \_\_\_ T \_\_\_ R \_\_\_

3. Miscellaneous Property in Sec.

RECEIVED FOR RECORD  
 96 OCT -7 PM 3:27  
 BARBARA NORRISON  
 REGISTER OF DEEDS  
 MENOMINEE COUNTY MI 49825  
 PAGE # 369 BK-9

Register of Deeds Stamp & File Number

4. Lot No. \_\_\_\_\_, Recorded Plat \_\_\_\_\_

5. Private Claims \_\_\_\_\_

SAME AS CORNERS M-13 T37N-R26W; M-1 T36N-R26W; A-1 T36N-R25W

I, William Lenca, in a field survey on Nov. 06, 19 96 do hereby state that under requirements of P.A. 74, Michigan P.A. of 1970, the corner points mentioned in lines 1 and 2 above were in conformance with regulations and rules therefore as required in the current manual of survey instructions of the United States Department of the Interior, Bureau of Land Management or by a decree of a Court of Law and /or that the corner points mentioned in lines 3, 4 and 5 above were in conformance with the rules of the Michigan Board of Land Surveyors or by a Decree of a Court of Law; established, re-established, monumented, recovered, found as expressed below:

NOTE: Not more than 2 corners, all in the same town and range, may be recorded on this certificate.

	A	B	C	D	E	F	G	H	I	J	K	L	M
1													
2	6			5			4			3			1
3													
4	7			8			9			10			12
5													
6	18			17			16			15			13
7													
8	19			20			21			22			24
9													
10	30			29			28			27			25
11													
12	31			32			33			34			36
13													

A. Description of original monument and accessories and/or subsequent restoration:  
 1847: Original Survey (Twp Bdy) by James H. Mullett - B.T.'s - Hemlock, 24" - N55°W - 06 lks.; Birch, 8" - N72°E - 41 lks. All original evidence for this corner has been destroyed by logging activities and fire.

B. Description of corner evidence found and/or method applied in restoring or reestablishing corner:  
 This corner position was re-established by double proportionate method using the Northwest Corner of Section 1 (K-1), T36N-R26W to the West; the Southwest Corner of Section 7 (A-5), T36N-R25W to the South; the South Quarter Corner of Section 32 (D-13), T37N-R25W to the East; and the Northwest Corner of Section 30 (A-9), T37N-R25W to the North. Once we had located the corner position by proportionate means, we searched the area for several hours. We found remnants of Hemlock stumps in the area, but they were at such a state of decay that no markings could be determined. We accepted the double proportionate location as a careful and faithful reestablishment of the position of the original corner.

C. Description of monument for corner and accessories established to perpetuate locating the position of the corner:  
 Set 2" dia. Aluminum Pipe/3-1/4" dia. Alum cap stamped for corner location:

18" dia. White Ash	N39°E	21.17 feet	Scr. NBT
9" dia. Maple	S81°E	32.85 feet	Scr. NBT
6" dia. Maple	South	22.61 feet	Scr. NBT
7" dia. Maple	S75°W	7.44 feet	Scr. NBT
Metal Survey Sign Post	North	1.0 feet	

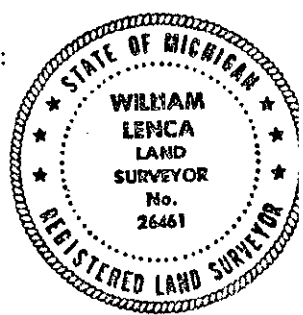

NOTE: All bearings are magnetic bearings. All distances are measured with steel tape. Distances to trees are to nail in side of tree.

Signed by William Lenca  
 Surveyor's Michigan License No. 26461

Date Sep. 24, 1996