

LAND CORNER RECORDATION CERTIFICATE
Filing Requirement of Act 74, Mich. P.A. 1970

For corners in
MENOMINEE
(County)

Located In: Corner Code #

1. Public Land Survey T38N R 25W D-11
T R
T R
T R

2. Property Controlling S T R
in Section S T R

3. Miscellaneous S T R
Property in Sec. S T R

RECEIVED FOR RECORD
97 JUL 23 PM 3:35
PAGE # 508, 265
BARBARA MORRISON
REGISTER OF DEEDS
MENOMINEE, MICHIGAN
Register of Deeds Stamp & File Number

4. Lot No. _____, Recorded Plat _____
5. Private Claims _____

I, William Lenca, in a field survey on June 02, 1997 do hereby state that under requirements of P.A. 74, Michigan P.A. of 1970, the corner points mentioned in lines 1 and 2 above were in conformance with regulations and rules therefore as required in the current manual of survey instructions of the United States Department of the Interior, Bureau of Land Management or by a decree of a Court of Law and for that the corner points mentioned in lines 3, 4 and 5 above were in conformance with the rules of the Michigan Board of Land Surveyors or by a Decree of a Court of Law; established, re-established, monumented, recovered, found as expressed below:

1	A	B	C	D	E	F	G	H	I	J	K	L	M
2		6		5		4		3		2		1	
3													
4		7		8		9		10		11		12	
5													
6		19		17		16		15		14		13	
7													
8		19		20		21		22		23		24	
9													
10		30		29		28		27		26		25	
11													
12		31		32		33		34		35		36	
13													

NOTE: Not more than 2 corners, all in the same town and range, may be recorded on this certificate.

A. Description of original monument and accessories and/or subsequent restoration:

1852: Original Survey by George Adair - B.T.'s - Sugar, 7" - S67°E - 10 lks.; Lynn, 18" - N44°W - 41 lks. All original evidence for this corner has been destroyed by county road improvements.

B. Description of corner evidence found and/or method applied in restoring or reestablishing corner:

We found a railroad spike set in the centerline of a North - South County Road and in line with an old fence running West. This corner has been accepted and used by local surveyors for several years, and is accepted as the best available evidence of the position of the original corner.

C. Description of monument for corner and accessories established to perpetuate locating the position of the corner:
Set 5/8" x 24" Iron Rod 3/16" dia. Alum. cap stamped for corner location in Monument Box:

5" dia. Maple	N25°W	65.44 feet	Scr. NBT
SE Corner of Garage Foundation	N80°E	76.86 feet	
8" dia. Maple	S51°E	65.40 feet	Scr. NBT
4" dia. Maple	S63°W	47.72 feet	Scr. NBT
Metal Survey Sign Post	N86°W	32.2 feet	

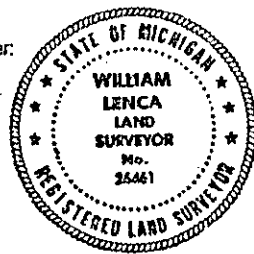

NOTE: All bearings are magnetic bearings. All distances are measured with steel tape. Distances to trees are to nail in side of tree.

Signed by William Lenca Date June 06, 1997
Surveyor's Michigan License No. 26461

HEPOMIAPLITIC

DEC 2 1997

COMMISSION

508