

LAND CORNER RECORDATION CERTIFICATE
 Filing Requirement of Act 74, Mich. P.A. 1970

For corners in
MENOMINEE
 (County)

1. Public Land Survey	T <u>38</u> N R <u>25</u> W	<u>E-12</u>
	T ___ R ___	_____
	T ___ R ___	_____
	T ___ R ___	_____
2. Property Controlling in Section	S ___ T ___ R ___	_____
	S ___ T ___ R ___	_____
3. Miscellaneous Property in Sec.	S ___ T ___ R ___	_____
	S ___ T ___ R ___	_____

REGISTERED FOR RECORD
 97 JUL 23 PM 3:35
 PAGE # 570 BK 5
 BARBARA MORRISON
 REGISTER OF DEEDS
 MENOMINEE MI 49858
 Register of Deeds Stamp & File Number

4. Lot No. _____, Recorded Plat _____
 5. Private Claims _____

I, William Lenca, in a field survey on June 02, 1997 do hereby state that under requirements of P.A. 74, Michigan P.A. of 1970, the corner points mentioned in lines 1 and 2 above were in conformance with regulations and rules therefore as required in the current manual of survey instructions of the United States Department of the Interior, Bureau of Land Management or by a decree of a Court of Law and/or that the corner points mentioned in lines 3, 4 and 5 above were in conformance with the rules of the Michigan Board of Land Surveyors or by a Decree of a Court of Law, established, re-established, monumented, recovered, found as expressed below:

1	A	B	C	D	E	F	G	H	I	J	K	L	M
2		6		5		4		3		2		1	
3													
4		7		8		9		10		11		12	
5													
6		18		17		16		15		14		13	
7													
8		19		20		21		22		23		24	
9													
10		30		29		28		27		26		25	
11													
12		31		32		33		34		35		36	
13													

NOTE: Not more than 2 corners, all in the same town and range, may be recorded on this certificate.

A. Description of original monument and accessories and/or subsequent restoration:

1852: Original Survey by George Adair - Original Notes state" - 34.69 chains - Intersect Beaver Pond, c. NE & SW; 35.34 chains - Cedar, 8" for Witness corner for 1/4 Post in Pond - Tamarack, 6", N65°E, 8 lks; 39.87 chains - 1/4 Sec. Post in Pond; 42.66 chains - over Beaver Pond. No original evidence for this corner was recovered.

B. Description of corner evidence found and/or method applied in restoring or reestablishing corner:

We re-established this corner on line and midway between the Northeast Corner (E-11) and the Southeast Corner (E-13) of Section 32, T38N-R25W. The corner position thus established falls in a marshy area, 57 feet East of the center of a creek 8' wide running Southerly, and is accepted as a careful and faithful reestablishment of the position of the original corner.

C. Description of monument for corner and accessories established to perpetuate locating the position of the corner:
 Sect 2" dia. Aluminum Pipe/3-1/4" dia. Alum cap stamped for corner location:

11" dia. Elm	N56°E	7.03 feet	Scr. NBT
14" dia. Maple	S28°E	23.44 feet	Scr. NBT
10" dia. Maple	S68°W	37.07 feet	Scr. NBT
12" dia. Elm	N37°W	22.39 feet	Scr. NBT
Metal Survey Sign Post	East	0.9 feet	

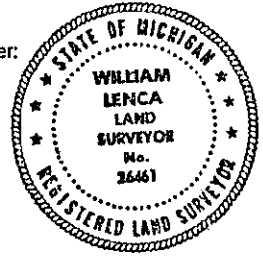

NOTE: All bearings are magnetic bearings. All distances are measured with steel tape. Distances to trees are to nail in side of tree.

Signed by William Lenca Date June 06, 1997
 Surveyor's Michigan License No. 26461

REMONUMENTATION

DEC 2 1997

COPIES

510