

LAND CORNER RECORDATION CERTIFICATE  
 Filing Requirement of Act 74, Mich. P.A. 1970

For corners in  
**MENOMINEE**  
 (County)

Located In: Corner Code -#

	37N	26W	D-1
1. Public Land Survey	T	R	
	T	R	
	T <u>38</u>	R <u>26</u>	<u>D-13</u> ✓
	T	R	
2. Property Controlling in Section	S	T	R
	S	T	R
3. Miscellaneous Property in Sec.	S	T	R
	S	T	R

REGISTERED FOR RECORD  
 95 DEC 27 PM 3:3  
 PAGE # 304 BK 1  
 BARBARA JOHNSON  
 REGISTERED CLERK  
 MENOMINEE, MICHIGAN

Register of Deeds Stamp & File Number

4. Lot No. \_\_\_\_\_, Recorded Plat \_\_\_\_\_  
 5. Private Claims \_\_\_\_\_  
 (SAME AS D-13 T38N-R26W) ✓

William Lenca Nov. 14 95

I, \_\_\_\_\_, in a field survey on \_\_\_\_\_, 19\_\_\_\_, do hereby certify that under requirements of P.A. 74, Michigan P.A. of 1970, the corner points mentioned in lines 1 and 2 above were in conformance with regulations and rules therefore as required in the current manual of survey instructions of the United States Department of the Interior, Bureau of Land Management or by a decree of a Court of Law and/or that the corner points mentioned in lines 3, 4 and 5 above were in conformance with the rules of the Michigan Board of Land Surveyors or by a Decree of a Court of Law; established, re-established, monumented, re-monumented, recovered, found as expressed below:

	A	B	C	D	E	F	G	H	I	J	K	L	M
2	6	5	4	3	2	1							
3													
4	7	8	9	10	11	12							
5													
6	10	17	16	15	14	13							
7													
8	19	20	21	22	23	24							
9													
10	30	29	28	27	26	25							
11													
12	31	32	33	34	35	36							
13													

NOTE: Not more than 4 corners, all in the same town and range, may be recorded on this certificate.

A. Description of original monument and accessories and/or subsequent restoration:

1848: Original Survey by James H. Mullett - B.T.'s - Hemlock, 9" - N60°E - 17 lks; Hemlock, 9" - N05°W - 27 lks. All original evidence has been destroyed by farming activities.

B. Description of corner evidence found and/or method applied in restoring or reestablishing corner:

In a 1995 Survey in Section 5, T37N-R26W, we found a 5/8" diameter iron rod at the intersection of an ancient 4 way fence line - very old rock and wire fences run North - South - East & West. This corner position fits with original terrain calls to "foot of hill" 1 chain (66 feet) West (recorded and measured) and "leave swamp, c. NE, and begin to ascend hill" 11 chains (726 feet) East (recorded and measured), and is accepted as the best available evidence of the position of the original corner.

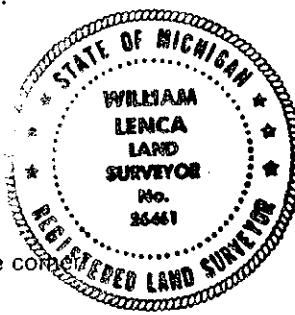

C. Description of monument for corner and accessories established to perpetuate locating the position of the corner:

Set 3-1/4" dia. Alum. cap stamped for corner location on existing 5/8" dia. iron rod:

East tree of twin 24" dia. Maples	North	27.64 feet	Scr. NBT
9" dia. Balsam	East	15.76 feet	Scr. NBT
7" dia. Cedar	S41°W	25.00 feet	Scr NBT
Metal Survey Sign Post	West	4.5 feet	

NOTE: All bearings are magnetic bearings. All distances are measured with a steel tape. Distances to trees are to nail in side of tree.

Signed by William Lenca Date Nov. 17, 1995  
 Surveyor's Michigan License No. 26461

304