

SURVEY & REMONUMENTATION

MAR 29 2000

SECTION

LAND CORNER RECORDATION CERTIFICATE
Filing Requirement of Act 74, Mich. P.A. 1970

Approved by Menominee County
Land Survey Remonumentation
Peer Group Under Act 345 Of
P.A. Of 1990 On 12/23 1999
MLL SAUVIS RLS

Bk. 6 Pg. 40

RECEIVED FOR RECORD
28 DEC 1999 3:56:09 PM
BARBARA MORRISON
REGISTER OF DEEDS
MENOMINEE, MI 49858

Register of Deeds Stamp & File Number

For corners in <u>MENOMINEE</u> (County)	Located In:	Corner Code #
1. Public Land Survey	T <u>38N</u> R <u>27W</u>	<u>L-3</u>
	T <u> </u> R <u> </u>	<u> </u>
	T <u> </u> R <u> </u>	<u> </u>
	T <u> </u> R <u> </u>	<u> </u>
2. Property Controlling in Section	S <u> </u> T <u> </u> R <u> </u>	<u> </u>
	S <u> </u> T <u> </u> R <u> </u>	<u> </u>
3. Miscellaneous Property in Sec.	S <u> </u> T <u> </u> R <u> </u>	<u> </u>
	S <u> </u> T <u> </u> R <u> </u>	<u> </u>

4. Lot No. _____, Recorded Plat _____
5. Private Claims _____

I, William Lenca, in a field survey on June, 1999 do hereby state that under requirements of P.A. 74, Michigan P.A. of 1970, the corner points mentioned in lines 1 and 2 above were in conformance with regulations and rules therefore as required in the current manual of survey instructions of the United States Department of the Interior, Bureau of Land Management or by a decree of a Court of Law and /or that the corner points mentioned in lines 3, 4 and 5 above were in conformance with the rules of the Michigan Board of Land Surveyors or by a Decree of a Court of Law; established, re-established, monumented, recovered, found as expressed below:

NOTE: Not more than 2 corners, all in the same town and range, may be recorded on this certificate.

A	B	C	D	E	F	G	H	I	J	K	L	M
1												
2	6	5	4	3	2	1						
3												
4	7	8	9	10	11	12						
5												
6	18	17	16	15	14	13						
7												
8	19	20	21	22	23	24						
9												
10	30	29	28	27	26	25						
11												
12	31	32	33	34	35	36						
13												

A. Description of original monument and accessories and/or subsequent restoration:

- 1852: Original Survey by Harvey Mellen - B.T.'s - Cedar, 10" - N49°E - 18 lks.; Cedar, 8" - S79°W - 9 lks. All original evidence for this corner has been destroyed by County Road improvements.
- 1989: L.C.R.C. No. 848 by William Lenca, RLS No. 26461 - Set Railroad spike in line with Co. Rd. centerlines E-W-N. TIES: "+" chiseled on SE Cor. of E. Headwall - N27°E - 25.20'; Spruce, 18" - S43°W - 24.68'; "+" chiseled on SW Co. of W. Headwall - N28°W - 25.88'.

B. Description of corner evidence found and/or method applied in restoring or reestablishing corner:

We recovered a Railroad Spike in the centerline of a County Road running East - West and North. We also found the 3 ties described in LCRC No. 848 (see part A above) which fit the railroad spike. This corner position fits well with measurements to corners 1/2 mile East and 1/2 mile West and also fits well GLO swamp calls 1.1 chains East and 1.1 chains West. The existing railroad spike has been accepted and used by local surveyors for at least 10 years, and is accepted as the best available evidence of the position of the original corner.

C. Description of monument for corner and accessories established to perpetuate locating the position of the corner:

Set 5/8" x 24" Iron Rod/3-1/4" dia. Alum. cap stamped for corner location in Monument Box:

7" dia. Cedar	N15°E	107.22 feet	Scr. NBT
9" dia. Spruce	S80°E	121.00 feet	Scr. NBT
5/8" x 24" Iron Rod/2" dia. Alum. cap marked "WITNESS MARKER"	S08°W	22.38 feet	
20" dia. Spruce (Ex. B.T.)	S43°W	24.68 feet	Scr. NBT
Metal Survey Sign Post	S08°W	22.85 feet	

NOTE: All bearings are magnetic bearings. All distances are measured with steel tape. Distances to trees are to nail in side of tree.

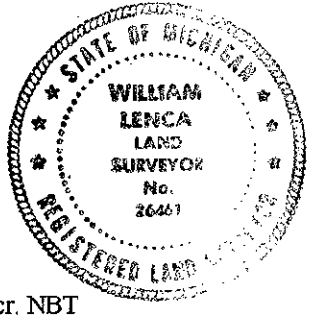

Signed by William Lenca
Surveyor's Michigan License No. 26461

Date July 9, 1999