

MAR 29 2000

SECTION

LAND CORNER RECORDATION CERTIFICATE  
Filing Requirement of Act 74, Mich. P.A. 1970

Approved by Menominee County  
Land Survey Remonumentation  
Peer Group Under Act 345 Of  
P.A. of 1990 On 12/28, 1999  
Mr. Davis Res  
Chairman

BK 6 Pg 41

RECEIVED FOR RECORD  
28 DEC 1999 3:56:09 PM  
BARBARA MORRISON  
REGISTER OF DEEDS  
MENOMINEE, MI 49858

Register of Deeds Stamp & File Number

For corners in  
MENOMINEE  
(County)

Located In: Corner Code #

|                                       |                           |            |
|---------------------------------------|---------------------------|------------|
| 1. Public Land Survey                 | T <u>38N</u> R <u>27W</u> | <u>L-5</u> |
|                                       | T ___ R ___               | _____      |
|                                       | T ___ R ___               | _____      |
|                                       | T ___ R ___               | _____      |
| 2. Property Controlling<br>in Section | S ___ T ___ R ___         | _____      |
|                                       | S ___ T ___ R ___         | _____      |
| 3. Miscellaneous<br>Property in Sec.  | S ___ T ___ R ___         | _____      |
|                                       | S ___ T ___ R ___         | _____      |

4. Lot No. \_\_\_\_\_, Recorded Plat \_\_\_\_\_  
5. Private Claims \_\_\_\_\_

I, William Lenca, in a field survey on May, 1999 do hereby state that under requirements of P.A. 74, Michigan P.A. of 1970, the corner points mentioned in lines 1 and 2 above were in conformance with regulations and rules therefore as required in the current manual of survey instructions of the United States Department of the Interior, Bureau of Land Management or by a decree of a Court of Law and /or that the corner points mentioned in lines 3, 4 and 5 above were in conformance with the rules of the Michigan Board of Land Surveyors or by a Decree of a Court of Law; established, re-established, monumented, recovered, found as expressed below:

NOTE: Not more than 2 corners, all in the same town and range, may be recorded on this certificate.

|    | A  | B | C  | D | E  | F | G  | H | I  | J | K  | L | M |
|----|----|---|----|---|----|---|----|---|----|---|----|---|---|
| 1  |    |   |    |   |    |   |    |   |    |   |    |   |   |
| 2  | 6  |   | 5  |   | 4  |   | 3  |   | 2  |   | 1  |   |   |
| 3  |    |   |    |   |    |   |    |   |    |   |    |   |   |
| 4  | 7  |   | 8  |   | 9  |   | 10 |   | 11 |   | 12 |   |   |
| 5  |    |   |    |   |    |   |    |   |    |   |    |   |   |
| 6  | 18 |   | 17 |   | 16 |   | 15 |   | 14 |   | 13 |   |   |
| 7  |    |   |    |   |    |   |    |   |    |   |    |   |   |
| 8  | 19 |   | 20 |   | 21 |   | 22 |   | 23 |   | 24 |   |   |
| 9  |    |   |    |   |    |   |    |   |    |   |    |   |   |
| 10 | 30 |   | 29 |   | 28 |   | 27 |   | 26 |   | 25 |   |   |
| 11 |    |   |    |   |    |   |    |   |    |   |    |   |   |
| 12 | 31 |   | 32 |   | 33 |   | 34 |   | 35 |   | 36 |   |   |
| 13 |    |   |    |   |    |   |    |   |    |   |    |   |   |

A. Description of original monument and accessories and/or subsequent restoration:

- 1852: Original Survey by Harvey Mellen - B.T.'s - Hemlock, 20" - N66°E - 62 lks.; Hemlock, 18" - S83°W - 25 lks. All original evidence for this corner has been destroyed by County Road improvements.
- 1989: L.C.R.C. No. 846 by William Lenca, RLS No. 26461 - Set P.K. (later replaced with 5/8" x 24" Iron) in location to fit lines of occupation to the East & West & c/l of E-W Co. Rd. TIES: SW Cor. Conc. Blk Barn - N40°E - 88.42'; Power Pole - S56°E - 55.50'; Cherry, 9" - N23°W - 30.66'.

B. Description of corner evidence found and/or method applied in restoring or reestablishing corner:

We recovered a 5/8" x 24" Iron Rod in the centerline of a County Road running East - West and matching long standing lines of occupation. We also found the 3 ties described in LCRC No. 846 (see part A above) which fit the existing iron. This corner position fits well with measurements to corners 1/2 mile East and 1/2 mile West, as well as the 1/16 fences 1/4 mile East and West, and is accepted as the best available evidence of the position of the original corner.

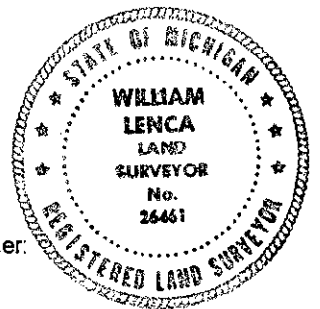

C. Description of monument for corner and accessories established to perpetuate locating the position of the corner:

Set 5/8" x 24" Iron Rod/3-1/4" dia. Alum. cap stamped for corner location:

- |   |       |            |
|---|-------|------------|
| SW Corner Concrete Block Barn                                 | N40°E | 88.47 feet |
| 5/8" x 24" Iron Rod/2" dia. Alum. cap marked "WITNESS MARKER" | S51°E | 54.18 feet |
| 5/8" x 24" Iron Rod/2" dia. Alum. cap marked "WITNESS MARKER" | South | 27.03 feet |
| 5/8" x 24" Iron Rod/2" dia. Alum. cap marked "WITNESS MARKER" | N20°W | 30.47 feet |
| Metal Survey Sign Post  | South | 27.8 feet  |

NOTE: All bearings are magnetic bearings. All distances are measured with steel tape. Distances to trees are to nail in side of tree.

Signed by William Lenca  
26461  
Surveyor's Michigan License No. \_\_\_\_\_

Date July 9, 1999