

SURVEY & REMONUMENTATION

MAR 29 2000

SECTION

LAND CORNER RECORDATION CERTIFICATE
Filing Requirement of Act 74, Mich. P.A. 1970

Approved by Menominee County
Land Survey Remonumentation
Peer Group Under Act 345 Of
P.A. Of 1990 On 12/28, 1999
Mike Davis 265
Chairman

For corners in
MENOMINEE

Located In: Corner Code #

1. Public Land Survey		<u>F</u> 38N <u>R</u> 28W	<u>F-09</u>
		T R	
		T R	
		T R	
2. Property Controlling in Section	S	T R	
	S	T R	
3. Miscellaneous Property in Sec.	S	T R	
	S	T R	

BX. 6 Pg. 37
RECEIVED FOR RECORD
28 DEC 1999 3:56:09 PM
BARBARA MORRISON
REGISTER OF DEEDS
MENOMINEE, MI 49858

Register of Deeds Stamp & File Number

4. Lot No. _____, Recorded Plat _____
5. Private Claims _____

I, William Lenca, in a field survey on Apr., 1999 do hereby state that under requirements of P.A. 74, Michigan P.A. of 1970, the corner points mentioned in lines 1 and 2 above were in conformance with regulations and rules therefore as required in the current manual of survey instructions of the United States Department of the Interior, Bureau of Land Management or by a decree of a Court of Law and/or that the corner points mentioned in lines 3, 4 and 5 above were in conformance with the rules of the Michigan Board of Land Surveyors or by a Decree of a Court of Law; established, re-established, monumented, recovered, found as expressed below:

NOTE: Not more than 2 corners, all in the same town and range, may be recorded on this certificate.

A	B	C	D	E	F	G	H	I	J	K	L	M
1												
2	6		5		4		3		2		1	
3												
4	7		8		9		10		11		12	
5												
6	18		17		16		15		14		13	
7												
8	19		20		21		22		23		24	
9												
10	30		29		28		27		26		25	
11												
12	31		32		33		34		35		36	
13												

A. Description of original monument and accessories and/or subsequent restoration:

- 1849: Original Survey by James H. Mullett - B.T.'s - W. Pine, 10" - N20°W - 16 lks.; Cedar, 12" - S52°E - 15 lks. All original evidence for this corner has been destroyed by county road improvements.
- 1937: Survey Map by Hearl R. Hall, Surveyor, & J.A. Dinsmore, Reg. Engineer, states "Set Gas Pipe at intersection of fences". This map is in the possession of Dan Deacon, Twp. Supervisor & owner of land surveyed.

B. Description of corner evidence found and/or method applied in restoring or reestablishing corner:

We searched at the intersection of ancient fences running West and South and recovered a 1 inch x 18 inch Gas Pipe as described in the 1937 Survey noted in part "A" above. Our measurement from this corner to the Section Corner 1/2 mile East is 2606.73 feet compared to the 1937 record measurement of 2608 feet. Our measurement from this corner to the Section Corner 1/2 mile West is 2618.55 feet compared to the 1937 record measurement of 2619.8 feet. We accepted the location of the existing Gas Pipe as the best available evidence of the position of the original corner.

C. Description of monument for corner and accessories established to perpetuate locating the position of the corner:

Set 2" dia. Aluminum Pipe 30" long/3-1/4" dia. Alum cap stamped for corner location:

20" dia. Willow	N50°E	36.91 feet	Scr. NBT
5/8" x 24" Iron Rod/2" dia. Alum. cap marked "WITNESS MARKER"	S45°E	42.41 feet	1' North of Tel. Box
5/8" x 24" Iron Rod/2" dia. Alum. cap marked "WITNESS MARKER"	N60°W	94.09 feet	1' E. of 9" dia. Apple
Metal Survey Sign Post	S60°W	3.62 feet	

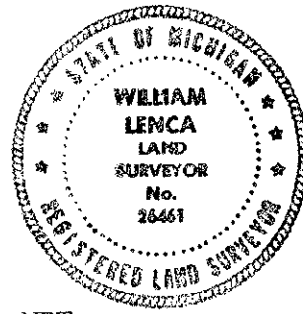

NOTE: All bearings are magnetic bearings. All distances are measured with steel tape. Distances to trees are to nail in side of tree.

Signed by William Lenca 26461
Surveyor's Michigan License No. _____

Date Dec. 18, 1999