

APR 06 1998

Approved by Menominee County
Land Survey Reamunentation
Peer Group Under Act 345 Of
P.A. Of 1990 On 12/30 1998
Mac Davis PLS
Chairman

LAND CORNER RECORDATION CERTIFICATE
Filing Requirement of Act 74, Mich. P.A. 1970

SECTION
For corners in

| | | |
|---------------------------------------|-------------------|---------------|
| <u>MENOMINEE</u> (County) | Located In: | Corner Code # |
| 1. Public Land Survey | <u>T38N R 28W</u> | <u>G-11</u> |
| | T ___ R ___ | _____ |
| | T ___ R ___ | _____ |
| | T ___ R ___ | _____ |
| 2. Property Controlling in Section | S ___ T ___ R ___ | _____ |
| | S ___ T ___ R ___ | _____ |
| 3. Miscellaneous Property In Sec. | S ___ T ___ R ___ | _____ |
| | S ___ T ___ R ___ | _____ |

RECEIVED FOR RECORD
99 JAN - 6 AM 8:56
PAGE # 733 BK 5
BARBARA MORRISON
REGISTER OF DEEDS
MENOMINEE, MI 49858

Register of Deeds Stamp & File Number

4. Lot No. _____, Recorded Plat _____
5. Private Claims _____

I, William Lenca, in a field survey on Feb. 12, 1998 do hereby state that under requirements of P.A. 74, Michigan P.A. of 1970, the corner points mentioned in lines 1 and 2 above were in conformance with regulations and rules therefore as required in the current manual of survey instructions of the United States Department of the Interior, Bureau of Land Management or by a decree of a Court of Law and/or that the corner points mentioned in lines 3, 4 and 5 above were in conformance with the rules of the Michigan Board of Land Surveyors or by a Decree of a Court of Law; established, re-established, monumented, recovered, found as expressed below:

NOTE: Not more than 2 corners, all in the same town and range, may be recorded on this certificate.

| A | B | C | D | E | F | G | H | I | J | K | L | M |
|----|----|---|----|---|----|---|----|---|----|---|----|---|
| 1 | | | | | | | | | | | | |
| 2 | 6 | | 5 | | 4 | | 3 | | 2 | | 1 | |
| 3 | | | | | | | | | | | | |
| 4 | 7 | | 8 | | 9 | | 10 | | 11 | | 12 | |
| 5 | | | | | | | | | | | | |
| 6 | 18 | | 17 | | 16 | | 15 | | 14 | | 13 | |
| 7 | | | | | | | | | | | | |
| 8 | 19 | | 20 | | 21 | | 22 | | 23 | | 24 | |
| 9 | | | | | | | | | | | | |
| 10 | 30 | | 29 | | 28 | | 27 | | 26 | | 25 | |
| 11 | | | | | | | | | | | | |
| 12 | 31 | | 32 | | 33 | | 34 | | 35 | | 36 | |
| 13 | | | | | | | | | | | | |

A. Description of original monument and accessories and/or subsequent restoration:

1849: Original Survey by James H. Mullett - B.T.'s - Tamarack, 16" - S42°W - 31 lks.; Tamarack, 12" - S06°E - 25 lks. All original evidence for this corner has been destroyed by County Road improvements.

B. Description of corner evidence found and/or method applied in restoring or reestablishing corner:

This corner was re-set in the centerline of an East - West County Road and at a proportional position between the S1/4 Corner of Section 28 and the S1/4 Corner of Section 27, T38N-R28W. Measurement for 1/2 mile East = 2614.42 feet (GLO = 2642' feet). Measurement for 1/2 mile West = 2611.12 feet (GLO = 2638.7 feet). We accepted this location as a careful and faithful reestablishment of the position of the original corner.

C. Description of monument for corner and accessories established to perpetuate locating the position of the corner:

Set 5/8" x 24" Iron Rod/3-1/4" dia. Alum. cap stamped for corner location in Monument Box:

| | | | |
|------------------------|-------|-------------|----------|
| 12" dia. Tamarack | N42°E | 90.44 feet | Scr. NBT |
| 9" dia. Cedar | S34°E | 85.25 feet | Scr. NBT |
| 8" dia. Cedar | S50°W | 58.46 feet | Scr. NBT |
| 11" dia. Tamarack | N25°W | 100.15 feet | Scr. NBT |
| Metal Survey Sign Post | South | 31.7 feet | |

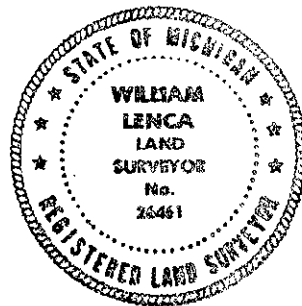

NOTE: All bearings are magnetic bearings. All distances are measured with steel tape. Distances to trees are to nail in side of tree.

Signed by William Lenca
Surveyor's Michigan License No. 26461

Date Dec. 23, 1998

733