

APR 06 1999

SECTION

LAND CORNER RECORDATION CERTIFICATE  
Filing Requirement of Act 74, Mich. P.A. 1970

Approved by Menominee County  
Land Survey Remonumentation  
Peer Group Under Act 345 Of  
P.A. Of 1990 On 12/30 1998  
M. Davis RLS  
PAGE # 737 JKS  
RECEIVED FOR RECORD  
JAN - 6 AM 8:56  
BARBARA MORRISON  
REGISTER OF DEEDS  
MENOMINEE, MI 49858  
Register of Deeds Stamp & File Number

For corners in

MENOMINEE (County)	Located In:	Corner Code #
1. Public Land Survey	T38NR 28W	I-08
	T___ R___	_____
	T___ R___	_____
	T___ R___	_____
2. Property Controlling in Section	S___ T___ R___	_____
	S___ T___ R___	_____
3. Miscellaneous Property in Sec.	S___ T___ R___	_____
	S___ T___ R___	_____

4. Lot No. \_\_\_\_\_, Recorded Plat \_\_\_\_\_  
5. Private Claims \_\_\_\_\_

I, William Lenca, in a field survey on Mar. 06, 19 98 do hereby state that under requirements of P.A. 74, Michigan P.A. of 1970, the corner points mentioned in lines 1 and 2 above were in conformance with regulations and rules therefore as required in the current manual of survey instructions of the United States Department of the Interior, Bureau of Land Management or by a decree of a Court of Law and /or that the corner points mentioned in lines 3, 4 and 5 above were in conformance with the rules of the Michigan Board of Land Surveyors or by a Decree of a Court of Law; established, re-established, monumented, recovered, found as expressed below:

NOTE: Not more than 2 corners, all in the same town and range, may be recorded on this certificate.

	A	B	C	D	E	F	G	H	I	J	K	L	M
1													
2		6		5		4		3		2		1	
3													
4		7		8		9		10		11		12	
5													
6		18		17		16		15		14		13	
7													
8		19		20		21		22		23		24	
9													
10		30		29		28		27		26		25	
11													
12		31		32		33		34		35		36	
13													

A. Description of original monument and accessories and/or subsequent restoration:

- 1849: Original Survey by James H. Mullett - B.T.'s - Cedar, 10" - N45°E - 08 lks.; Cedar, 10" - S72°W - 31 lks. All original evidence for this corner has been destroyed by logging activities.
- 1964: L.C.R.C. Number 514 by Neal Sperhake, RLS 7876, states he set a Galvanized Iron Pipe, 3 feet long, 1" in diameter, with Aluminum Cap denoted as, "KIMBERLY-CLARK CORP. T38N 1/4 BTWN. 22 & 23 R28W SPERHAKE RLS 7876 10-2-64." on a straight line between the Northeast Corner and the Southeast Corner of Section 22, T38N - R28W, and in line with an ancient fence running East and West. TIES: Cedar, 9" - N59°W - 21.5 lks.; Tamarack, 5" - N15°E - 33 lks.

B. Description of corner evidence found and/or method applied in restoring or reestablishing corner:

We found a 1" Iron Pipe with a 4 inch Aluminum Cap marked "KIMBERLY - CLARK CORP. - SPERHAKE - RLS 7876 - 10/2/64" in an old East - West fence as indicated in Land Corner Recordation Certificate Number 514. This corner has been accepted by local residents and surveyors for 34 years, and is accepted as the best available evidence of the position of the original corner.

C. Description of monument for corner and accessories established to perpetuate locating the position of the corner:

Accepted existing 1" Iron Pipe/4" dia. Alum. cap stamped for corner location:

14" dia. Cedar	N39°E	22.20 feet	Scr. NBT
5" dia. Spruce	South	17.16 feet	Scr. NBT
12" dia. Cedar (Ex. B.T.)	N65°W	14.07 feet	
Metal Survey Sign Post	East	1.4 feet	

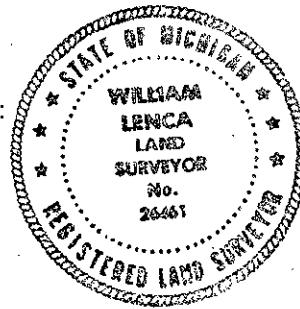

NOTE: All bearings are magnetic bearings. All distances are measured with steel tape. Distances to trees are to nail in side of tree.

Signed by William Lenca Date Dec. 23, 1998  
Surveyor's Michigan License No. 26461