

SURVEY & REMONUMENTATION

JAN 09 2001

SECTION

LAND CORNER RECORDATION CERTIFICATE
Filing Requirement of Act 74, Mich. P.A. 1970

Approved by Menominee County
Land Survey Remonumentation
Peer Group Under Act 345 of
P.A. Of 1990 On 12/22, 2000
Mez Davis PCS
Chairman

For corners in
MENOMINEE

(County)

Located In: Corner Code #

1. Public Land Survey	T <u>39</u> N	R <u>25</u> W	G-10
	T	R	
	T	R	
	T	R	
2. Property Controlling in Section	S	T	R
	S	T	R
3. Miscellaneous Property in Sec.	S	T	R
	S	T	R

Bk. 6 Pg. 220

RECEIVED FOR RECORD
28 DEC 2000 2:31:31 PM
BARBARA MORRISON
REGISTER OF DEEDS
MENOMINEE, MI 49858

Register of Deeds Stamp & File Number

4. Lot No. _____, Recorded Plat _____
5. Private Claims _____

A	B	C	D	E	F	G	H	I	J	K	L
1											
2	6		5		4		3		2		1
3											
4	7		8		9		10		11		12
5											
6	18		17		16		15		14		13
7											
8	19		20		21		22		23		24
9											
10	30		29		28		27		26		25
11											
12	31		32		33		34		35		36
13											

I, William Lenca, in a field survey on Aug. 14, 1900 do hereby state that under requirements of P.A. 74, Michigan P.A. of 1970, the corner points mentioned in lines 1 and 2 above were in conformance with regulations and rules therefore as required in the current manual of survey instructions of the United States Department of the Interior, Bureau of Land Management or by a decree of a Court of Law and /or that the corner points mentioned in lines 3, 4 and 5 above were in conformance with the rules of the Michigan Board of Land Surveyors or by a Decree of a Court of Law; established, re-established, monumented, recovered, found as expressed below:

NOTE: Not more than 2 corners, all in the same town and range, may be recorded on this certificate.

A. Description of original monument and accessories and/or subsequent restoration:

1848: Original Survey by George E. Adair - B.T.'s - Hemlock, 26" - S70°W - 37lks.; Lynn, 28" - N35°E - 35 lks. All original evidence for this corner has been destroyed by logging activities.

B. Description of corner evidence found and/or method applied in restoring or reestablishing corner:

The NW Corner and SW Corner of Section 27 have been previously established. We calculated the single proportional location for the W1/4 Corner, traversed in to this location and searched the area. There was evidence of Hemlock stumps in the area, but they were too decayed to identify as originals. We found an old jack stand driven into the ground 5.1 feet East of the calculated position, but were unable to determine the origin of this monument. The distance between the SW and NW Corners of Section 27 is 5207 feet compared to the GLO distance of 5210 feet. We accepted the single proportional location as a careful and faithful reestablishment of the position of the original corner.

C. Description of monument for corner and accessories established to perpetuate locating the position of the corner:

Set 3/4" dia. x 4' long aluminum rod/3-1/4" dia. Alum. cap stamped for corner.

9" dia. Hard Maple	N37°E	27.37 feet	Scr. NBT
8" dia. Hard Maple	S53°E	14.78 feet	Scr. NBT
8" dia. Basswood	S41°W	13.90 feet	Scr. NBT
8" dia. Hard Maple	N86°W	6.25 feet	Scr. NBT
Metal Survey Sign Post	South	1.35 feet	

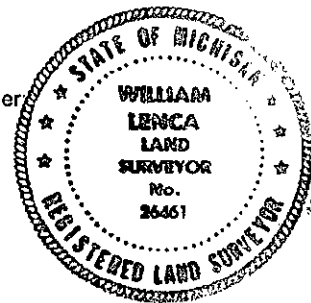

NOTE: All bearings are magnetic bearings. All distances are measured with steel tape. Distances to trees are to nail in side of tree.

Signed by William Lenca
Surveyor's Michigan License No. 26461

Date Aug. 19, 2000