

**SURVEY & REMONUMENTATION**

**JAN 09 2001**

**SECTION**

**LAND CORNER RECORDATION CERTIFICATE**  
Filing Requirement of Act 74, Mich. P.A. 1970

Approved by Menominee County  
Land Survey Remonumentation  
Peer Group Under Act 345 of  
P.A. Of 1990 On 12/22, 2000  
Mac Avon PLS  
Chairman

*BR. 6 Pg. 221*

RECEIVED FOR RECORD  
28 DEC 2000 2:31:31 PM  
BARBARA MORRISON  
REGISTER OF DEEDS  
MENOMINEE, MI 49858

Register of Deeds Stamp & File Number

For corners in  
MENOMINEE  
(County)

Located In:	Corner Code #
T <u>39</u> N R <u>25</u> W	H-09
T___R___	_____
T___R___	_____
T___R___	_____
T___R___	_____
S___T___R___	_____
S___T___R___	_____
S___T___R___	_____
S___T___R___	_____

- Public Land Survey
- Property Controlling in Section
- Miscellaneous Property in Sec.

4. Lot No. \_\_\_\_\_, Recorded Plat \_\_\_\_\_  
5. Private Claims \_\_\_\_\_

I, William Lenca, in a field survey on Aug. 14, 1900 do hereby state that under requirements of P.A. 74, Michigan P.A. of 1970, the corner points mentioned in lines 1 and 2 above were in conformance with regulations and rules therefore as required in the current manual of survey instructions of the United States Department of the Interior, Bureau of Land Management or by a decree of a Court of Law and /or that the corner points mentioned in lines 3, 4 and 5 above were in conformance with the rules of the Michigan Board of Land Surveyors or by a Decree of a Court of Law; established, re-established, monumented, recovered, found as expressed below:

NOTE: Not more than 2 corners, all in the same town and range, may be recorded on this certificate.

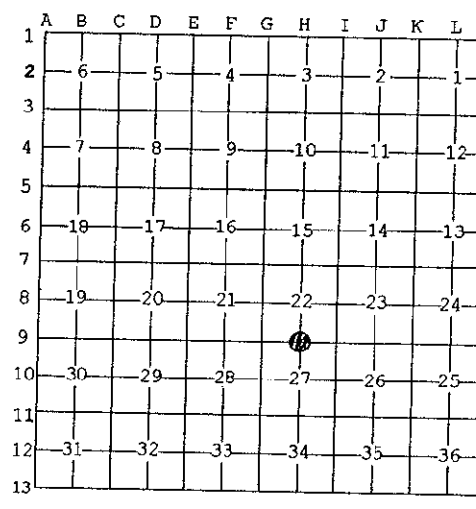

**A. Description of original monument and accessories and/or subsequent restoration:**

1848: Original Survey by George E. Adair - B.T.'s - Y. Birch, 6" - N42.5°W - 07lks.; Cedar, 8" - S28°E - 14 lks. All original evidence for this corner has been destroyed by logging activities.

**B. Description of corner evidence found and/or method applied in restoring or reestablishing corner:**

The NW Corner and NE Corner of Section 27 have been previously established. We calculated the single proportional location for the N1/4 Corner, traversed in to this location and searched the area. We found a 2 inch diameter iron pipe extending about 4 feet above ground N12°E, 19.3 feet from the computed position, but were unable to determine the origin of this monument. The distance between the NE and NW Corners of Section 27 is 5265 feet compared to the GLO distance of 5280 feet. We accepted the single proportional location as a careful and faithful reestablishment of the position of the original corner.

**C. Description of monument for corner and accessories established to perpetuate locating the position of the corner:**

Set 2" dia. Aluminum Pipe 30" long/3-1/4" dia. Alum cap stamped for corner location:

10" dia. Cedar	N72°E	21.89 feet	Scr. NBT
10" dia. Cedar	S05°E	15.25 feet	Scr. NBT
5" dia. Elm	S67°W	21.36 feet	Scr. NBT
12" dia. Maple	N13°W	49.19 feet	Scr. NBT
Metal Survey Sign Post	North	0.9 feet	

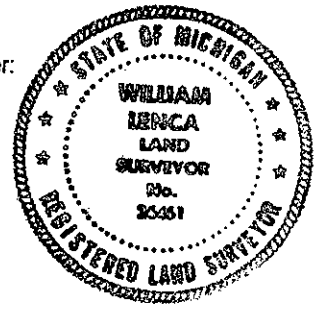

NOTE: All bearings are magnetic bearings. All distances are measured with steel tape. Distances to trees are to nail in side of tree.

Signed by William Lenca  
Surveyor's Michigan License No. 26461

Date Aug. 19, 2000

*221*