

# SURVEY & REMONUMENTATION

APR 24 1995

## COMMISSION

### LAND CORNER RECORDATION CERTIFICATE Filing Requirement of Act 74, Mich. P.A. 1970

Approved by Menominee County  
Land Survey Remonumentation  
Peer Group Under Act 345 Of

P.A. Of 1990 On DEC 16 1994  
MEZAVUKI RLS  
16926 Chairman

For corners in

MENOMINEE

(County)

Located in:

Corner Code #

1. Public Land Survey	T	<u>39NR</u>	<u>26W</u>	<u>E-09</u>
	T	_____	_____	_____
	T	_____	_____	_____
	T	_____	_____	_____
2. Property Controlling in Section	S	_____	_____	_____
	S	_____	_____	_____
3. Miscellaneous Property in Sec.	S	_____	_____	_____
	S	_____	_____	_____

4. Lot No. \_\_\_\_\_, Recorded Plat \_\_\_\_\_  
5. Private Claims \_\_\_\_\_

RECEIVED FOR RECORD  
94 DEC 27 AM 10:48  
PAGE # 152 BK # BR 4  
BARBARA MORRISON  
REGISTER OF DEEDS  
MENOMINEE, MI 49858  
Register of Deeds Stamp & File Number

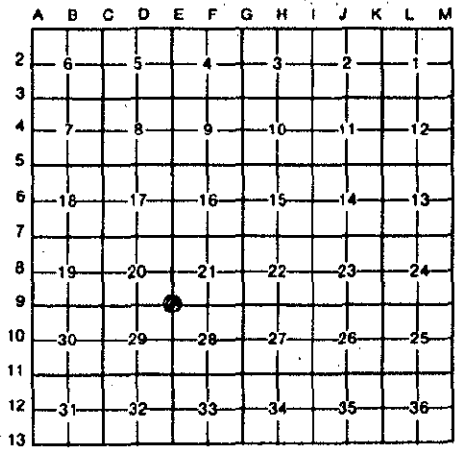

William Lenca

May 18, 1994

I, William Lenca, in a field survey on \_\_\_\_\_, 1994, do hereby certify that under requirements of P.A. 74, Michigan P.A. of 1970, the corner points mentioned in lines 1 and 2 above were in conformance with regulations and rules therefore as required in the current manual of survey instructions of the United States Department of the Interior, Bureau of Land Management or by a decree of a Court of Law and/or that the corner points mentioned in lines 3, 4 and 5 above were in conformance with the rules of the Michigan Board of Land Surveyors or by a Decree of a Court of Law; established, re-established, monumented, re-monumented, recovered, found as expressed below:

**NOTE: Not more than 4 corners, all in the same town and range, may be recorded on this certificate.**

**A. Description of original monument and accessories and/or subsequent restoration:**

- 1852: Original Survey by Harvey Mellen - B.T.'s - Hemlock, 18", S45°E, 2 lks; Hemlock, 20", N58°W, 35 lks. No original evidence for this corner was recovered.  
1981: L.C.R.C. No. 334 by Robert E. Schmeling, RLS No. 8317, states that he set a 1" dia. x 4' iron pipe/brass cap in place of an existing 1-1/2" iron pipe/brass cap badly decayed. He states that the existing monument was placed by Oliver Mining Company employee George Grogan from original B.T.'s - TIES: 6" Aspen - N08°E - 7.6'; 8" Aspen - S15°E - 3.1'; 8" Aspen - N85°W - 5.5'; 6" Aspen - N21°W - 15.3'.

**B. Description of corner evidence found and/or method applied in restoring or reestablishing corner:**

We found a 1" diameter iron pipe/3" diameter brass cap stamped for corner in location indicated by GLO Terrain Calls. The 4 bearing trees described in L.C.R.C. No. 334 still exist and check with corner location. The corner position also fits well with GLO Terrain calls to swamp edges 5 chains North and 2.16 chains East. This corner has been accepted and used as the corner position for many years. Since there is record evidence that this corner was replaced from original bearing trees, we accepted the corner location as a careful and faithful perpetuation of the position of the original corner.

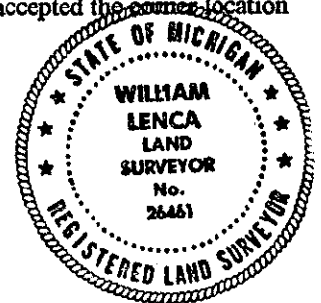

**C. Description of monument for corner and accessories established to perpetuate locating the position of the corner:**

Accepted existing 1" dia. Iron Pipe/3" dia. Brass cap stamped for corner:

8" dia. Balsam	Scr. NBT	N27°E	15.14 feet
9" dia. Balsam	Scr. NBT	N75°E	47.00 feet
5/8" x 24" Iron Rod/2" Alum. cap - WITNESS MARKER		S13°W	2.91 feet
9" dia. Balsam	Scr. NBT	N79°W	25.09 feet

NOTE: All bearings are magnetic bearings. All distances are measured with steel tape. Distances to trees are to nail in side of tree.

Signed by William Lenca Date May 19, 1994  
Surveyor's Michigan License No. 26461

152