

SURVEY & REMONUMENTATION

JUN 23 1994

COMMISSION

For corners in
MENOMINEE

(County)

LAND CORNER RECORDATION CERTIFICATE
Filing Requirement of Act 74, Mich. P.A. 1970

Approved by Menominee County
Land Survey Remonumentation
Peer Group Under Act 345 Of

P.A. of 1990 On 5/18 1994

McL. Atkins
Chairman

RECEIVED FOR RECORD
91 MAY 20 PM 3:32
PAGE # 78 BK. 4
BARBARA MORRISON
REGISTER OF DEEDS
MENOMINEE, MI 49858

Register of Deeds Stamp & File Number

	Located In:	Corner Code #
1. Public Land Survey	T <u>39N</u> R <u>26W</u>	<u>G-10</u>
	T _____ R _____	_____
	T _____ R _____	_____
	T _____ R _____	_____
2. Property Controlling in Section	S _____ T _____ R _____	_____
	S _____ T _____ R _____	_____
3. Miscellaneous Property in Sec.	S _____ T _____ R _____	_____
	S _____ T _____ R _____	_____
4. Lot No. _____, Recorded Plat _____		
5. Private Claims _____		

	A	B	C	D	E	F	G	H	I	J	K	L	M
2	6		5		4		3		2		1		
3													
4	7		8		9		10		11		12		
5													
6	18		17		16		15		14		13		
7													
8	19		20		21		22		23		24		
9													
10	30		29		28		27		26		25		
11													
12	31		32		33		34		35		36		
13													

I, William Lenca, in a field survey on May 9, 1994, do hereby certify that under requirements of P.A. 74, Michigan P.A. of 1970, the corner points mentioned in lines 1 and 2 above were in conformance with regulations and rules therefore as required in the current manual of survey instructions of the United States Department of the Interior, Bureau of Land Management or by a decree of a Court of Law and/or that the corner points mentioned in lines 3, 4 and 5 above were in conformance with the rules of the Michigan Board of Land Surveyors or by a Decree of a Court of Law; established, re-established, monumented, re-monumented, recovered, found as expressed below:

NOTE: Not more than 4 corners, all in the same town and range, may be recorded on this certificate.

A. Description of original monument and accessories and/or subsequent restoration:

1852 - Original Survey by Harvey Mellen - B.T.'s - Sugar, 10", S73°E, 20 lks; Hemlock, 20", N61°W, 17 lks. No evidence of the Original B.T.'s was found. This area has been bulldozed.

B. Description of corner evidence found and/or method applied in restoring or reestablishing corner:

We established this corner position on line and midway between the Northeast Corner and the Southeast Corner of Section 28, T39N-R26W, as indicated in the GLO field notes. The GLO record distances to these corners is 2584.2 feet (39.15-1/2 chains). We measured these distances at 2587.46 feet. This location was accepted as a careful and faithful reestablishment of the position of the original corner.

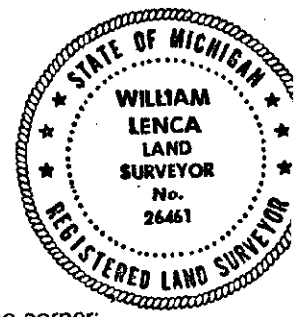

C. Description of monument for corner and accessories established to perpetuate locating the position of the corner:

Set 5/8" Aluminum Rod 3' long/3-1/4" dia. Alum. cap stamped for corner:

10" dia. Maple	Scr. NBT	N29°E	16.01 feet
16" dia. Maple	Scr. NBT	S77°E	42.00 feet
7" dia. Maple	Scr. NBT	S31°E	80.17 feet
8" dia. Maple	Scr. NBT	S28°W	54.73 feet
Carsonite Marker		North	2.0 feet

NOTE: All bearings are magnetic bearings. All distances are measured with steel tape. Distances to trees are to nail in side of tree.

Signed by William Lenca Date May 19, 1994
Surveyor's Michigan License No. 26461