

MICHIGAN
DEPARTMENT OF CONSERVATION
FORESTRY DIVISION

LAND CORNER RECORD

T. 21 N.R. 5 W

Missaukee COUNTY

DESCRIPTION OF CORNER Section corner common to Sections 23-24-25-26

CORNER MONUMENT Set 1" pipe with aluminum cap below surface

DATE MONUMENT PLACED AND WITNESSED 6-28-67

WITNESSES TO CORNER.....

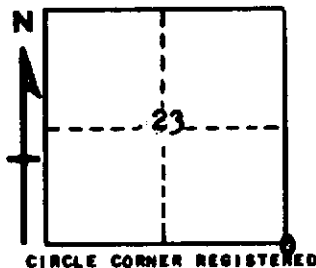

8" J. Pine	N 67 E	36.8'
12" Oak	S 70 E	33.6'
7" J. Pine	N 61 W	14.6'

AND

DESCRIPTION IN DETAIL AS TO HOW CORNER WAS LOCATED AND IDENTIFIED OR RESTORED.

This corner was found during a retracement in this township. Recovered very old stake point at edge of road, as established in old county survey, I believe by McBain. Found corner from McBain witnesses, the SE Oak still in place. Checks measurements north and west.

SURVEYOR'S SEAL

SIGNED Kenneth J. Ostling DATE 6-29-67
REGISTERED LAND SURVEYOR #10068