

MICHIGAN  
DEPARTMENT OF CONSERVATION  
FORESTRY DIVISION

✓  
**LAND CORNER RECORD**

T. 21 N.R. 5 W

Missaukee COUNTY

DESCRIPTION OF CORNER Section corner common to Sections 22-23-26-27

CORNER MONUMENT Set Cons. Dept. Mon.

DATE MONUMENT PLACED AND WITNESSED 10/5/67

WITNESSES TO CORNER.....

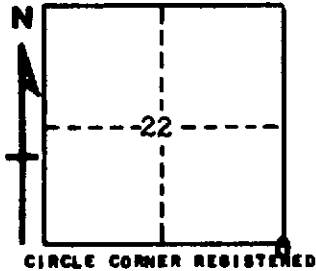

15" Oak S 68 W 12.2'

14" Oak S 02 E 16.7'

AND

DESCRIPTION IN DETAIL AS TO HOW CORNER WAS LOCATED AND IDENTIFIED OR RESTORED.

This corner was found during a survey in this area. Found pipe as established in early survey by Marcus Schaaf. Possible B.T. stumps in place, and appears to fit other corners in this area.

SURVEYOR'S SEAL

SIGNED Kenneth Ostling DATE 11/20/67  
REGISTERED LAND SURVEYOR #10068