

MICHIGAN
DEPARTMENT OF CONSERVATION
FORESTRY DIVISION

✓ **LAND CORNER RECORD**

T. 22 N. R. 5 W

Missaukee COUNTY

DESCRIPTION OF CORNER Section corner common to Sections 25-26-35-36

CORNER MONUMENT Set Cons. Dept. Mon.

DATE MONUMENT PLACED AND WITNESSED 11/16/67

WITNESSES TO CORNER.....

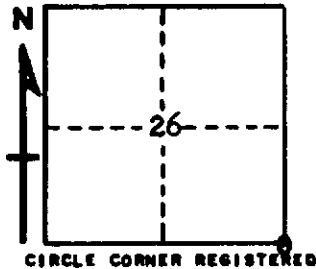

7# J. Pine S 67 W 34.6'

16" W. Pine stp N 49 E 47.0'

AND

DESCRIPTION IN DETAIL AS TO HOW CORNER WAS LOCATED AND IDENTIFIED OR RESTORED.

This corner was restored during a survey in this area. Set corner on line over 1/4 and section corner east, at proportionate measurement for longitude. This appears to conform to the 1909 Beuthein survey, although no corner monument could be found in swampy land.

SURVEYOR'S SEAL

SIGNED *Levith Heston* DATE 11/20/67
REGISTERED LAND SURVEYOR #10068