

MICHIGAN
DEPARTMENT OF CONSERVATION
FORESTRY DIVISION

LAND CORNER RECORD

T. 24 N.R. 7 W

Missaukee COUNTY

DESCRIPTION OF CORNER Sec. corner common to sections 5-6-7-8

CORNER MONUMENT Set 1" pipe with 4" Aluminum cap

DATE MONUMENT PLACED AND WITNESSED June 23, 1966

WITNESSES TO CORNER.....

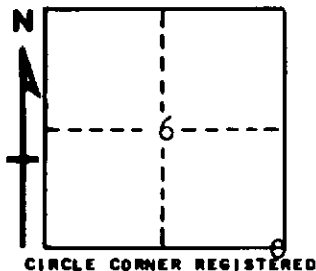

CIRCLE CORNER REGISTERED

12" B. Oak S 71 W 52.3'

10" B. Oak N 58 E 59.7'

AND

DESCRIPTION IN DETAIL AS TO HOW CORNER WAS LOCATED AND IDENTIFIED OR RESTORED.

This corner was set by single proportionate measurement between good corners one-half mile south and one mile north. Could not locate a previous corner, but feel this is in accord with other good corners in this area.

SURVEYOR'S SEAL

SIGNED Kenneth J. Ostling DATE June 24, 1966
REGISTERED LAND SURVEYOR #10088