

Montmorency County Remonumentation

Libor 12 Page 47

LAND CORNER RECORDATION CERTIFICATE
Filing Requirement of Act 74, Mich. P.A. 1970

For corners in

<u>Montmorency</u> (County)	Located In:	Corner Code #
1. Public Land Survey	T <u>29N</u> R <u>1E</u>	<u>A-10</u>
	T _____ R _____	_____
	T _____ R _____	_____
	T _____ R _____	_____
2. Property Controlling in Section	S _____ T _____ R _____	_____
	S _____ T _____ R _____	_____
3. Miscellaneous Property in Sec.	S _____ T _____ R _____	_____
	S _____ T _____ R _____	_____

RECEIVED
MONTMORENCY COUNTY
REGISTER OF DEEDS
DEC 28 9 05 AM '93
A. PARSONS-MCELROY

Register of Deeds Stamp & File Number

4. Lot No. _____, Recorded Plat _____
5. Private Claims _____

	A	B	C	D	E	F	G	H	I	J	K	L	M
2	6		5		4		3		2		1		
3													
4	7		8		9		10		11		12		
5													
6	18		17		16		15		14		13		
7													
8	19		20		21		22		23		24		
9													
10	30		29		28		27		26		25		
11													
12	31		32		33		34		35		36		
13													

I, Larry G. Beauregard in a field survey on May, 19 93, do hereby certify that under requirements of P.A. 74, Michigan P.A. of 1970, the corner points mentioned in lines 1 and 2 above were in conformance with regulations and rules therefore as required in the current manual of survey instructions of the United States Department of the Interior, Bureau of Land Management or by a decree of a Court of Law and/or that the corner points mentioned in lines 3, 4 and 5 above were in conformance with the rules of the Michigan Board of Land Surveyors or by a Decree of a Court of Law; established, re-established, monumented, re-monumented, recovered, found as expressed below:

NOTE: Not more than 4 corners, all in the same town and range, may be recorded on this certificate.

A. Description of original monument and accessories and/or subsequent restoration:

(A-10) ^{GLO} No Post set Corner lies within West Twin Lake. At 42.11' over Lake. A 10" Tamarack marked for Meander Post. G.F. De La Mater P.S. # 693 (Otsego Co. Surveyor) in 1933 fnd. Tamarack stub marked & 1 1/4" gas pipe 18' N. of Cor. M.P.A. Stanley O. Thorsen P.S. #5788 in 1959 set or fnd. MPW while making the recorded Plat of Meridian Bay Shores. Plat Rec. L. 2, of Plat P. 61, Otsego Co. Records. Fred J. King P.S. #25852 in 1982, set a 1/2" bar & cap on the N. Shore of West Twin Lake by extending the W. Bdy. of the Rec. Plat of West Fernwood Beach for a new M.C.N. which based upon his Survey is 225.21' N. of 1/4 Cor. Fred also set a 1/2" bar & cap on the W. Shore of West Twin Lake by extending the N. Bdy. of the Rec. Plat of Meridian Bay Shores along the E. & W. 1/4 line for a M.C.W. which based upon his Survey is 190.95' W. of 1/4 Corner.

B. Description of corner evidence found and/or method applied in restoring or reestablishing corner:

(A-10) No original Meander Post found. Lake has been dredged. Fnd. 1/2" bar & P.S. cap #25852 by King for M.C.W. & N. of Corner. (Re-placed both 1/2" bar & caps with 4" x 36" Conc. Mon's. & Re-Mon. caps #18654)

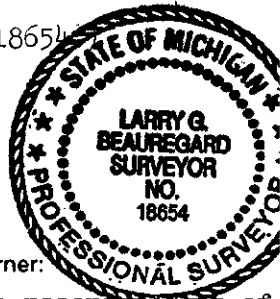

C. Description of monument for corner and accessories established to perpetuate locating the position of the corner:

(A-10) M.C.W. on E. & W. 1/4 line Sec. 25, T29N, R1W, M.C.N. on the W. Bdy. of the recorded Plat of West Fernwood Beach, Sec. 30, T29N, R1E.
I.C.N. & W 4" x 36" Conc. Mon. & Re-Mon. cap #18654. Accepted as the best available evidence of the re-establishment of the theoretical position of the Corner, approved by the Peer Group on September 24, 1993.
I.C.N. Re-Mon Mon. is N 1°-41' E 225.21' of 1/4 Comm. to Sec. 25, T30N, R1W, Sec. 30, T29N, R1E.
I.C.N. N 88° E 9.62' 8" Birch N 40° W 36.81' 12" W. Pine
I.C.N. N 05° W 61.10' 4" W. Pine N 15° E 33.62' Tw. 15" Willows
I.C.W. S 35° W 41.05' 6" Norway S 80° W 21.15' Tw. 12" W. Pine
I.C.W. N 40° W 92.10' SW Cor. of Hse. (Blk) N 60° W 84.10' 3" Norway
 (Placed 20 penny spike & P.S. tag #18654) (typ)

Signed by Larry G. Beauregard Date 12-27-93

Surveyor's Michigan License No. 18654