

FEB 06 1998

Montmorency County Remonumentation

Liber 00012 Page 0284

SECTION

LAND CORNER RECORDATION CERTIFICATE

Filing Requirement of Act 74, Mich. P.A. 1970

For corners in

MONTMORENCY (County)	Located In:	Corner Code #
1. ALBERT TWP. Public Land Survey	T 29N R 1E	H - 3
	T _____ R _____	_____
	T _____ R _____	_____
	T _____ R _____	_____
2. Property Controlling in Section	S _____ T _____ R _____	_____
	S _____ T _____ R _____	_____
3. Miscellaneous Property in Sec.	S _____ T _____ R _____	_____
	S _____ T _____ R _____	_____
4. Lot No. _____, Recorded Plat _____		
5. Private Claims _____		

STATE OF MICHIGAN
MONTMORENCY COUNTY
Recorded & Filed

12-16-1997 10:51:32

A. PANGAN-MCELROY
REGISTER OF DEEDS

Register of Deeds Stamp & File Number

I, DONALD E MARLATT in a field survey on 8/17, 19 97, do hereby certify that under requirements of P.A. 74, Michigan P.A. of 1970, the corner points mentioned in lines 1 and 2 above were in conformance with regulations and rules therefore as required in the current manual of survey instructions of the United States Department of the Interior, Bureau of Land Management or by a decree of a Court of Law and/or that the corner points mentioned in lines 3, 4 and 5 above were in conformance with the rules of the Michigan Board of Land Surveyors or by a Decree of a Court of Law, established, re-established, monumented, re-monumented, recovered, found as expressed below:

	A	B	C	D	E	F	G	H	I	J	K	L	M
2	6	5	4	3	2	1							
3								●					
4	7	8	9	10	11	12							
5													
6	18	17	16	15	14	13							
7													
8	19	20	21	22	23	24							
9													
10	30	29	28	27	26	25							
11													
12	31	32	33	34	35	36							
13													

NOTE: Not more than 4 corners, all in the same town and range, may be recorded on this certificate.

A. Description of original monument and accessories and/or subsequent restoration:
H - 3 1/4 CORNER COMMON TO SEC. 'S 3 & 10.
GLO CORNER SET BY LEWIS CLASON APRIL 1840, SPR. PINE 12"-S53°E-29 L., SPR. PINE 8"-N49°W 32 L. SURVEY BY N.C. CALDWELL 12/31/73. L. 1, P. 503-505. PLACED 1/2" BAR & RLS CAP BY S.P. N48°W 40.9' 14" OAK, S72°E 20.2' 14" OAK, S72°W 46.1' 10" OAK.
ACT 74 BY N.C. CALDWELL 2/26/74. L. 1, P. 91. (SAME COR. & WIT. AS ABOVE).
SURVEY BY F. KING APRIL 29, 1997 L. 3, P. 594. FOUND RECORD CORNER.

B. Description of corner evidence found and/or method applied in restoring or reestablishing corner:
H - 3 1/4 CORNER COMMON TO SEC. 'S 3 & 10.
FOUND 1/2" ROD & CAP #12018
N45°W 20" OAK 41.32' (CALDWELL WIT.)
S75°W 14" OAK 46.18' "
S62°E 17" OAK 20.75' "

APPROVED BY
PEER GROUP

JUN 20 97

J.E.B.

C. Description of monument for corner and accessories established to perpetuate locating the position of the corner:
H - 3 1/4 CORNER COMMON TO SEC. 'S 3 & 10
SET CONC. MONUMENT AND REMON. CAP.
N45°W 20" OAK 41.32'
S75°W 14" OAK 46.18'
S45°W 17" OAK 50.60'
S62°E 17" OAK 20.75'

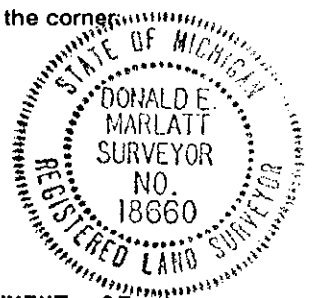

WITNESSES MARKED WITH 40PENNY SPIKES AND P.S. TAGS # 18660.
APPROVED BY PEER GROUP JUNE 20, 1997 as A CAREFUL AND FAITHFUL ESTABLISHMENT OF POSITION OF THE CORNER.

Signed by Donald E Marlatt

Date 12/15/1997

Surveyor's Michigan License No. 18660