

SURVEY & REMONUMENTATION

FEB 06 1998

Montmorency County Remonumentation

Liber **00012** Page **0275**

SECTION

LAND CORNER RECORDATION CERTIFICATE
Filing Requirement of Act 74, Mich. P.A. 1970

For corners in

<u>MONTMORENCY</u> (County)	Located In: ALBERT TWP.	Corner Code #
1. Public Land Survey	T <u>29N</u> R <u>1E</u>	<u>I-5</u>
	T <u> </u> R <u> </u>	<u> </u>
	T <u> </u> R <u> </u>	<u> </u>
	T <u> </u> R <u> </u>	<u> </u>
2. Property Controlling in Section	S <u> </u> T <u> </u> R <u> </u>	<u> </u>
	S <u> </u> T <u> </u> R <u> </u>	<u> </u>
3. Miscellaneous Property in Sec.	S <u> </u> T <u> </u> R <u> </u>	<u> </u>
	S <u> </u> T <u> </u> R <u> </u>	<u> </u>

STATE OF MICHIGAN
MONTMORENCY COUNTY
Recorded & Filed

11-12-1997 09:41:49

A. FANGAN-MCELROY
REGISTER OF DEEDS

Register of Deeds Stamp & File Number

4. Lot No. _____, Recorded Plat _____
5. Private Claims _____

I, FREDERICK J. KING, in a field survey on June 2, 1997 do hereby state that under requirements of P.A. 74, Michigan P.A. of 1970, the corner points mentioned in lines 1 and 2 above were in conformance with regulations and rules therefore as required in the current manual of survey instructions of the United States Department of the Interior, Bureau of Land Management or by a decree of a Court of Law and /or that the corner points mentioned in lines 3, 4 and 5 above were in conformance with the rules of the Michigan Board of Land Surveyors or by a Decree of a Court of Law; established, re-established, monumented, recovered, found as expressed below:

NOTE: Not more than 2 corners, all in the same town and range, may be recorded on this certificate.

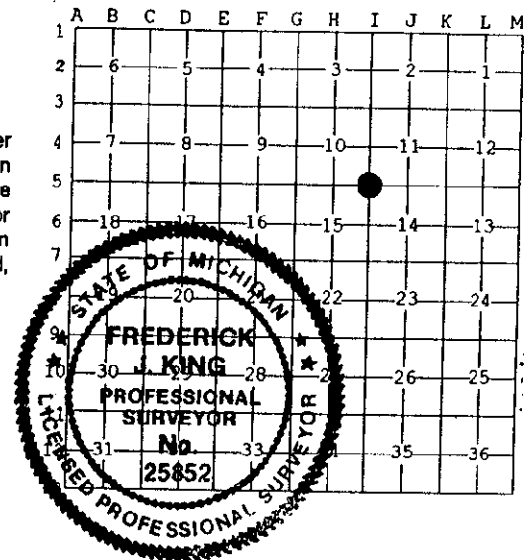

A. Description of original monument and accessories and/or subsequent restoration:

- I-5 - CORNER COMMON TO SECTIONS 10, 11, 14 & 15
- June 1840 - Original Post set by L. Clason, D.S. (Pg362) N74°E-38 1k(25.08')8" Spr Pine * S69°W-47 1k(31.02')10" Spr Pine
- May 1969 - Sec Division N.C. Caldwell, PS #12018 - Fnd 1/2" Bar - N40°W-49.6'-6" J.P. * S45°W-76.5'-18" J.P. Not Recorded N55°W-77.6'-9" J.P.
- Apr 1971 - County Road Plans - Fnd Iron in Pvmt *EAST-40'-Set 1/2" Bar * WEST 40' - SET 1/2" Bar * N40°W-49.6'-6" J.P. Not Recorded S45°W-76.5'-18" R.Pine * N55°E-77.6'-9" J. Pine
- 1973 - Field Notes by N.C. Caldwell, PS #12018 - Not Recorded - Fnd 1/2" Bar - No Wit.
- July 1973 - Act 132 by N.C. Caldwell, PS #12018 L. 1, Pgs 400-403 - Used Corner - No Cor Desc. - No Wit.
- Dec 1973 - Act 132 by N.C. Caldwell, PS #12018 L. 1, Pgs 503-505 - Fnd 1/2" Bar & Cap in Mon Box in C.L. Rd. - No Wit.
- Feb 1974 - Act 74 by N.C. Caldwell, PS #12018 L. 1, Pg. 92 - Fnd 1/2" Bar & Cap in Mon Box in C.L. Pvmt. - No Wit.
- Sept 1980 - Act 132 by L.G. Beauregard, PS #18654 L. 3, Pg. 57 - Fnd 1/2" Bar & Cap in Mon Box - No Wit.
- July 1982 - Act 132 by L.G. Beauregard, PS #18654 L. 3, Pg. 57 - Fnd 1/2" Bar & Cap in Mon Box in C.L. Pvmt * Rec L. 3, Pg. 163
- Feb 1983 - Act 132 by D.E. Marlatt, PS #18660 - Fnd 1/2" Bar & Cap in Mon Box * 1/2" Rods East & West * Rec. L.3, Pg. 294
- June 1983 - Act 132 by D.E. Marlatt, PS #18660 - Fnd 1/2" Bar & Cap in Mon Box * 1/2" Rods East & West * Rec L. 3, Pg. 222
- Nov 1983 - Act 132 by D.E. Marlatt, PS #18660 - Fnd 1/2" Bar & Cap in Mon Box * 1/2" Rods East & West * Not Recorded.
- Jan 1984 - Act 132 by D.E. Marlatt, PS #18660 - Fnd 1/2" Bar & Cap in Mon Box * 1/2" Rods East & West * Not Recorded.
- Aug 1984 - Act 132 by L.G. Beauregard, PS #18654 - 1/2" Bar & Cap in Mon Box - No Wit - Rec, L.3, Pg. 248
- Aug 1984 - Act 132 by L.G. Beauregard, PS #18654 - 1/2" Bar & Cap in Mon Box - No Wit - Rec. L. 3, Pg. 249

B. DESCRIPTION OF CORNER EVIDENCE FOUND AND/OR METHOD APPLIED IN RESTORING OR REESTABLISHING CORNER:

I-5 - CORNER COMMON TO SECTIONS 10, 11, 14 & 15
Found Record 1/2" Iron & ID Cap #12018 in Monument Box in C.L. of N-S B.T. Road (Co Rd. #491)
Record Witnesses Found - (R&M) EAST -(R&M) 40.0' - Fnd Rec 1/2" Iron
(R&M) WEST -(R&M) 40.0' - Fnd Rec 1/2" Iron WEST - 50.0' - DNR Post

This Corner Approved by County Peer Review on June 20, 1997, as the best available evidence of the position of the original corner.

C. Description of monument for corner and accessories established to perpetuate locating the position of the corner:

- I-5 - CORNER COMMON TO SECTIONS 10, 11, 14 & 15
- Placed County Re-Mon Cap on existing 1/2" Iron in existing Mon Box * Corner is in C.L. of N-S B.T. Rd. (Co. Rd. #491)
- N25°E - 92.22' - Set S&T on NW sd of Pwr Pole #LW1-36-3
- EAST - 40.00' - Fnd 1/2" Iron (Co Rd. Plans Wit)
- S60°E - 68.44' - Set S&T on SW corner of 4"x4" Wood Gate Post
- WEST - 40.00' - Fnd 1/2" Iron (Co. Rd. Plans Wit)
- WEST - 40.48' - Set S&T on S side fence corner post.
- WEST - 50.17' - Set S&T on S side of USFS Red Top Post.

**APPROVED BY
PEER GROUP**

JUN 20 97

F.A.B.

Signed by Frederick J. King
Surveyor's Michigan License No. 25852

Date Nov. 6, 1997