

**SURVEY & REMONUMENTATION**

**FEB 06 1998**

**Montmorency County Remonumentation**

Liber **00012** Page **0279**

**SECTION**

**LAND CORNER RECORDATION CERTIFICATE**  
Filing Requirement of Act 74, Mich. P.A. 1970

For corners in

<u>MONTMORENCY</u> (County)	Located In: ALBERT TWP.	Corner Code #
1. Public Land Survey	T <u>29N</u> R <u>1E</u>	<u>1-9</u>
	T <u>   </u> R <u>   </u>	<u>   </u>
	T <u>   </u> R <u>   </u>	<u>   </u>
	T <u>   </u> R <u>   </u>	<u>   </u>
2. Property Controlling in Section	S <u>   </u> T <u>   </u> R <u>   </u>	<u>   </u>
	S <u>   </u> T <u>   </u> R <u>   </u>	<u>   </u>
3. Miscellaneous Property in Sec.	S <u>   </u> T <u>   </u> R <u>   </u>	<u>   </u>
	S <u>   </u> T <u>   </u> R <u>   </u>	<u>   </u>

STATE OF MICHIGAN  
MONTMORENCY COUNTY  
Recorded & Filed

11-12-1997 09:42:23

A. PANGAN-MCELROY  
REGISTER OF DEEDS

Register of Deeds Stamp & File Number

4. Lot No. \_\_\_\_\_, Recorded Plat \_\_\_\_\_  
5. Private Claims \_\_\_\_\_

I, FREDERICK J. KING, in a field survey on June 3, 1997 do hereby state that under requirements of P.A. 74, Michigan P.A. of 1970, the corner points mentioned in lines 1 and 2 above were in conformance with regulations and rules therefore as required in the current manual of survey instructions of the United States Department of the Interior, Bureau of Land Management or by a decree of a Court of Law and/or that the corner points mentioned in lines 3, 4 and 5 above were in conformance with the rules of the Michigan Board of Land Surveyors or by a Decree of a Court of Law; established, re-established, monumented, recovered, found as expressed below:

NOTE: Not more than 2 corners, all in the same town and range, may be recorded on this certificate.

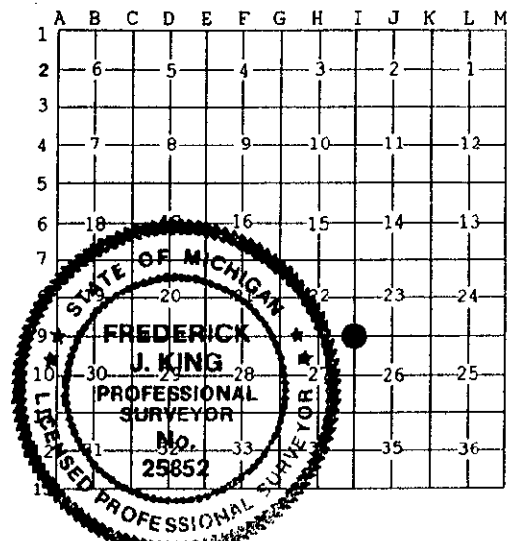

**A. Description of original monument and accessories and/or subsequent restoration:**

- I-9 - CORNER COMMON TO SECTIONS 22, 23, 27 & 28
- June 1840 - Original Post set by L. Clason, D.S. (Pg360) -N35E-13 lks(8.58')7" Spr P. \*S48W-33 lks(21.78')6" Spr Pine
- Date ? - Index Map furnished by D.E. Marlatt, PS #18660, indicates that G.F. DeLaMater, PS #693 & F.N.Smith, PS#754 here.
- Date ? - Field Notes by F.N. Smith, PS#754 - Fnd RR Spk in B.T. -S43W-78.85'-6" B Oak \* S43E-47.35'-Fnc Post N30W-54.93'-T.Pole
- Dec 1956 - "FOREST PARK NO. 1" by F.N. Bateman, PS#1479 - No Cor Desc - No Wit - Rec. L.2, Pg. 10
- June 1961 - "FOREST PARK NO. 2" by F.N. Bateman, PS#1479 - No Cor Desc - No Wit - Rec. L.2, Pg. 34
- July 1966 - Sec Division by G.D. Henning, PS#2240 - Fnd Iron - No Wit - Not Recorded
- 1967 - Field Notes by G.D. Henning, PS#2240 - Fnd Pipe in Road Intersections - No Wit - Not Recorded
- Date ? - Field Notes by N.C. Caldwell, PS#12018 - Fnd 3/4" Pipe in Mon Box \*N45E-53.45'-P Pole \* S25E-77.50'- P. Pole S45W-58.85'-P Pole \* N30W-56.07'-T. Pole
- Aug 1968 - Act 132 by N.C. Caldwell, PS#12018 - No Cor Desc - No Wit - Not Recorded
- June 1971 - Act 132 by N.C. Caldwell, PS#12018 - No Cor Desc - No Wit - Rec. L.1, Pg. 57-58
- Aug 1971 - Act 132 by L.G. Beauregard, PS#18654 - No Cor Desc - No Wit - Rec. L.1, Pg. 111
- Oct 1971 - Act 132 by N.C. Caldwell, PS#12018 - No cor Desc - No wit - Rec. L.1, Pg. 198
- Oct 1971 - Act 132 by N.C. Caldwell, PS#12018 - No Cor Desc - No wit - Rec. L.1, Pg. 509
- Dec 1971 - Act 132 by L.G. Beauregard, PS#18654 - No Cor Desc - No Wit - Rec. L.1, Pg 115
- June 1972 - Act 132 by N.C. Caldwell, PS#12018 - No Cor Desc - No Wit - Rec 0.1, Pg. 215
- Aug 1972 - Act 132 by N.C. Caldwell, PS#12018 - No cor Desc - No Wit - Rec. L.1, Pg. 193
- Sept 1972 - Act 132 by L.G. Beauregard, PS#18654 - No Cor Desc - No Wit - Rec. L.1, Pg. 253
- Aprl 1974 - Act 132 by N.C. Caldwell, PS#12018 - No Cor Desc - No Wit - Rec. L.2, Pg. 9
- Aug 1974 - Act 132 by N.C. Caldwell, PS#12018 - No Cor Desc - No Wit - Rec. L.2, Pg. 5
- Jan 1975 - Act 132 by N.C. Caldwell, PS#12018 - No cor Desc - No Wit - Rec. L.2, Pg. 112
- July 1975 - Act 132 by D.E. Marlatt, PS#18660 - No cor Desc - No wit - Rec. L.2, Pg. 105
- Nov 1975 - Act 132 by N.C. Caldwell, PS#12018 - No Cor Desc - No Wit - Rec.L.2, Pg. 245
- Aprl 1977 - Act 132 by N.C. Caldwell, PS#12018 - No cor Desc - No Wit - Rec. L.2, Pg. 537
- Aprl 1977 - Act 132 by L.G. Beauregard, PS#18654 - No cor Desc - No Wit - Rec. L.2, Pg. 272
- Dec 1992 - Act 132 by F.J. King, PS#25852 - Fnd Pipe in Mon box in C.L. Pmvt. - No Wit - Rec. L.4, Pg. 84

**APPROVED BY PEER GROUP**

JUN 20 97  
*J.L.B.*

**B. Description of corner evidence found and/or method applied in restoring or reestablishing corner:**

I-9 - CORNER COMMON TO SECTIONS 22, 23, 27, & 28  
Found Pipe & Cap (Can't read #) In Mon box in C.L. B.T. Rds - N-S-E-W  
Record Witnesses Found - None of the above Recorded Witnesses Found - Appears to have been removed by New Construction  
(M) S25°E-(M) 77.45' - Fnd Tag #18654 in P. Pole #LW3-2 (No Record Found) (M)S25°W-(M) 58.80' - Fnd Tag #18654 in Light Pole

This Corner Approved by County Peer Review on June 20, 1997, as the best available evidence of the position of the original corner.

**C. Description of monument for corner and accessories established to perpetuate locating the position of the corner:**

I-9 - CORNER COMMON TO SECTIONS 22, 23, 27 & 28 \*\* PLACED COUNTY RE-MON CAP & 1/2" ROD IN FND 3/4" PIPE IN EXISTING MON BOX  
Corner is in C.L. E-W B.T. Rd (Co Rd #612) & in C.L. B.T. Rd to N (Co. Rd. #491) & in C.L. B.T. Rd to S (Co Rd #489)  
N40°E(R-N45°E)-53.40'(R-53.45') Set S&T on NW side of Pwr Pole #CBA-LW4-4-LW3-1 (Caldwell Wit.)  
S25°E-77.45'(R-77.50') - Set S&T above Tag #18654 on NE sd of Pwr Pole #LW3-2 (Caldwell & Beauregard Wit.)  
S25°W(R-S45°W) -58.80'(R-58.85') - Set S&T above Tag #18654 on SE sd Light Pole (Caldwell & Beauregard Wit)  
N20°W-69.75' - Set S&T on SW side Pwr Pole.

Signed by Frederick J. King Date Nov. 6, 1997  
Surveyor's Michigan License No. 25852