

**SURVEY & REMONUMENTATION**

**FEB 06 1998**

**Montmorency County Remonumentation**

Liber **00012** Page **0260**

**SECTION**

**LAND CORNER RECORDATION CERTIFICATE**  
Filing Requirement of Act 74, Mich. P.A. 1970

For corners in

<u>MONTMORENCY</u> (County)	Located In: ALBERT TWP.	Corner Code #
1. Public Land Survey	T <u>29N</u> R <u>1E</u>	<u>J-3</u>
	T _____ R _____	_____
	T _____ R _____	_____
	T _____ R _____	_____
2. Property Controlling in Section	S _____ T _____ R _____	_____
	S _____ T _____ R _____	_____
3. Miscellaneous Property in Sec.	S _____ T _____ R _____	_____
	S _____ T _____ R _____	_____

STATE OF MICHIGAN  
MONTMORENCY COUNTY  
Recorded & Filed

11-12-1997 09:39:26

A. PANGAN-MCELROY  
REGISTER OF DEEDS

Register of Deeds Stamp & File Number

4. Lot No. \_\_\_\_\_, Recorded Plat \_\_\_\_\_  
5. Private Claims \_\_\_\_\_

I, FREDERICK J. KING, in a field survey on June 4, 1997 do hereby state that under requirements of P.A. 74, Michigan P.A. of 1970, the corner points mentioned in lines 1 and 2 above were in conformance with regulations and rules therefore as required in the current manual of survey instructions of the United States Department of the Interior, Bureau of Land Management or by a decree of a Court of Law and/or that the corner points mentioned in lines 3, 4 and 5 above were in conformance with the rules of the Michigan Board of Land Surveyors or by a Decree of a Court of Law; established, re-established, monumented, recovered, found as expressed below:

NOTE: Not more than 2 corners, all in the same town and range, may be recorded on this certificate.

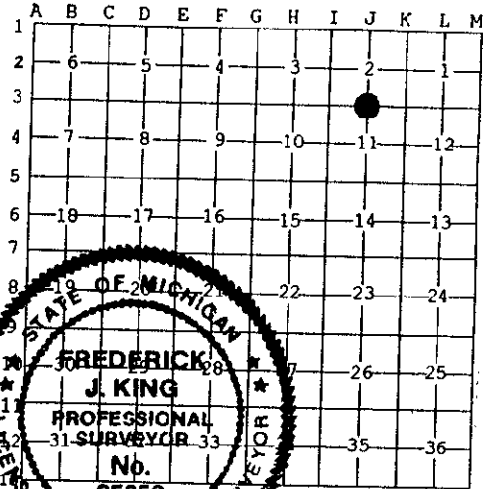

**A. Description of original monument and accessories and/or subsequent restoration:**

J-3 - 1/4 CORNER COMMON TO SECTIONS 2 & 11

- June 1840 - Original Post set by L. Clason, D.S. (Pg. 363) \*N62W-20 lks(13.20')26" J. Pine \*S45E-15 lks(9.90') 22" Hemlock
- Date ? - Index Map furnished by D.E. Marlatt, PS #18660, indicates that F.N. Smith, PS #754, used this corner.
- Date ? - Field Notes by F.N. Smith, PS #754 - Fnd Iron Pipe - N4E -46.5' - 12" W Pine \* S12W -65.3' - 12" B Oak N21E -55.6' - Old Pipe Wit In Stmp -A.M. Rouse, Oct 1934
- Sept 1974 - Act 132 by L.G. Beauregard, PS #18654 - Fnd Rec Mon Set by F.N. Smith, PS #754 \* N39E -42.40'-P. Pole S24E -37.18' - Fnc Cor Post \*NORTH-33.93'- Fnc Cor Post

**B. Description of corner evidence found and/or method applied in restoring or reestablishing corner:**

J-3 - 1/4 CORNER COMMON TO SECTIONS 2 & 11

- Found Record Conc Mon in C.L. Grav Rd E & W (Agren Rd) AND in Line with Fences to N & S
- Record Witnesses Found - (R&M) NORTH - (R) 33.93' (M) 33.8' - Fnc Cor Post (R&M) N39E - (R&M) 42.4' - P. Pole #LW1-48-8

This Corner Approved by County Peer Review on June 20, 1997, as the best available evidence of the position of the Original Corner.

**C. Description of monument for corner and accessories established to perpetuate locating the position of the corner:**

J-3 - 1/4 CORNER COMMON TO SECTIONS 2 & 11

- PLACED COUNTY RE-MON CAP ON FOUND CONC. MONUMENT - Corner is in C.L. of E-W Grav. Rd. (Agren Rd) & in line with Fences N & S
- NORTH -33.93' - Fnd Spk in Fnc Cor Post (L. Beauregard Wit)
- N30°E -42.54' (R-42.4') - Set S&T on NW side of Pwr Pole #LW1-48-8 (L. Beauregard Wit)
- S50°E -27.55' - Set S&T on NE side of E Gate Post to "Pine Hills Hunt Club" Gate
- S45°W -38.69' - Set S&T on NW side of 27" Oak
- N60°W -35.88' - Set S&T on NE side of 8" Maple

**APPROVED BY PEER GROUP**

**JUN 20 97**

*S. H. B.*

Signed by Frederick J. King  
Surveyor's Michigan License No. 25852

Date Nov. 6, 1997