

SURVEY & REMONUMENTATION

FEB 06 1998

Montmorency County Remonumentation

LAND CORNER RECORDATION CERTIFICATE  
Filing Requirement of Act 74, Mich. P.A. 1970

For corners in SECTION

Liber 00012 Page 0261

MONTMORENCY (County)	Located In: ALBERT TWP.	Corner Code #
1. Public Land Survey	T <u>29N</u> R <u>1E</u>	J-5
	T _____ R _____	_____
	T _____ R _____	_____
	T _____ R _____	_____
2. Property Controlling in Section	S _____ T _____ R _____	_____
	S _____ T _____ R _____	_____
3. Miscellaneous Property in Sec.	S _____ T _____ R _____	_____
	S _____ T _____ R _____	_____

STATE OF MICHIGAN  
MONTMORENCY COUNTY  
Recorded & Filed

11-12-1997 09:39:39

A. PANGAN-MCELROY  
REGISTER OF DEEDS

Register of Deeds Stamp & File Number

4. Lot No. \_\_\_\_\_, Recorded Plat \_\_\_\_\_  
5. Private Claims \_\_\_\_\_

I, FREDERICK J. KING, in a field survey on June 18, 1997 do hereby state that under requirements of P.A. 74, Michigan P.A. of 1970, the corner points mentioned in lines 1 and 2 above were in conformance with regulations and rules therefore as required in the current manual of survey instructions of the United States Department of the Interior, Bureau of Land Management or by a decree of a Court of Law and /or that the corner points mentioned in lines 3, 4 and 5 above were in conformance with the rules of the Michigan Board of Land Surveyors or by a Decree of a Court of Law; established, re-established, monumented, recovered, found as expressed below:

NOTE: Not more than 2 corners, all in the same town and range, may be recorded on this certificate.

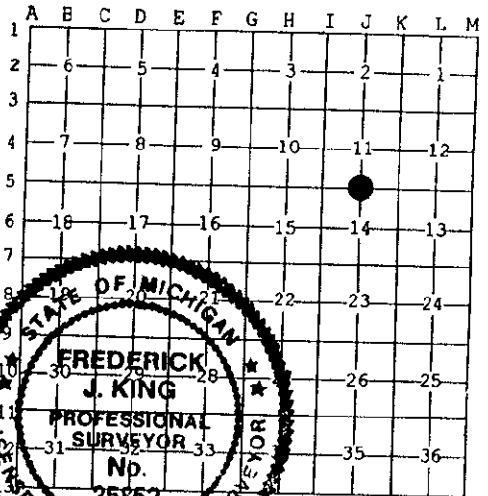

A. Description of original monument and accessories and/or subsequent restoration:

J-5 - 1/4 CORNER COMMON TO SECTIONS 11 & 14

- June 1840 - Original Post set by L. Clason, D.S. (Pg 362) \* S26W-20 1ks(13.20')12" J. Pine \* N69E-32 1ks(21.12') 9" W Pine
- June 1969 - Sec Division by N.C. Caldwell, PS #12018 - Fnd Post - Placed Conc Mon - S68W-32.9'-8" J. Pine - Not Recorded
- July 1973 - Act 132 by N.C. Caldwell, PS #12018 - No cor Desc - No Wit - Rec. L.I, Pg. 400-403

B. Description of corner evidence found and/or method applied in restoring or reestablishing corner:

J-5 - 1/4 CORNER COMMON TO SECTIONS 11 & 14

Found Record Conc Monument - Set by N.C. Caldwell, PS #12018 - June 1969 - On N Edge Pipeline Clearing E&W AND On E edge Pipeline Clearing to S AND ±4' S & ±4' E of Old Fnc Cor Post

Record Witnesses Found - None - Pipeline Construction Removed  
(M) N25°W - (M) 3.5' - Fnd Blz in 4" Pop (No Record Fnd)  
(M) N50°E - (M) 10.0' - Fnd Blz in 5" Pop (No Record Fnd)  
(M) S30°E - (M) 43.8' - Fnd Blz in 5" Pop (No Record Fnd)

This Corner Approved by County Peer Review on June 20, 1997, as the best available evidence of the position of the Original Corner.

C. Description of monument for corner and accessories established to perpetuate locating the position of the corner:

J-5 - 1/4 CORNER COMMON TO SECTIONS 11 & 14

PLACED COUNTY RE-MON CAP ON FOUND CONC MONUMENT & SET TREATED 2"x4" STAKE ON N. SIDE.

Corner is on N edge of E-W Pipeline Clearing & in line with E edge of Pipeline Clearing to South - ALSO, Corner is ±4' S & ±4' E of Old Fence Cor Post.

- N50°E - 10.13' - Set S&T on SE side of 5" Poplar
- S30°E - 43.93' - Set S&T on NE side of 5" Poplar
- N65°W - 22.35' - Set S&T on N side of 6" Poplar
- N25°W - 3.61' - Set S&T on W side of 4" Poplar

APPROVED BY  
PEER GROUP

JUN 20 97

*J.G.B.*

Signed by Frederick J. King

Date Nov. 6, 1997

Surveyor's Michigan License No. 25852