

SURVEY & REMONUMENTATION

FEB 06 1998

Montmorency County Remonumentation

SECTION

LAND CORNER RECORDATION CERTIFICATE
Filing Requirement of Act 74, Mich. P.A. 1970

Liber **00012** Page **0262**

For corners in

MONTMORENCY
(County)

| Located in: | Corner Code # |
|-------------|---------------|
| ALBERT TWP. | |
| T 29N R 1E | J-7 |
| T R | |
| T R | |
| T R | |
| S T R | |
| S T R | |
| S T R | |
| S T R | |

1. Public Land Survey

2. Property Controlling in Section

3. Miscellaneous Property in Sec.

4. Lot No. _____, Recorded Plat _____
5. Private Claims _____

STATE OF MICHIGAN
MONTMORENCY COUNTY
Recorded & Filed

11-12-1997 09:39:48

A. FANGH-MCELROY
REGISTER OF DEEDS

Register of Deeds Stamp & File Number

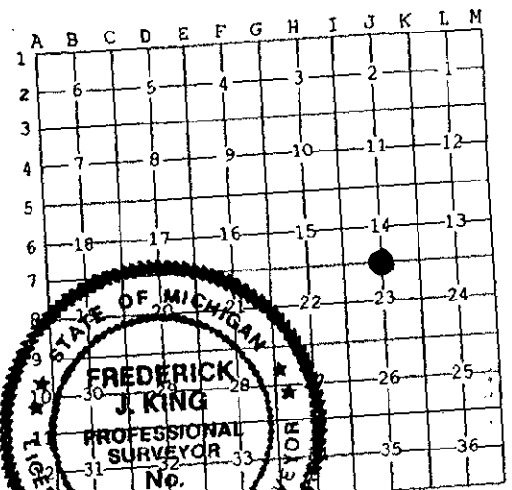

I, FREDERICK J. KING, in a field survey on June 18, 1997 do hereby state that under requirements of P.A. 74, Michigan P.A. of 1970, the corner points mentioned in lines 1 and 2 above were in conformance with regulations and rules therefore as required in the current manual of survey instructions of the United States Department of the Interior, Bureau of Land Management or by a decree of a Court of Law and/or that the corner points mentioned in lines 3, 4 and 5 above were in conformance with the rules of the Michigan Board of Land Surveyors or by a Decree of a Court of Law; established, re-established, monumented, recovered, found as expressed below:

NOTE: Not more than 2 corners, all in the same town and range, may be recorded on this certificate.

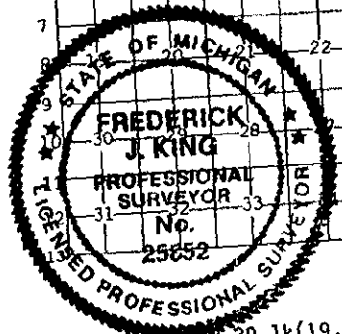

A. Description of original monument and accessories and/or subsequent restoration:

- J-7 - 1/4 CORNER COMMON TO SECTIONS 14 & 23
- June 1840 - Original Post set by L. Clason, D.S. (Pg362) * N42E-16 1k(10.56')11" Spr Pine * S32W-30 1k(19.80') 14" Spr Pine
- July 1966 - Sec Division by G.D. Henning, PS #2240 - Fnd 1/2" Bar - No Wit - Not Recorded - (Peer Committee believes Henning Set by Single Prop.)
- July 1967 - Field Notes by G.D. Henning, PS #2240 - Fnd 1/2" Bar - No Wit - Not Recorded
- June 1969 - Sec Division by N.C. Caldwell, PS #12018 - Fnd 1/2" Bar * N20E-45.0'-14" R.P. * S10W-31.45'-10" Oak SOUTH-33.0' - 1/2" Bar
- Nov 1971 - "WILDWOOD SUB. NO. 2" by N.C. Caldwell, PS #12018 - No Cor Desc - No Wit - Rec. L.2, Pgs 97-98
- Dec 1971 - Act 132 by N.C. Caldwell, PS #12018 - Fnd Rec 1/2" Bar by Henning * N20E-45.0'-14" R.P. * SOUTH-33.0'-1/2" Bar S10W-31.5'-10" Oak * NORTH-33.0'-Conc Mon (Wildwood)
- Dec 1972 - Act 74 by N.C. Caldwell, PS #12018 - Fnd Rec 1/2" Bar by Henning - Same Wit as Dec 1971 Survey- Rec L.1, Pg. 34
- Mar 1973 - "WILDWOOD SUB. NO. 3" by N.C. Caldwell, PS #12018 - No Cor Desc - No Wit - Rec. L.3, Pgs 15 & 16
- July 1985 - Act 132 by D.E. Marlatt, PS #18660 - Fnd 1/2" Bar - Same Wit as N.C. Caldwell Sec Div in June 1969
- July 1992 - Act 132 by D.E. Marlatt, PS #18660 - Fnd Henning 1/2" Rod - Same Wit as Act 74 Rec L.1, Pg 34(Rec L.4, Pg 189)
- May 1993 - Act 132 by D.E. Marlatt, PS #18660 - Fnd 1/2" Rod - Same Wit as Act 74 Rec L.1, Pg. 34 * Rec. L.4, Pg. 118
- Sept 1993 - Act 132 by D.E. Marlatt, PS #18660 - Fnd 1/2" Henning Rod - Same Wit as Act 74 Rec L.1, Pg. 34 AND ADDED S34E-53.4'-12" Oak * S40W-45.6' - 13" Oak

B. Description of corner evidence found and/or method applied in restoring or reestablishing corner:

- J-7 - 1/4 CORNER COMMON TO SECTIONS 14 & 23
- Found Rec 1/2" Iron - Also Fnd 1 1/2" Pipe (Conflicting Corner) - 7.2' NNW of Iron Fnd
- Record Witnesses Found - (R&M) NORTH -33.0' - Rec Conc Mon (Wildwood)
- (R) S34OE (M) S45OE - (R&M) 53.4' - Fnd Spk 12" Oak
- (R&M) SOUTH - (R&M) 33.0' - Fnd 1/2" Iron(Bent - Appears to have been hit by Pipeline Const)
- (R&M) S40OW - (R&M) 45.6' - Fnd Spk 13" Oak

This Corner Approved by County Peer Review on June 20, 1997, as the best available evidence of the position of the Original Corner.

C. Description of monument for corner and accessories established to perpetuate locating the position of the corner:

- J-7 - 1/4 CORNER COMMON TO SECTIONS 14 & 23
- PLACED CONC. MONUMENT & COUNTY RE-MON CAP AT FOUND 1/2" IRON LOCATION
- Corner is in C.L. of E-W gravel road (Willow-Way Drive)
- CONFLICTING CORNER ALSO FOUND - A 1 1/2" Pipe was also found, 7.2' NNW of Approved corner.
- NORTH -- 33.00' - Fnd Rec Conc Mon @ SE Cor of Lot 32 of "WILDWOOD SUB. NO. 2"
- N20OE - 53.38' - Set S&T on W side of 12" Oak
- S45OE (R-S34OE) - 53.43' (R-53.4') Set S&T above Spk Fnd on SW side of 12" Oak
- SOUTH -- 33'± (Hit during Pipeline const.) - Fnd Rec 1/2" I&C (Set by G. Henning)
- S40OW - 45.55'(R-45.6') Set S&T above Fnd Spk on NW side of 13" Oak
- N05OW - 33.07' - Set S&T on E side of Pwr. Pole #LW1-22-12

APPROVED BY PEER GROUP

JUN 20 97

J.L.B.

Signed by Frederick J. King
Surveyor's Michigan License No. 25852

Date Nov. 6, 1997