

**SURVEY & REMONUMENTATION**

**Montmorency County Remonumentation**

**FEB 06 1998**

**LAND CORNER RECORDATION CERTIFICATE**  
Filing Requirement of Act 74, Mich. P.A. 1970

Liber **00012** Page **0264**

For corners in **SECTION**

<u>MONTMORENCY</u> (County)	Located in: ALBERT TWP.	Corner Code #
1. Public Land Survey	T <u>29N</u> R <u>1E</u>	<u>J-11</u>
	T _____ R _____	_____
	T _____ R _____	_____
	T _____ R _____	_____
2. Property Controlling in Section	S _____ T _____ R _____	_____
	S _____ T _____ R _____	_____
3. Miscellaneous Property in Sec.	S _____ T _____ R _____	_____
	S _____ T _____ R _____	_____

STATE OF MICHIGAN  
MONTMORENCY COUNTY  
Recorded & Filed

11-12-1997 09:40:11

A. PANGAN-MCELROY  
REGISTER OF DEEDS

Register of Deeds Stamp & File Number

4. Lot No. \_\_\_\_\_, Recorded Plat \_\_\_\_\_  
5. Private Claims \_\_\_\_\_

I, FREDERICK J. KING, in a field survey on June 5, 1997 do hereby state that under requirements of P.A. 74, Michigan P.A. of 1970, the corner points mentioned in lines 1 and 2 above were in conformance with regulations and rules therefore as required in the current manual of survey instructions of the United States Department of the Interior, Bureau of Land Management or by a decree of a Court of Law and /or that the corner points mentioned in lines 3, 4 and 5 above were in conformance with the rules of the Michigan Board of Land Surveyors or by a Decree of a Court of Law; established, re-established, monumented, recovered, found as expressed below:

NOTE: Not more than 2 corners, all in the same town and range, may be recorded on this certificate.

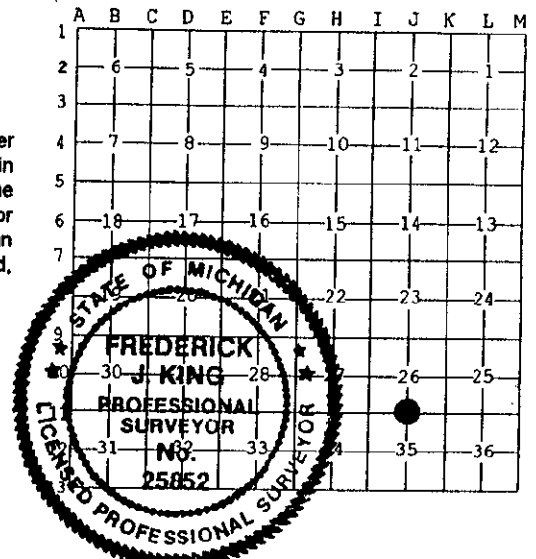

**A. Description of original monument and accessories and/or subsequent restoration:**

- J-11 - 1/4 CORNER COMMON TO SECTIONS 26 & 35
- June 1840 - Original Post set by L. Clason, D.S. (Pg360) \* N32E-12 1k(7.92')6" Spr P. \* S65W-30 1k(19.80')7" Spr Pine
- Date ? - Field Notes by N.C. Caldwell, PS #12018 - No Wit - Not Recorded
- Apr 1968 - Act 132 by N.C. Caldwell, PS #12018 - No Cor Desc - No Wit - Not Recorded
- Sept 1969 - Act 132 by N.C. Caldwell, PS #12018 - No Cor Desc - No Wit - Not Recorded
- Aug 1972 - Act 74 by N.C. Caldwell, PS #12018 - No cor Desc \* S63W-65.2'-5" Tw Oak \* N41E-39.05'-6" Oak  
Rec. L. 1, Pg. 18
- Mar 1973 - Act 132 by N.C. Caldwell, PS #12018 - No Cor Desc - No Wit - Rec. L.1, Pgs. 315-316
- Mar 1973 - Act 74 by G.R. McKelvey, PS #19001 - Fnd Conc Mon as used by N.C. Caldwell, PS #12018 in 1969  
Rec. L.1, Pg 61 \*\* S42°42'E-46.15' -I&C #19001 - N2°58'E-33.0'- Conc Mon \* S43°15'E-46.33'-2" Pipe
- Sept 1973 - Act 132 by G.R. McKelvey, PS #19001 - Fnd Conc Mon - Same Wit as L. 1, Pg. 61 \* Rec. L.1, Pgs 420-421
- July 1977 - Act 132 by D.E. Marlatt, PS #18660 - Fnd Mon \* N40E-39.37'-12" Oak \* EAST-23.8'-6" Oak  
Rec. L. 2, Pgs 345-346
- May 1984 - Act 132 by F.J. King, PS #25852 - Fnd Rec Conc Mon - Ref to L. 1, Pg. 420 - Rec. L.3, Pg. 301
- Nov 1987 - Act 132 by L.G. Beauregard, PS#18654 - Fnd Mon - Same wit as L. 2, Pgs. 345-346 \* Rec. L. 3, Pg. 423-424

**B. Description of corner evidence found and/or method applied in restoring or reestablishing corner:**

- J-11 - 1/4 CORNER COMMON TO SECTIONS 26 & 35
- Found Rec Conc Monument (±1.5' Deep) ±6' South of south Edge of East-West 2 Track Drive
- Record Witnesses Found - (R&M) N40°E - (R) 39.37' (M) 39.30' - 15" Oak  
(R&M) S55°W - (R&M) 65.06' - 12" Oak  
(R&M) N2°58'E - (R&M) 33.0' - Conc Mon.

This Corner Approved by County Peer Review on June 20, 1997, as the best available evidence of the position of the Original Corner.

**C. Description of monument for corner and accessories established to perpetuate locating the position of the corner:**

- J-11 - 1/4 CORNER COMMON TO SECTIONS 26 & 35
- PLACED COUNTY RE-MON CAP ON FOUND CONC. MONUMENT
- Corner is ±6' S of S edge of E-W 2 Track Drive AND is ±1.5' Deep
- N40°E - 39.30' (R-39.37' & 39.05') - Set S&T on SE side of 15" Oak (Caldwell & Marlatt BT)
- S43°E - 46.15' & 46.33' - Fnd Rec 1/2" Iron & 2" Pipe (G. McKelvey Wit)
- S15°E - 57.43' - Set S&T on W side of Pwr Pole #LW03-24
- S55°W - 65.06' - Fnd Spk on E side of 12" Oak (D. Marlatt BT)
- N40°W - 53.58' - Set S&T on NE side of Pwr Pole #LW3-24A
- N03°E - 33.00' - Fnd Rec Conc Mon. (McKelvey Wit)

**APPROVED BY PEER GROUP**

JUN 20 97

Signed by *Frederick J. King*  
Surveyor's Michigan License No. 25852

Date Nov. 6, 1997 *L.A.B*