

SURVEY & REMONUMENTATION

FEB 06 1998

Montmorency County Remonumentation

Liber 00012 Page 0368

SECTION

LAND CORNER RECORDATION CERTIFICATE

Filing Requirement of Act 74, Mich. P.A. 1970

For corners in

Table with columns: MONTMORENCY (County), Located in: ALBERT TWP., Corner Code #, and numbered items 1-5 describing survey types and their locations.

STATE OF MICHIGAN MONTMORENCY COUNTY Recorded & Filed

11-12-1997 09:40:48

A. FANGAN-MCELROY REGISTER OF DEEDS

Register of Deeds Stamp & File Number

I, FREDERICK J. KING, in a field survey on June 9, 1997, do hereby certify that under requirements of P.A. 74, Michigan P.A. of 1970, the corner points mentioned in lines 1 and 2 above were in conformance with regulations and rules therefore as required in the current manual of survey instructions of the United States Department of the Interior, Bureau of Land Management or by a decree of a Court of Law and/or that the corner points mentioned in lines 3, 4 and 5 above were in conformance with the rules of the Michigan Board of Land Surveyors or by a Decree of a Court of Law; established, re-established, monumented, re-monumented, recovered, found as expressed below:

NOTE: Not more than 4 corners, all in the same town and range, may be recorded on this certificate.

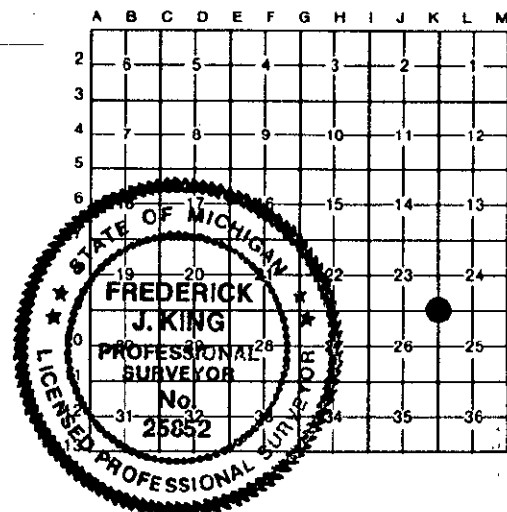

A. Description of original monument and accessories and/or subsequent restoration:

- List of survey events from 1840 to 1993, including descriptions of original posts, field notes, and subsequent restorations.

B. Description of corner evidence found and/or method applied in restoring or reestablishing corner:

- Description of corner evidence found, including iron, oak, pole, and concrete monuments with bearings and distances.

This Corner Approved by County Peer Review on June 20, 1997, as the best available evidence of the position of the Original Corner.

C. Description of monument for corner and accessories established to perpetuate locating the position of the corner:

- Description of the monument established for the corner, including details about the iron cap, oak tag, pole, and concrete monument.

APPROVED BY PEER GROUP

JUN 20 97

L.H.B.

Signed by Frederick J. King Date Nov. 6, 1997

Surveyor's Michigan License No. 25852