

**SURVEY & REMONUMENTATION**

**FEB 06 1998**

**Montmorency County Remonumentation**

Liber **00012** Page **0271**

**LAND CORNER RECORDATION CERTIFICATE**

**Filing Requirement of Act 74, Mich. P.A. 1970**

For corners in **SECTION**

<u>MONTMORENCY</u> (County)	Located In: <b>ALBERT TWP.</b>	Corner Code <b>##</b> <b>K-12</b>
1. Public Land Survey	T 29N R 1E	
	T R	
	T R	
	T R	
2. Property Controlling in Section	S T R	
	S T R	
3. Miscellaneous Property in Sec.	S T R	
	S T R	
4. Lot No. _____, Recorded Plat _____		
5. Private Claims _____		

STATE OF MICHIGAN  
MONTMORENCY COUNTY  
Recorded & Filed

11-12-1997 09:41:15

A. PANGAN-MCELROY  
REGISTER OF DEEDS

**Register of Deeds Stamp & File Number**

I, **FREDERICK J. KING**, in a field survey on June 12, 1997, do hereby certify that under requirements of P.A. 74, Michigan P.A. of 1970, the corner points mentioned in lines 1 and 2 above were in conformance with regulations and rules therefore as required in the current manual of survey instructions of the United States Department of the Interior, Bureau of Land Management or by a decree of a Court of Law and/or that the corner points mentioned in lines 3, 4 and 5 above were in conformance with the rules of the Michigan Board of Land Surveyors or by a Decree of a Court of Law; established, re-established, monumented, re-monumented, recovered, found as expressed below:

**NOTE: Not more than 4 corners, all in the same town and range, may be recorded on this certificate.**

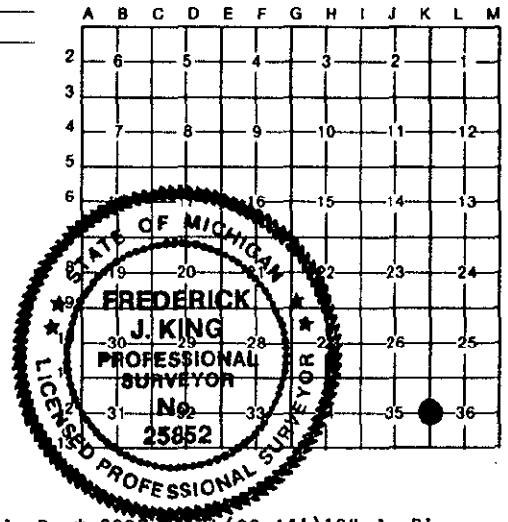

A. Description of original monument and accessories and/or subsequent restoration:

- K-12 - 1/4 CORNER COMMON TO SECTIONS 35 & 36
- June 1840 - Original Post Set by L. Clason, D.S. (Pg355) - N61W-35 1k(23.10')10" J. P. \* S39E-34 1k(22.44')10" J. Pine
- Date ? - Index Map furnished by D.E. Marlatt, PS #18660, indicates that F.N. Smith, PS #754, used this corner.
- Feb. 1936 - "SUPERVISOR'S PLAT OF A SUB OF GOVT LOT 1 OF SEC. 35, T29N-R1E" by F.N. Smith, PS #754 - No Wit.-Rec. L.1, Pg.33
- Sept 1968 - Act 132 by N.C. Caldwell, PS #12108 - No Cor Desc - No Wit - Not Recorded
- Aug 1969 - Act 132 by N.C. Caldwell, PS #12018 - No Cor Desc - No Wit - Not Recorded
- Sept 1969 - Act 132 by N.C. Caldwell, PS #12108 - No Cor Desc - No Wit - Not Recorded
- Aug 1971 - Act 132 by N.C. Caldwell, PS #12108 - No Cor Desc - No Wit - Rec. L. 1, Pg. 54
- Aug 1972 - Act 132 by L.G. Beauregard, PS #18654 - No Cor Desc - No Wit - Rec. L. 1, Pg. 175
- Sept 1972 - Act 132 by L.G. Beauregard, PS #18654 - No Cor Desc - No Wit - Rec. L. 1, Pgs. 259-260
- Apr. 1973 - Act 132 by N.C. Caldwell, PS #12108 - No Cor Desc - No Wit - Rec. L. 1, Pg. 399
- Mar 1974 - Act 132 by L.G. Beauregard, PS #18654 - No Cor Desc - No Wit - Not Recorded
- July 1974 - Act 132 by N.C. Caldwell, PS #12108 - No Cor Desc - No Wit - Rec. L. 2, Pg. 8
- July 1987 - Act 132 by L.G. Beauregard, PS #18654 - Fnd Conc Mon \*WEST-33.0'-Plat Mon \* S63W-43.1'-14" Oak S85E-45.6'-10" Oak Rec. L. 3, Pg. 400
- Nov 1992 - Act 74 by L.G. Beauregard, PS #18654 - Fnd 4" Dia Conc Mon - Set by F.N. Smith, PS #754 about 1934 Rec. L. 1, Pg. 490 WEST-33.0'-Plat Mon \*S63W-43.1'-18" Oak (R-1968 N.C. Caldwell) S85E-45.6'-14" Oak (R-1968 N.C. Caldwell) \* NW -21.0'- P. Pole (R-1968 N.C. Caldwell)
- Nov 1992 - Act 132 by L.G. Beauregard, PS #18654 - Fnd Conc Mon - Same Wit as L. 1, Pg. 490
- Feb 1993 - Act 132 by L.G. Beauregard, PS #18654 - Fnd Conc Mon - Same Wit as L. 1, Pg. 490

B. Description of corner evidence found and/or method applied in restoring or reestablishing corner:

- K-12 - 1/4 CORNER COMMON TO SECTIONS 35 & 36
- FOUND RECORD CONC MONUMENT - RECORD WITNESSES FOUND - (R&M) S85E - (R&M) 45.6' - 14" Oak (R&M) S63W - (R&M) 43.1' - 18" Oak (R&M) WEST - (R&M) 33.0' - Plat Mon (R) NW (M) N85W -(R&M) 21.0' - P. Pole #LW3-39-10

This Corner Approved by County Peer Review on June 20, 1997, as the best available evidence of the position of the Original Corner.

C. Description of monument for corner and accessories established to perpetuate locating the position of the corner:

- K-12 - 1/4 CORNER COMMON TO SECTIONS 35 & 36
- PLACED COUNTY RE-MON CAP ON FOUND CONCRETE MONUMENT - Corner 1s in C.L. N-S Grave! Rd. (Big Wolf Lake Road)
- N50E - 41.21' - Set S&T on SE side of 12" Oak
- S85E - 45.77'(R-45.6') - Set S&T on S side of 12" Oak (L. Beauregard BT)
- S63W - 43.49' (R-43.1') - Set S&T on SE side of 18" Oak (L.G. Beauregard BT)
- WEST - 33.00' - Fnd Rec Conc Mon @ SE Cor of Lot 1 of "SUPERVISOR'S PLAT OF A SUB OF GOVT. LOT 1 OF SEC. 35" (L. 1, of Plats, Page 33)
- N85W - 21.36' (R-21.0') - Set S&T on S side of Pwr. Pole #LW3-39-10 (N. Caldwell & L. Beauregard Wit.)

**APPROVED BY PEER GROUP**

Signed by Frederick J. King

Date Nov. 6, 1997 L. H. B.

Surveyor's Michigan License No. 25852