

**SURVEY & REMONUMENTATION**

MAR 13 2000

1999 Newaygo County Remonumentation Project

NEWAYGO COUNTY REGISTER OF DEEDS LINDA M. BROWN

LAND CORNER RECORDATION CERTIFICATE  
FILING REQUIREMENT of Act 74, Mich. P.A. 1970

FEB 28 PM 1 09

**SECTION**

*Linda M. Brown*

For corners in <u>Newaygo</u> (County)	Located in:	Corner Code #
1. Public Land Survey	T <u>11N</u> R <u>12W</u>	<u>B-13</u>
	T _____ R _____	_____
	T _____ R _____	_____
	T _____ R _____	_____
2. Property Controlling in Section	S _____ T _____ R _____	_____
	S _____ T _____ R _____	_____
3. Miscellaneous Property in Sec.	S _____ T _____ R _____	_____
	S _____ T _____ R _____	_____
4. Lot No. _____, Recorded Plat _____		
5. Private Claims _____		

VOL. 2

292

**Register of Deeds Stamp & File Number**

	A	B	C	D	E	F	G	H	I	J	K	L	M
1													
2	6	5	4	3	2	1							
3													
4	7	8	9	10	11	12							
5													
6	18	17	16	15	14	13							
7													
8	19	20	21	22	23	24							
9													
10	30	29	28	27	26	25							
11													
12	31	32	33	34	35	36							
13													

I, Norman L. Ochs, in a field survey on February 19, 1999, do hereby certify that under requirements of P. A. 74, Michigan P.A. of 1970, the corner points mentioned in lines 1 and 2 above were in conformance with regulations and rules therefore as required in the current manual of survey instructions of the United States Department of the Interior, Bureau of Land Management or by a decree of a Court of Law and/or that the corner points mentioned in lines 3, 4 and 5 above were in conformance with the rules of the Michigan Board of Land Surveyors or by a Decree of a Court of Law; established, re-established, monumented, re-monumented, recovered, found as expressed below:

**Note: Not more than 4 corners, all in the same town and range, may be recorded on this certificate.**

South One Quarter Corner, Section 31, Grant Township, Newaygo County, Michigan.

**A. DESCRIPTION OF ORIGINAL MONUMENT AND ACCESSORIES AND/OR SUBSEQUENT RESTORATION:**

G.L.O. N. Brookfield 1836  
10" Beech N15°E 23 Links (15.18')#1  
9" Beech N80°W 45 Links (29.7')#2

William M. Jacques (County Surveyor)  
Book 28, Pages 82 thru 91 November 14, 1907  
Found old quarter post. Set new corner iron thimble skein with broken glass under.

Delos G. Anderson (County Surveyor)  
Book A, Pages 345 and 346 April 8 thru 12, 1902  
10" Beech N23°E 53 Links (34.98')#3

Newaygo County Road Commission Sheet  
Gas Pipe

William R. Byl R.L.S. #23502  
May 1983 Found Iron Wagon Hub, 18" deep, 5' South of centerline of gravel road.  
Northwest Corner, Section 6, T10N R12W, Tyrone Township, Kent County Monument, West 35.73' #4

OVER ↘

**B. DESCRIPTION OF CORNER EVIDENCE FOUND AND/OR METHOD APPLIED IN RESTORING OR REESTABLISHING CORNER:**

Found 4" Harrison cast iron monument marked "County Surveyor" 0.8 feet below grade and in the centerline of the East and West bituminous road. The centerline of the North and South bituminous road is 30 feet East. The condition of the recorded witnesses are: #1 thru #3 gone, #4 good condition, #5 gone, #6 good condition, #7 and #8 gone.

**C. DESCRIPTION OF MONUMENT FOR CORNER AND ACCESSORIES ESTABLISHED TO PERPETUATE LOCATING THE POSITION OF THE CORNER:**

Accepted 4" Harrison cast iron monument marked "County Surveyor" as a substantial marker for the quarter corner and is accepted as a careful and faithful reestablishment of the original corner.

P.K. nail at surface over a 4" diameter Harrison cast iron monument with brass cap, Northwest Corner, Section 6, T10N R12W, West 34.72' #4

Northwest Corner House Foundation S10°E 158.85' #6  
Top center of telephone riser N57°W 69.38'  
Centerline of street sign N10°E 39.42'  
Set P.K. nail with tag #22439 in seam of curb S55°W 64.06'

Signed by Norman L. Ochs Date August 16, 1999

Surveyor's Michigan License No. 22439

Form approved by Michigan State Board of Land Surveyors, March 20, 1971

Approved by Peer Review Group on August 19, 1999  
Norman L. Ochs, County Representative.

*N.L.O.*

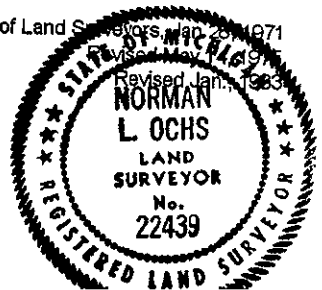

A. Description (cont.)

Norman L. Ochs R.L.S. #22439

September 11, 1985 LCRC #676

Found Wagon Skein raised with 1/2" Rod. Removed and set a 4" X 20" Harrison cast iron monument in gravel road. The centerline of the East and West road is 7 feet North and the centerline of the North and South road is 31 feet West.

8" Poplar N15°E 109.65' #5

Northwest Corner House at foundation S15°E 158.75' #6

24" Twin Ash S70°W 57.26' #7

Top center of Westerly Telephone Riser N55°W 70.91' #8

Northwest Corner, Section 6, T10N R12W, Kent County Monument, West 34.72' #4

SURVEY &  
REMONUMENTATION

MAR 1 3 2000

SECTION