

**SURVEY & REMONUMENTATION**

MAR 13 2000

SECTION

1999 Newaygo County Remonumentation Project

NEWAYGO COUNTY REGISTER OF DEEDS LINDA M. BROWN

LAND CORNER RECORDATION CERTIFICATE FILING REQUIREMENT of Act 74, Mich. P.A. 1970

FEB 28 PM 1 10

*Linda M. Brown*

For corners in Newaygo (County) Located in: \_\_\_\_\_ Corner Code # \_\_\_\_\_

1. Public Land Survey T 11N R 12W J-13  
 T \_\_\_\_\_ R \_\_\_\_\_  
 T \_\_\_\_\_ R \_\_\_\_\_  
 T \_\_\_\_\_ R \_\_\_\_\_

2. Property Controlling in Section S \_\_\_\_\_ T \_\_\_\_\_ R \_\_\_\_\_  
 S \_\_\_\_\_ T \_\_\_\_\_ R \_\_\_\_\_

3. Miscellaneous Property in Sec. S \_\_\_\_\_ T \_\_\_\_\_ R \_\_\_\_\_  
 S \_\_\_\_\_ T \_\_\_\_\_ R \_\_\_\_\_

4. Lot No. \_\_\_\_\_, Recorded Plat \_\_\_\_\_

5. Private Claims \_\_\_\_\_

VOL. 2 302

Register of Deeds Stamp & File Number

	A	B	C	D	E	F	G	H	I	J	K	L	M
1													
2	6	5	4	3	2	1							
3													
4	7	8	9	10	11	12							
5													
6	18	17	16	15	14	13							
7													
8	19	20	21	22	23	24							
9													
10	30	29	28	27	26	25							
11													
12	31	32	33	34	35	36							
13													

I, Norman L. Ochs, in a field survey on February 17, 19 99, do hereby certify that under requirements of P. A. 74, Michigan P.A. of 1970, the corner points mentioned in lines 1 and 2 above were in conformance with regulations and rules therefore as required in the current manual of survey instructions of the United States Department of the Interior, Bureau of Land Management or by a decree of a Court of Law and/or that the corner points mentioned in lines 3, 4 and 5 above were in conformance with the rules of the Michigan Board of Land Surveyors or by a Decree of a Court of Law, established, re-established, monumented, re-monumented, recovered, found as expressed below:

Note: Not more than 4 corners, all in the same town and range, may be recorded on this certificate.

South One Quarter Corner, Section 35, Grant Township, Newaygo County, Michigan.

**A. DESCRIPTION OF ORIGINAL MONUMENT AND ACCESSORIES AND/OR SUBSEQUENT RESTORATION:**

G.L.O. N. Brookfield 1836  
 10" Beech Corner  
 Measured 468 Links (308.88') from the South One Quarter Corner, Section 35, T11N R12W, to the Northeast Corner, Section 3, T10N R12W

Lyle S. Shepherd R.L.S. #503  
 Witness Book Number 2, Page 156  
 Power Pole N67°30'W 126.8' #1  
 Power Pole N40°E 59.8' #2  
 Telephone Pole S38°W 70.5' #3

William M. Jacques (County Surveyor)  
 Book 8, Pages 50 thru 52 October 10, 1904  
 Measured 80 Chains 51 feet (5331') from the South One Quarter Corner to the North One Quarter Corner of Section 35.

Newaygo County Road Commission Sheet  
 Power Pole N57°W 126.8' #1  
 Power Pole N44°E 59.8' #2  
 Telephone Pole S38°W 70.5' #3

OVER ↙

**B. DESCRIPTION OF CORNER EVIDENCE FOUND AND/OR METHOD APPLIED IN RESTORING OR REESTABLISHING CORNER:**

Found 4" Harrison cast iron monument marked "County Surveyor" in the centerline of the bituminous road going North and the centerline of the East and West bituminous road is 3 feet ± North. The condition of the recorded witnesses are: #1 and #2 good condition, #3 gone, #4 and #5 good condition.

**C. DESCRIPTION OF MONUMENT FOR CORNER AND ACCESSORIES ESTABLISHED TO PERPETUATE LOCATING THE POSITION OF THE CORNER:**

Accepted 4" Harrison cast iron monument marked "County Surveyor" as a substantial marker for the quarter corner and is accepted as a careful and faithful reestablishment of the original corner.

Power Pole N68°W 127.03' Found spike in Northeasterly side of pole. #1  
 Power Pole N44°E 60.23' Found spike in Northwesterly side of pole. #2  
 10" Elm S20°E 43.56' Set spike with tag #22439 in Easterly side of tree. #4  
 Street Sign Post N37°W 45.0' to centerline of post. #5  
 Northeast Corner, Section 3, T10N R12W, (4" diameter Harrison cast iron monument with Kent County brass cap) West 331.56' #6

Signed by Norman L. Ochs  
 Norman L. Ochs

Date August 16, 1999

Surveyor's Michigan License No. 22439

Form approved by Michigan State Board of Land Surveyors, Jan 28, 1971

Approved by Peer Review Group on August 19, 1999  
 Norman L. Ochs, County Representative.

Revised May 14, 1975  
 Revised Jan., 1983

*N.L.O.*

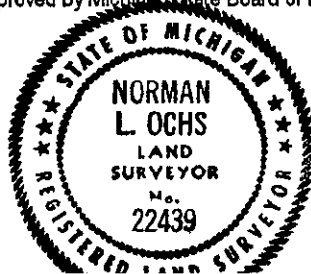

A. Description (cont.)

Norman L. Ochs R.L.S. #22439

LCRC #683 June 26, 1985

Found 1/2" X 3" Iron Sleigh Shoe in the centerline of road going North and the centerline of the East and West road is 3.5 feet North. Removed Iron and set a 4" x 20" Harrison cast iron monument marked "County Surveyor".

Power Pole N60°W 127.0' #1

Power Pole N45°E 59.95' #2

4" Elm S20°E 43.42' #4

Street Sign Post N45°W 44.90' #5

Northeast Corner, Section 3, T10N R12W, West 331.56' #6

James C. Glaza R.L.S. #40166

July 31, 1995 Recorded in Liber 364, Page 7089

Found County Monument

Witnesses recorded in LCRC #683

Measured 2619.47 feet from the South One Quarter Corner to the Southwest Corner of Section 35.

SURVEY &  
REMONUMENTATION

MAR 13 2000

SECTION