

**SURVEY & REMONUMENTATION**

MAR 13 2000

1999 Newaygo County Remonumentation Project

NEWAYGO COUNTY REGISTER OF DEEDS  
LINDA M. BROWN

LAND CORNER RECORDATION CERTIFICATE  
FILING REQUIREMENT of Act 74, Mich. P.A. 1970

FEB 28 PM 1 11

**SECTION**

For corners in Newaygo (County) Located in: \_\_\_\_\_ Corner Code # \_\_\_\_\_

1. Public Land Survey T 13N R 12W H-11  
 T \_\_\_\_\_ R \_\_\_\_\_  
 T \_\_\_\_\_ R \_\_\_\_\_  
 T \_\_\_\_\_ R \_\_\_\_\_

2. Property Controlling in Section S \_\_\_\_\_ T \_\_\_\_\_ R \_\_\_\_\_  
 S \_\_\_\_\_ T \_\_\_\_\_ R \_\_\_\_\_

3. Miscellaneous Property in Sec. S \_\_\_\_\_ T \_\_\_\_\_ R \_\_\_\_\_  
 S \_\_\_\_\_ T \_\_\_\_\_ R \_\_\_\_\_

4. Lot No. \_\_\_\_\_, Recorded Plat \_\_\_\_\_

5. Private Claims \_\_\_\_\_

*Linda M. Brown*

VOL. 2

328

**Register of Deeds Stamp & File Number**

	A	B	C	D	E	F	G	H	I	J	K	L	M
1													
2	6	5	4	3	2	1							
3													
4	7	8	9	10	11	12							
5													
6	18	17	16	15	14	13							
7													
8	19	20	21	22	23	24							
9													
10	30	29	28	27	26	25							
11													
12	31	32	33	34	35	36							
13													

I, Norman L. Ochs, in a field survey on November 24, 1999, do hereby certify that under requirements of P. A. 74, Michigan P.A. of 1970, the corner points mentioned in lines 1 and 2 above were in conformance with regulations and rules therefore as required in the current manual of survey instructions of the United States Department of the Interior, Bureau of Land Management or by a decree of a Court of Law and/or that the corner points mentioned in lines 3, 4 and 5 above were in conformance with the rules of the Michigan Board of Land Surveyors or by a Decree of a Court of Law; established, re-established, monumented, re-monumented, recovered, found as expressed below.

**Note: Not more than 4 corners, all in the same town and range, may be recorded on this certificate.**

North One Quarter Corner, Section 34, Everett Township, Newaygo County, Michigan.

**A. DESCRIPTION OF ORIGINAL MONUMENT AND ACCESSORIES AND/OR SUBSEQUENT RESTORATION:**

G.L.O. J.H. Mullett 1837  
 18" Pine S30°E 7 Links (4.62')#1  
 18" White Oak N10°E 9 Links (5.94')#2

Norman L. Ochs R.L.S. #22439  
 December 29, 1982 Drawing Number 82125AC  
 Found 1/2" Rod in monument box

Newaygo County Road Commission Sheet  
 Iron  
 Power Pole N08°W 37.4' #3  
 Power Pole S43°E 46.65' #4  
 (3) 4" Oaks S37°W 69.15' #5

Stanley H. Shackelford R.L.S. #30100  
 November 22, 1985 LCRC #667  
 Found Plow Point in monument box  
 Telephone and Power Pole S43°E 46.90' #4  
 8" Cherry N15°W 31.95' #6  
 10" Oak S37°W 71.00' #5

OVER ↵

**B. DESCRIPTION OF CORNER EVIDENCE FOUND AND/OR METHOD APPLIED IN RESTORING OR REESTABLISHING CORNER:**

Found 4" diameter Harrison cast iron monument 16" long marked "County Surveyor" in monument box. The centerline of the East and West bituminous road is 1 foot ± South. There is no apparent occupation North or South. The condition of the recorded witnesses are: #1 thru #3 gone, #4 thru #6 good condition, #7 new house, #8 and #9 good condition.

**C. DESCRIPTION OF MONUMENT FOR CORNER AND ACCESSORIES ESTABLISHED TO PERPETUATE LOCATING THE POSITION OF THE CORNER:**

Accepted 4" diameter Harrison cast iron monument 16" long marked "County Surveyor" in 8" diameter monument box as a substantial marker for the quarter corner and is accepted as a careful and faithful reestablishment of the position of the original corner.

Power Pole S47°E 46.86' Set spike with tag #22439 in West side of pole (5' ± above ground)#4  
 12" - 12" - 12" Triple Black Oak (blazed) S37°W 69.10' Found spike in West side of tree. #5  
 12" Cherry (blazed) N13°W 31.85' Found spike in West side of tree. #6  
 14" - 14" - 20" Triple Black Oak (blazed) N55°W 77.08' Found spike in South side of tree. #8  
 Centerline of East and West bituminous road South 1' ± #9  
 Northwest Corner House S34°E 113.96'

Signed by Norman L. Ochs  
 Norman L. Ochs

Date November 30, 1999

Surveyor's Michigan License No. 22439

Form approved by Michigan State Board of Land Surveyors, Jan 28, 1971  
 Revised May 14, 1975  
 Revised Jan., 1983

Approved by Peer Review Group on November 30, 1999  
 Norman L. Ochs, County Representative.

*N.L.O.*

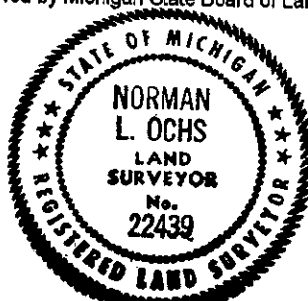

A. Description (cont.)

Norman L. Ochs R.L.S. #22439

December 19, 1993 LCRC #1160

Found 5/8" Rod on top 1/2" rod in monument box using 1985 witnesses. Removed and set a 4" Harrison cast iron monument marked "County Surveyor" in monument box.

Northeast Corner of House S34°E 129.58' #7

12" Triple Black Oak S30°W 69.12' #5

12" Triple Black Oak N50°W 77.08' #8

Centerline of road South 1.5' #9

10" Cherry N05°W 31.88' #6

Charles E. Fricke R.L.S. #21781

May 28, 1996 Recorded in Liber 365, Page 3699

12" Oak S30°W 69.12' #5

12" Oak N50°W 77.08' #8

10" Cherry N05°W 31.88' #6

SURVEY &  
REMONUMENTATION

MAR 1 3 2000

SECTION