

SURVEY & REMONUMENTATION

1999 Newaygo County Remonumentation Project

NEWAYGO COUNTY REGISTER OF DEEDS
LINDA M. BROWN

MAR 13 2000

LAND CORNER RECORDATION CERTIFICATE
FILING REQUIREMENT of Act 74, Mich. P.A. 1970

'00 FEB 28 PM 1 11

SECTION

For corners in Newaygo (County) Located in: _____ Corner Code # _____

1. Public Land Survey T 13N R 13W G-3
 T _____ R _____
 T _____ R _____
 T _____ R _____

2. Property Controlling in Section S _____ T _____ R _____
 S _____ T _____ R _____

3. Miscellaneous Property in Sec. S _____ T _____ R _____
 S _____ T _____ R _____

4. Lot No. _____, Recorded Plat _____

5. Private Claims _____

Linda M. Brown

VOL. 2

340

Register of Deeds Stamp & File Number

I, Norman L. Ochs, in a field survey on August 26, 1999, do hereby certify that under requirements of P. A. 74, Michigan P.A. of 1970, the corner points mentioned in lines 1 and 2 above were in conformance with regulations and rules therefore as required in the current manual of survey instructions of the United States Department of the Interior, Bureau of Land Management or by a decree of a Court of Law and/or that the corner points mentioned in lines 3, 4 and 5 above were in conformance with the rules of the Michigan Board of Land Surveyors or by a Decree of a Court of Law; established, re-established, monumented, re-monumented, recovered, found as expressed below:

Note: Not more than 4 corners, all in the same town and range, may be recorded on this certificate.

Northwest Corner, Section 10, Sherman Township, Newaygo County, Michigan.

	A	B	C	D	E	F	G	H	I	J	K	L	M
1													
2	6	5	4	3	2	1							
3													
4	7	8	9	10	11	12							
5													
6	18	17	16	15	14	13							
7													
8	19	20	21	22	23	24							
9													
10	30	29	28	27	26	25							
11													
12	31	32	33	34	35	36							
13													

A. DESCRIPTION OF ORIGINAL MONUMENT AND ACCESSORIES AND/OR SUBSEQUENT RESTORATION:

G.L.O. John Mullett 1838
 15" Hemlock N65°E 9 Links (5.94') #1
 15" Birch S72°W 21 Links (13.86') #2

William M. Jacques (County Surveyor)
 Book 14, Page 29 December 7, 1905
 Measured 82 Chains (5412') from the Southwest Corner to the Northwest Corner of Section 3.

William M. Jacques (County Surveyor)
 Book 8, Page 42 thru 45 September 5, 1904
 Pine Root stake with stone on West side of stake with broken glass around stake.

Lyle S. Shepherd R.L.S. #503
 Witness Book Number 2, Page 21
 10" Poplar S80°E 22.2' #3
 8" Poplar West 23.5' #4

Ralph A. Smith R.L.S. #3421
 April 29, 1954 Book 82, Page 32
 1" Gas Pipe with 3/4" Gas Pipe driver inside
 8" Poplar S85°E 22.1' #3
 8" Elm N85°E 40.25' #5

Ralph A. Smith R.L.S. #3421
 February 8, 1956, "Aspen Acres" Plat
 Northeast Corner of Plat is East 1308.2' #6

OVER ↘

B. DESCRIPTION OF CORNER EVIDENCE FOUND AND/OR METHOD APPLIED IN RESTORING OR REESTABLISHING CORNER:

Found 4" diameter Harrison cast iron monument marked "County Surveyor" in the centerline of paved road going South extended and the centerline of the gravel drive is 15 feet ± East. The condition of the recorded witnesses are: #1 thru #5 gone, #6 did not measure, #7 thru #9 gone, #10 thru #13 good condition.

C. DESCRIPTION OF MONUMENT FOR CORNER AND ACCESSORIES ESTABLISHED TO PERPETUATE LOCATING THE POSITION OF THE CORNER:

Accepted 4" diameter Harrison cast iron monument 20" long marked "County Surveyor" as a substantial marker for the section corner and is accepted as a careful and faithful reestablishment of the original corner.

Power Pole N40°W 43.33' Found spike with tag #22439 in Southwest Side of pole. #10
 12" Cherry N40°E 54.49' Found spike with tag #22439 in South side of tree. #11
 16" Ash S65°E 74.75' Found spike with tag #22439 in West side of tree. #12
 12" Maple S70°W 14.71' Found spike with tag #22439 in North side of tree. #13

Signed by Norman L. Ochs Date October 22, 1999
 Norman L. Ochs

Surveyor's Michigan License No. 22439

Form approved by Michigan Board of Land Surveyors, Jan 28, 1971
 Revised May 14, 1975
 Revised Jan., 1983

Approved by Peer Review Group on October 28, 1999
 Norman L. Ochs, County Representative.

N.L.O.

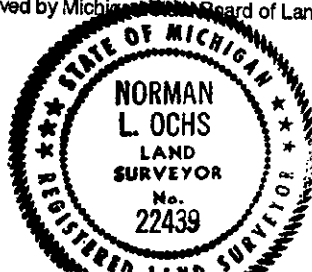

A. Description (cont.)

Matt Koivisto R.L.S. #16047

October 28, 1970 Found 1½" Gas Pipe (old corner) has been raised with ¾" Pipe

10" Birch S30°E 32.24' #7

8" Cherry N60°E 10.92' #8

8" Poplar N45°W 24.83' #9

Norman L. Ochs R.L.S.#22439

December 18, 1978 Found ½" Pipe under wood bridge, set PK nail in bridge deck ± 0.70 feet West of the East side of bridge.

10" Birch S30°E 32.24' #7

4" Twin Cherry (dead) N60°E 10.92' #8

8" Poplar N45°W 24.83' #9

Norman L. Ochs R.L.S. #22439

December 15, 1986 LCRC #812

Found 1½" Pipe in small creek. Removed and set a 4" diameter 20" long Harrison cast iron monument marked "County Surveyor"

Power Pole N40°W 43.33' #10

8" Cherry N40°E 54.49' #11

10" Ash S65°E 74.75' #12

3" Maple S70°W 14.71' #13

Norman L. Ochs R.L.S. #22439

July 29, 1994 Drawing Number 94166AC

5" Red Maple S52°W 14.68' #13

Power Pole N49°W 43.33' #10

10" Black Cherry N20°E 54.52' #11

SURVEY &
REMONUMENTATION

MAR 13 2000

SECTION