

SURVEY & REMONUMENTATION

LIBER 1935070369

JA-5 99 001669

MAR 11 1999

LAND CORNER RECORDATION CERTIFICATE  
Filing Requirement of Act 74, Mich. P.A. 1970

\$ 7.00 MISCELLANEOUS RECORDING  
\$ 2.00 REMONUMENTATION

5 JAN 99 8:24 A.M. RECEIPT PAID  
RECORDED - OAKLAND COUNTY  
G. WILLIAM CADWELL  
CLERK/REGISTER OF DEEDS

For corners in SECTION

|                                       |                              |               |
|---------------------------------------|------------------------------|---------------|
| Oakland<br>(County)                   | Located in: Lyon<br>Township | Corner Code # |
| 1. Public Land Survey                 | T <u>1N</u> R <u>7E</u>      | <u>A-3</u>    |
|                                       | T _____ R _____              | _____         |
|                                       | T _____ R _____              | _____         |
|                                       | T _____ R _____              | _____         |
| 2. Property Controlling<br>in Section | S _____ T _____ R _____      | _____         |
|                                       | S _____ T _____ R _____      | _____         |
| 3. Miscellaneous<br>Property in Sec.  | S _____ T _____ R _____      | _____         |
|                                       | S _____ T _____ R _____      | _____         |

Compliance with  
ACT 345, P.A. 1990

APPROVED ON: 12-16-98 JS  
OAKLAND COUNTY REMONUMENTATION  
PEER GROUP COMMITTEE  
Register of Deeds Stamp & File Number

4. Lot No. \_\_\_\_\_, Recorded Plat \_\_\_\_\_  
5. Private Claims \_\_\_\_\_

I, Bruce Antcliff, in a field survey on May 19 19 98, do hereby certify that under requirements of P.A. 74 Michigan P.A. of 1970, the corner points mentioned in lines 1 and 2 above were in conformance with regulations and rules therefore as required in the current manual of survey instructions of the United States Department of the interior, Bureau of Land Management or by a decree of a Court of Law and/or that the corner points mentioned in lines 3, 4 and 5 above were in conformance with the rules of the Michigan Board of Land Surveyors or by a Decree of a Court of Law; established, re-established, monumented, re-monumented, recovered, found as expressed below:

|    |    |    |    |    |    |    |   |   |   |   |   |   |
|----|----|----|----|----|----|----|---|---|---|---|---|---|
| A  | B  | C  | D  | E  | F  | G  | H | I | J | K | L | M |
| 2  | 6  | 5  | 4  | 3  | 2  | 1  |   |   |   |   |   |   |
| 3  |    |    |    |    |    |    |   |   |   |   |   |   |
| 4  | 7  | 8  | 9  | 10 | 11 | 12 |   |   |   |   |   |   |
| 5  |    |    |    |    |    |    |   |   |   |   |   |   |
| 6  | 18 | 17 | 16 | 15 | 14 | 13 |   |   |   |   |   |   |
| 7  |    |    |    |    |    |    |   |   |   |   |   |   |
| 8  | 19 | 20 | 21 | 22 | 23 | 24 |   |   |   |   |   |   |
| 9  |    |    |    |    |    |    |   |   |   |   |   |   |
| 10 | 30 | 29 | 28 | 27 | 26 | 25 |   |   |   |   |   |   |
| 11 |    |    |    |    |    |    |   |   |   |   |   |   |
| 12 | 31 | 32 | 33 | 34 | 35 | 36 |   |   |   |   |   |   |
| 13 |    |    |    |    |    |    |   |   |   |   |   |   |

NOTE: Not more than 4 corners, all in the same town and range, may be recorded on this certificate.

A. Description of original monument and accessories and/or subsequent restoration:

|     |      |         |                                     |                  |
|-----|------|---------|-------------------------------------|------------------|
| A-3 | 1816 | Holmes  | G.L.O.                              | Set Post         |
|     | 1989 | Donnell | Survey                              | N/A              |
|     | 1997 | B. Boss | L.C.R.C.L.S.C. #824m, M-3, T1N, R6E | 4" Post in Conc. |
|     | N/A  | N/A     | O.C. Tax Maps                       | N/A              |

Records indicate this corner is not common with M-3, T1N, R6E.

B. Description of corner evidence found and/or method applied in restoring or reestablishing corner:

A-3 Found a 3" diameter steel post (5' high) inside a 4" diameter post cut off at ground level in concrete 248.6' South of Livingston County monument at the Northeast corner of Section 12, T1N, R6E as set in L.C.R.C. L.S.C #824m (Livingston County Records). The found 3" post is on line of a fence running North and South and the C/L of Silver Lake Road (bit.) running East. The found 3" post also checks the distance of 248.6' South of M-3, T1N, R6E, per 1964 Wynn W. Wakenhut survey. Found no record information pertaining to this corner. The found 3" post is 6.0' East of the Township line.

Measure North 2586.33' to A-2 (Boss Survey (1997 Livingston Co. Remon.) = 2586.07'

Measure South 2640.10' to A-4

Measure East 1543.58' to B-3 (G.L.O. = 1556.28')

Measure North 248.6' to M-3, T1N, R6E (G.L.O. = 419.76')

700 FILE  
200

C. Description of monument for corner and accessories established to perpetuate locating the position of the corner:

A-3 Set a 5/8" x 24" rebar with brass cap stamped "Oakland County Remonumentation P.S. #25826" 6' West of the 3" dia. steel post on the Township line.

PK Nail & Oakland Co. Remonumentation Tag in W Side P. Pole S 10° E 32.52'

PK Nail & Oakland Co. Remonumentation Tag in E Side 10" Maple N 02° W 23.79'

PK Nail & Oakland Co. Remonumentation Tag in S Side 12" Maple N 80° W 35.92'

NE Cor. Garage Foundation S 45° W 48.87'

Livingston County Mon. M-3, T1N, R6E, North 248.3'

R.R. Spike in Mon. Box South 164.94' (C/L intersection Silver Lake Road West)

The selected location is accepted by the Contractor and is generally accepted by professional surveyors as the best available evidence of the position of the original corner.

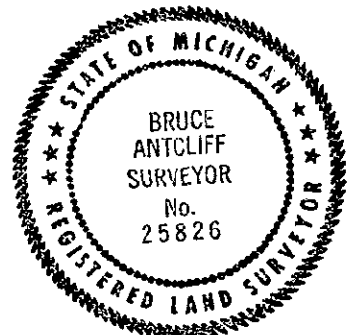

Signed by Bruce Antcliff

Date 12-22-98

EARTH TECH

Surveyor's Michigan License No. 25826