

COPY

JUL 1995 129149

LIBER 15528pc 769

LAND CORNER RECORDATION CERTIFICATE
Filing Requirement of Act 74, Mich. P.A. 1970

\$ 7.00 MISCELLANEOUS RECORDING
\$ 2.00 REMONUMENTATION
19 JUL 95 2:03 P.M. RECEIPT# 71A
PAID RECORDED - OAKLAND COUNTY
LYNN D. ALLEN, CLERK/REGISTER OF DEEDS

For corners in

Oakland (county) Located In: Corner Code #
1. Public Land Survey T1N R8E H-13
2. Property Controlling in Section S T R
3. Miscellaneous Property in Sec. S T R

Compliance with ACT 345, P.A. 1990
APPROVED ON: 7-12-95 Tom S
OAKLAND COUNTY REMONUMENTATION PEER GROUP COMMITTEE

Register of Deeds Stamp & File Number

4. Lot No. Recorded Plat

5. Private Claims

I, Joseph C. Kapelczak, in a field survey on February 23, 1995, do hereby certify that under requirements of P.A. 74, Michigan P.A. of 1970, the corner points mentioned in lines 1 and 2 above were in conformance with regulations and rules therefore as required in the current manual of survey instructions of the United States Department of the Interior, Bureau of Land Management or by a decree of a Court of Law and/or that the corner points mentioned in lines 3, 4 and 5 above were in conformance with the rules of the Michigan Board of Land Surveyors or by a Decree of a Court of Law; established, re-established, monumented, re-monumented, recovered, found as expressed below:

NOTE: Not more than 4 corners, all in the same town and range, may be recorded on this certificate.

A. Description of original monument and accessories and/or subsequent restoration:

Post set 1815 G.O.L. survey by Alexander Holmes on Michigan baseline
N 56 E 26lks, 18" Linden
S 10 W 15lks 6" Ash

No LCRC's recorded

B. Description of corner evidence found and/or method applied in restoring or reestablishing corner:

Recovered 1/4" rerod in concrete monument in monument box 10' north of Baseline Rd on centerline of Sheldon Rd.
Recovered witnesses:
N 61 E 30.59' 3/4" pipe southwest corner parcel #22-34-455-018
S 33 E 40.81' 1" pipe in concrete monument

C. Description of monument for corner and accessories established to perpetuate locating the position of the corner:

Set 5/8" rerod with O.C. Remonumentation brass cap replacing 1/4" rerod & monument
N 54 E 44.67' PK/remon tag northwest side 10" dia. Aspen
S 57 E 64.44' PK/remon tag north side 20" dia. Maple
S 17 E 48.46' PK/remon tag northeast side telephone guy pole
S 34 W 42.73' Chiseled cross on northwest bolt of light pole base

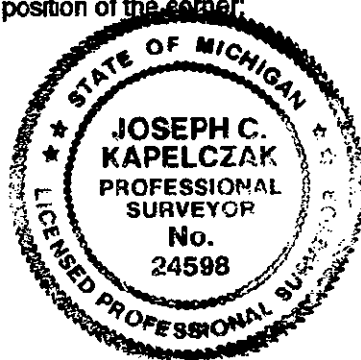

Signed by Joseph C. Kapelczak
Surveyor's Michigan License No. 24598

Date 6/28/95

7.00
2.00

Grid table with columns A-L and rows 2-13. A dot is present in cell G12.