

COPY

LIBER 16850 PG 428

DEC 19 96 306320

LAND CORNER RECORDATION CERTIFICATE
Filing Requirement of Act 74, Mich. P.A. 1970

For corners in

<u>Oakland</u> (county)	Located in:	Corner Code #
1. Public Land Survey	T1N R8E	J-1
	T R	
	T R	
	T R	
2. Property Controlling in Section	S T R	
	S T R	
3. Miscellaneous Property in Sec.	S T R	
	S T R	

\$ 7.00 MISCELLANEOUS RECORDING
 \$ 2.00 REMONUMENTATION
 19 DEC 96 11:03 A.M. RECEIPT# 178
 PAID RECORDED - OAKLAND COUNTY
 LYNN D. ALLEN, CLERK/REGISTER OF DEEDS

Approved by: 10-2-96
 OAKLAND COUNTY REGISTER OF DEEDS
 FILE GROUP COMMITTEE

Register of Deeds Stamp & File Number

4. Lot No. _____, Recorded Plat _____

5. Private Claims _____

I, Joseph C. Kapelczak, in a field survey on 29 January, 1996, do hereby certify that under requirements of P.A. 74, Michigan P.A. of 1970, the corner points mentioned in lines 1 and 2 above were in conformance with regulations and rules therefore as required in the current manual of survey instructions of the United States Department of the Interior, Bureau of Land Management or by a decree of a Court of Law and/or that the corner points mentioned in lines 3, 4 and 5 above were in conformance with the rules of the Michigan Board of Land Surveyors or by a Decree of a Court of Law; established, re-established, monumented, re-monumented, recovered, found as expressed below:

NOTE: Not more than 4 corners, all in the same town and range, may be recorded on this certificate.

A. Description of original monument and accessories and/or subsequent restoration:

Post set in 1816 G.L.O. survey. No witness.
 LCRC L.8335 P.574, Kapelczak 1982
 N 30 W 66.32' set concrete nail in southwest side 4" Crabapple
 S 50 W 106.44' set PK nail in northwest side 4" Ash
 S 49.03' set PK nail in west side M.B.T. pole
 N 70 E 87.09' set PK nail southeast side power pole w/transformer & U.G.

B. Description of corner evidence found and/or method applied in restoring or reestablishing corner:

Recovered 5/8" rerod in monument box on centerline 14 Mile Rd.
 Recovered witnesses:
 N 71 E 87.09' PK nail southeast side power pole
 N 71 E 87.07' nail southeast side power pole
 S 40 E 66.52' nail w/washer north side power pole
 S 05 W 48.92' PK nail in west side M.B.T. pole
 N 71 W 104.11 PK nail w/tag south side power pole w/light
 S 85 E 263.27' 5/8" rerod in monument box #17632
 S 88 W 538.84' 3/4" pinched iron northeast corner parcel #22-02-126-010

C. Description of monument for corner and accessories established to perpetuate locating the position of the corner:

Set Remonumentation brass cap.
 N 71 E 87.00' set nail w/remon tag southeast side power pole
 N 71 E 98.39' set nail w/remon tag northwest side 12" Ash
 S 39 E 66.58' set nail w/remon tag southwest side power pole
 N 71 W 140.09' set nail w/remon tag south side power pole w/light

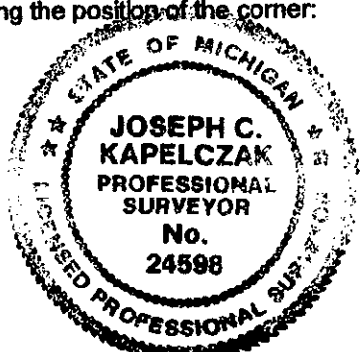

Signed by Joseph C. Kapelczak
 Surveyor's Michigan License No. 24598

Date 10/1/96

A	B	C	D	E	F	G	H	I	J	K	L
2	6	5	4	3	2	1					
3											
4	7	8	9	10	11	12					
5											
6	13	17	16	15	14	13					
7											
8	19	20	21	22	23	24					
9											
10	30	29	28	27	26	25					
11											
12	31	32	33	34	35	36					
13											

700
200