

LAND CORNER RECORDATION CERTIFICATE
Filing Requirement of Act 74, Mich. P.A. 1970

For corners in

Table with columns: Oakland (county), Located in:, Corner Code #. Rows include Public Land Survey, Property Controlling in Section, and Miscellaneous Property in Sec.

\$ 7.00 MISCELLANEOUS RECORDING
\$ 2.00 REMONUMENTATION
19 DEC 96 11:04 A.M. RECEIPT# 17B
PAID RECORDED - OAKLAND COUNTY
LYNN D. ALLEN, CLERK/REGISTER OF DEEDS

Compliance with ACT 340, P.A. 1990
APPROVED ON 11-6-96
Register of Deeds Stamp & File Number

4. Lot No. , Recorded Plat
5. Private Claims

I, Joseph C. Kapelczak, in a field survey on 29 January, 1996, do hereby certify that under requirements of P.A. 74, Michigan P.A. of 1970, the corner points mentioned in lines 1 and 2 above were in conformance with regulations and rules therefore as required in the current manual of survey instructions of the United States Department of the Interior, Bureau of Land Management or by a decree of a Court of Law and/or that the corner points mentioned in lines 3, 4 and 5 above were in conformance with the rules of the Michigan Board of Land Surveyors or by a Decree of a Court of Law; established, re-established, monumented, re-monumented, recovered, found as expressed below:

NOTE: Not more than 4 corners, all in the same town and range, may be recorded on this certificate.

A. Description of original monument and accessories and/or subsequent restoration:

Post set in 1816 G.L.O. Survey. S 7-1/2" 40 lks 5" Black Oak, N 39 W 54 lks 36" Black Oak
L.C.R.C. Campbell 1973 L.6174 P.351 (1/2" rerod)
W N W 9.22' nail and washer north side 8" Hickory
N 19.01' nail and washer west side 18" White Oak
E 30.90' nail and washer north side 14" Red Oak
S S E 17.32' nail and washer northeast side 12" White Oak
S 32.92' nail and washer west side 20" Red Oak

L.C.R.C. Schultz 1990 L.11679 P.308 (1/2" rerod)
S 80 W 40.26' nail w/MDOT tag northerly side power
N 65 W 9.17' nail w/MDOT tag in 9" Hickory
N 80 E 53.05' PK nail in 15" Oak
N 18.68' PK nail in 24" Oak
N 3177.58' 3/8" iron in monument box
E 2769.38' 3/8" iron

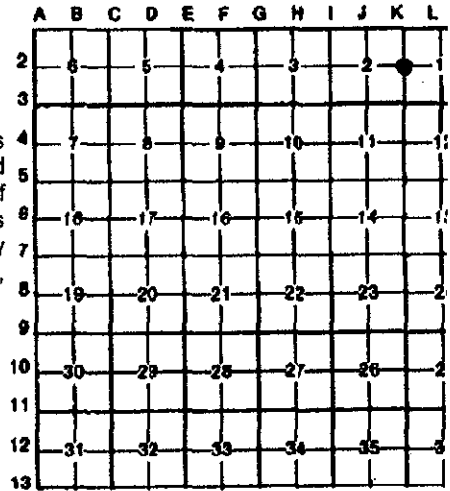

B. Description of corner evidence found and/or method applied in restoring or reestablishing corner:

Recovered 1/2" rerod no monument box.

Recovered witnesses

N 10 E 18.68' nail south side 24" Oak
N 60 W 9.16' nail w/MDOT tag east side 8" Oak
S 80 W 40.43' PK nail east side power pole
S 80 W 40.25' nail w/MDOT tag east side power pole

SURVEY & REMONUMENTATION

MAY 22 1997

COMMISSION

C. Description of monument for corner and accessories established to perpetuate locating the position of the corner:

Set Remonumentation Brass Cap with concrete monument.

N 05 E 18.43' set nail w/remon tag north side 24" Oak
N 60 W 9.15' set nail w/remon tag east side 8" Oak
S 80 W 40.18' set nail w/remon tag east side power pole
N 18 W 21.38' set nail w/remon tag north side 12" Oak

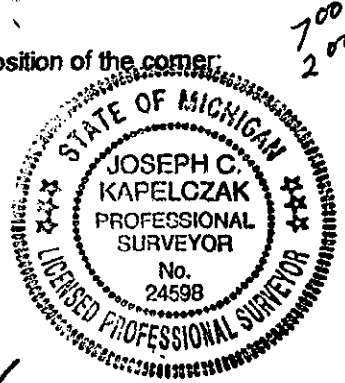

Signed by Joseph C. Kapelczak
Surveyor's Michigan License No. 24598

Date 11/04/96