

**SURVEY & REMONUMENTATION**

MAR 04 1998

LIBER 17277 PG 713

JN -9 971 24489

**LAND CORNER RECORDATION CERTIFICATE**  
Filing Requirement of Act 74, Mich. P.A. 1970

For corners in **SECTION**

<u>Oakland</u> (County)	Located in: Farmington Township	Corner Code # <u>M-3</u>
1. Public Land Survey	T <u>1N</u> R <u>9E</u>	<u>M-3</u>
	T _____ R _____	_____
	T _____ R _____	_____
2. Property Controlling in Section	S _____ T _____ R _____	_____
	S _____ T _____ R _____	_____
3. Miscellaneous Property in Sec.	S _____ T _____ R _____	_____
	S _____ T _____ R _____	_____

Compliance with  
ACT 345, P.A. 1990

APPROVED ON: 4-16-97 RS  
OAKLAND COUNTY REMONUMENTATION  
PEER GROUP COMMITTEE

**\$ 7.00 MISCELLANEOUS RECORDING**  
**\$ 2.00 REMONUMENTATION**  
9 JUN 97 12:24 P.M. RECEIPT# 94A  
PAID RECORDED - OAKLAND COUNTY  
REGISTERED DEEDS CLERK/REGISTERED DEEDS

4. Lot No. \_\_\_\_\_, Recorded Plat \_\_\_\_\_  
5. Private Claims \_\_\_\_\_

I, Randy Kolehouse, in a field survey on April 7 19 97, do hereby certify that under requirements of P.A. 74 Michigan P.A. of 1970, the corner points mentioned in lines 1 and 2 above were in conformance with regulations and rules therefore as required in the current manual of survey instructions of the United States Department of the interior, Bureau of Land Management or by a decree of a Court of Law and/or that the corner points mentioned in lines 3, 4 and 5 above were in conformance with the rules of the Michigan Board of Land Surveyors or by a Decree of a Court of Law; established, re-established, monumented, re-monumented, recovered, found as expressed below:

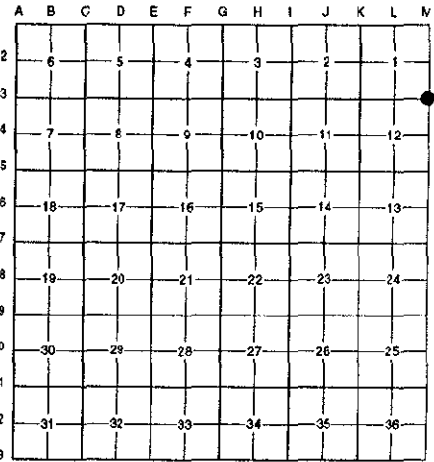

**NOTE: Not more than 4 corners, all in the same town and range, may be recorded on this certificate.**

**A. Description of original monument and accessories and/or subsequent restoration:**

M-3	1817	Wampler	G.L.O. Notes	Set Post
	1943	McAlpine	Supervisor's Plat of Wood Creek Farms L. 55 P. 34	N/A
	1995	Dunn	L.C.R.C. L. 16832 P. 179 (L-3)	Set PK Nail in Asphalt Road
	N/A	N/A	O.C. Tax Maps	N/A

Records indicate this corner is not common with A-3, T1N, R10E.

**B. Description of corner evidence found and/or method applied in restoring or reestablishing corner:**

M-3 Found a 60d nail set in concrete in an existing monument box at the C/L intersection of Inkster Road (bit.) running North and South and Thirteen Mile Road (bit.) running East and West. Found very little information on record for this corner. Point found checks well with Supervisor's Plat of Wood Creek Farms (1943). Also checks closely with measurement to L-3 as shown in L.C.R.C. L. 16832 P. 179 (1995) recorded by Martin Dunn.

Measure North 2668.7' to M-2 (G.L.O. = 2640.0')  
Measure South 2689.39' to M-4 (G.L.O. = 2640.0') (Supervisor's Plat Wood Creek Farms = 2689.42')  
Measure West 2641.42' to L-3 (G.L.O. = 2640.0') (Supervisor's Plat Wood Creek Farms = 2642.4' (Calc.)  
(M. Dunn (1995) = 2541.53')

7.00 FILE  
2.00 ✓

**C. Description of monument for corner and accessories established to perpetuate locating the position of the corner:**

M-3 Replaced 60d nail with a 5/8" x 24" rebar with brass cap stamped "Oakland County Remonumentation P.S. #25854" in an existing monument box.

- PK Nail & Tag Stamped "Oakland Co. Remonumentation P.S. #25854" in S'y Side Signal Pole N 47° E 80.29'
- PK Nail & Tag Stamped "Oakland Co. Remonumentation P.S. #25854" in NW Side Util. Pole S 45° W 48.97'
- PK Nail & Tag Stamped "Oakland Co. Remonumentation P.S. #25854" in S'y Side MBT Pole N 26° W 65.9'
- "+" NW Rim MBT M.H. S 55° E 61.06'

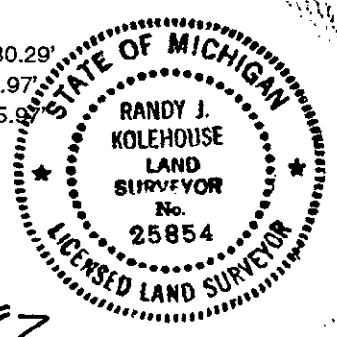

The selected location is accepted by the Contractor and is generally accepted by professional surveyors as the best available evidence of the position of the original corner.

Signed by Randy J. Kolehouse Date 5/20/97  
EARTHTECH

Surveyor's Michigan License No. 25854