

LIBER 21028 521  
*W. Ward*

25874

**LAND CORNER RECORDATION CERTIFICATE**  
 Filing Requirement of Act 74, Mich. P.A. 1970

LIBER 21028 PAGE 521  
 \$9.00 MISC RECORDING  
 \$2.00 REMONUMENTATION  
 01/27/2000 08:21:22 A.M. RECEIPT# 6&E  
 PAID RECORDED - OAKLAND COUNTY  
 G. WILLIAM CADDELL, CLERK/REGISTER OF

For corners in  
Oakland Located In: Corner Code #  
 (County)

1. Public Land Survey T 2N R 7E E-8  
 T R  
 T R  
 T R  
 2. Property Controlling S T R SURVEY &  
 in Section S T R REMONUMENTATION  
 3. Miscellaneous S T R  
 Property in Sec. S T R MAR 21 2000

Compliance with  
 ACT 345, P.A. 1990  
 APPROVED ON: 8-18-99 JR  
 OAKLAND COUNTY REMONUMENTATION  
 PEER GROUP COMMITTEE  
 Register of Deeds Stamp & File Number

4. Lot No. \_\_\_\_\_, Recorded Plat \_\_\_\_\_  
 5. Private Claims \_\_\_\_\_

**SECTION**

	A	B	C	D	E	F	G	H	I	J	K	L
1												
2	6		5		4		3		2			
3												
4	7		8		9		10		11			1
5												
6	18		17		16		15		14			1
7												
8	19		20		21		22		23			2
9												
10	30		29		28		27		26			2
11												
12	31		32		33		34		35			3
13												

I, Grant J. Ward, R.L.S., in a field survey on August 12 1999 do hereby state that under requirements of P.A. 74, Michigan P.A. of 1970, the corner points mentioned in lines 1 and 2 above were in conformance with regulations and rules therefore as required in the current manual of survey instructions of the United States Department of the Interior, Bureau of Land Management or by a decree of a Court of Law and for that the corner points mentioned in lines 3, 4 and 5 above were in conformance with the rules of the Michigan Board of Land Surveyors or by a Decree of a Court of Law, established, re-established, monumented, recovered, found as expressed below:

NOTE: Not more than 2 corners, all in the same town and range, may be recorded on this certificate.

A. Description of original monument and accessories and/or subsequent restoration:  
 E-8 Post, per G.L.O. Notes.

B. Description of corner evidence found and/or method applied in restoring or reestablishing corner:  
 E-8 West 1/4 Corner of Section 21, T. 2 N., R. 7 E. Found 1/2" Iron Rod.

Previously Recorded in L. 6301, P. 613 (4) and L. 7300, P. 643 (3) of Oakland County Records.

(n) Indicates the number of references that confirms this corner by dimensional tie.

This corner location is accepted by the Contractor and is generally accepted by Professional Surveyors as the best available evidence of the position of the original corner.

C. Description of monument for corner and accessories established to perpetuate locating the position of the corner:

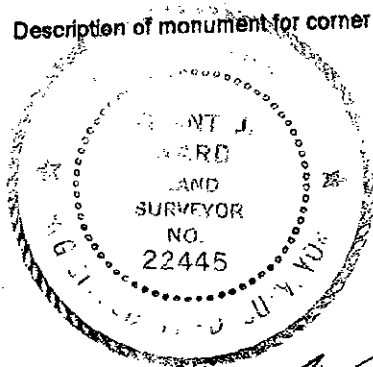

- E-8 Set 5/8" Rod and Remonumentation Cap.
- N 75° E 63.20' Set MAG Nail & Remonumentation Disc in South face of 14" Maple.
- S 65° E 62.43' Set MAG Nail & Remonumentation Disc in North face of 8" Maple.
- S 50° E 35.16' Set MAG Nail & Remonumentation Disc in Northeast face of 34" Oak.
- S 30° W 28.30' Set MAG Nail & Remonumentation Disc in Northwest face of 32" Black Walnut.
- South 15.08' Found 3/4" Iron Rod.

Signed by *Grant J. Ward*  
 Surveyor's Michigan License No. 22445

Date August 17, 1999

AUGUST 14, 1999

Corner Code: E-8

DOSSIER FOR: THE WEST 1/4 CORNER OF SECTION 21, MILFORD TOWNSHIP, T 2 N, R 7 E, OAKLAND COUNTY, MICHIGAN. Prepared under contract with the County of Oakland Under Act 345 of the Public Acts of 1990.

**HISTORY:**

This Corner has been accepted and used since before 1974, as evidenced by recordings under Act 74 of the Public Acts of 1970 by Gary R. Stonerock, Surveyor and recorded in Liber 6301, Page 613.

**COLLATERAL EVIDENCE:**

We set a 5/8" iron rod and remonumentation disc in place of a 1/2" iron rod. This Corner lies 23 feet West and 6 feet North of the intersection of Garner and Pearson Roads. We found a 3/4" iron rod S 15° E 15.08 feet from the Corner, which is probably someone's traverse point, since no evidence supports it for the Corner. We measured 0.01 feet and 0.07 feet longer than the recorded distances to the Northeast and the Southeast Corners of Section 19. We searched at least 50 feet in each direction for other stakes and found none that might represent the Corner.

**SURVEYOR'S RECOMMENDATIONS:**

This corner location is accepted by the Contractor and is generally accepted by Professional Surveyors as the best available evidence of the position of the original Corner. Therefore, I recommend that the Peer Review Group accept this Corner as monumented, with the references as shown on the enclosed form prepared according to Act 74 of the Public Acts of 1970.

---

Grant J. Ward, R.L.S.  
License No. 22445

SURVEY &  
REMONUMENTATION

MAR 21 2000

SECTION